

CTT1 CTT2 Built-In Thermostat Kit Installation Instructions

<http://www.cadetheat.com/products/wall-heaters/com-pak>

Benefits You Can Depend On

- Built-in temperature control for your Cadet Com-Pak or Com-Pak Twin heater
- Easy to use adjustable dial
- Available in white or almond color to match your heater
- Use with Cadet CS, C, CST and CT 120-, 208-, or 240-volt models
- Available in single pole (2 wires) or double pole (4 wires), and tamper-proof
- 22 Amp
- Your CTT built-in thermostat is guaranteed with a **limited 1 year warranty**

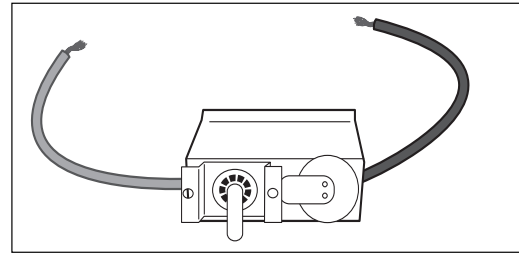

Single Pole Thermostat Models:
CTT1W
CTT1A
CTTP (tamper-proof model)

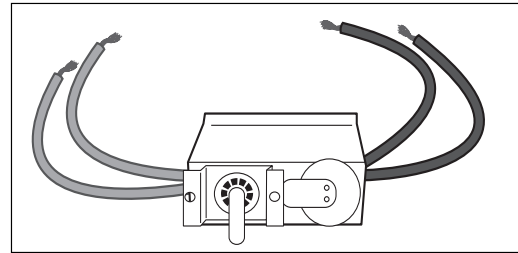

Double Pole Thermostat Models:
CTT2W
CTT2A
CTT2P (tamper-proof model)

**TOOLS
REQUIRED:**

- Phillips Screwdriver
- Wire Connectors

IMPORTANT

When using electrical appliances, basic precautions should always be followed to reduce the risk of fire, electric shock, and injury to persons, including the following:

1. Read all instructions before installing or using this thermostat.
2. High temperatures may be generated under certain abnormal conditions. Do not partially or fully cover or obstruct the front of this heater.
3. Do not operate any heater after it malfunctions. Disconnect power at service panel and have heater inspected by a qualified electrician before reusing.
4. To disconnect heater, turn controls to off or low, and turn off power to heater circuit at main disconnect panel.
5. Do not insert or allow foreign objects to enter any ventilation or exhaust opening as this may cause an electric shock or fire, or damage the heater.
6. To prevent a possible fire, do not block air intakes or exhaust in any manner.
7. A heater has hot and arcing or sparking parts inside. Do not use it in areas where gasoline, paint, or flammable vapors or liquids are used or stored.
8. Do not use outdoors.

SAVE THESE INSTRUCTIONS

INSTALLATION INSTRUCTIONS

STEP 1

Turn the electrical power off at the circuit breaker or fuse box. Use approved, insulated wire connectors for all connections.

STEP 2

If heater is installed, remove grill and heater assembly.

STEP 3

Fasten thermostat behind bottom flange, to lower left corner of heater assembly cover (when viewed from the front), with two #6-32 x 1/4 inch screws. The longer part of the thermostat body must point to the right. Shaft should come through the largest hole. Do not over-tighten as slight adjustment might be necessary when the grill is installed. Positioning the switch correctly is required to fit the heater into the wall can.

STEP 4

A. Double pole thermostats (T2)*

Connect one black lead wire from the thermostat to one lead from the heater. Connect the other black thermostat

lead wire to the other lead from the heater. Connect one red lead wire from the thermostat to one of the power supply lines. Connect the other red thermostat lead wire to the other supply line.

B. Single pole thermostats (T1)**

Connect the black lead from the thermostat to one lead from the heater. Connect the red thermostat lead to one supply line. Connect the other lead from the heater to the other supply line.

STEP 5

After the heater assembly is placed back in the can and the grill is screwed back on, check thermostat shaft alignment with the center of the grill hole. Adjust position of the thermostat on the heater assembly cover if necessary. Push knob on shaft securely.

*Double pole thermostat is not necessary on 120 volt service.

**Single pole thermostats may be used with 120 volts or 240 volts.

CS & CST models manufactured 08/2009 to present

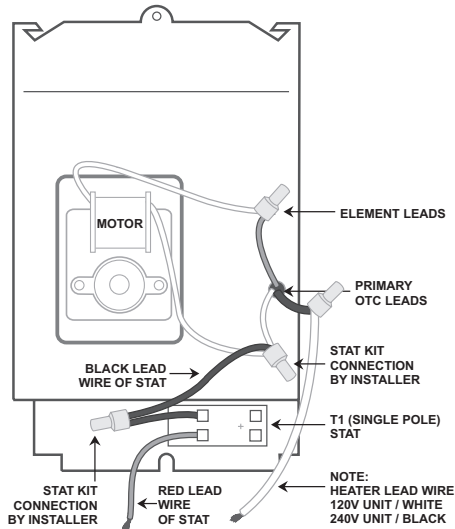

CS Model Single Pole Thermostat (T1)

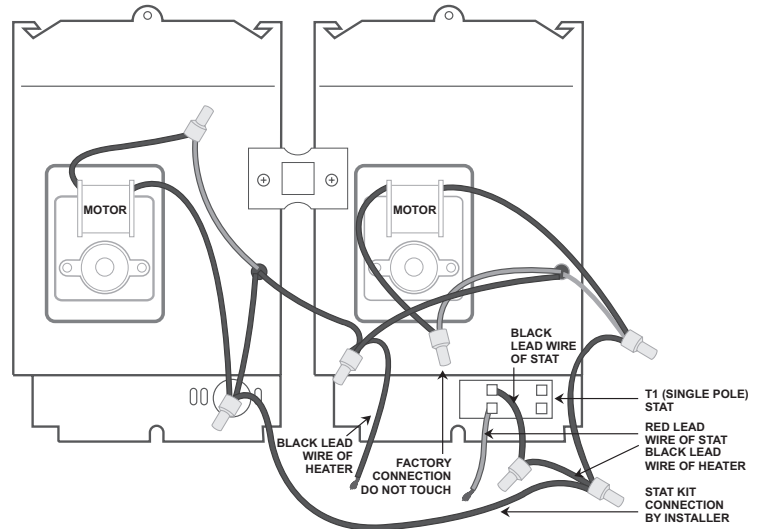

CST Model Single Pole Thermostat (T1)

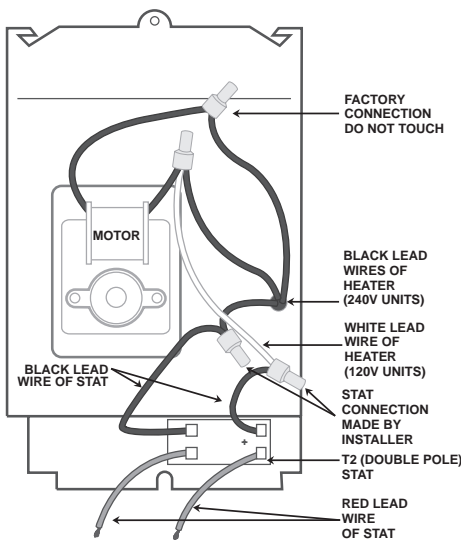

CS Model Double Pole Thermostat (T2)

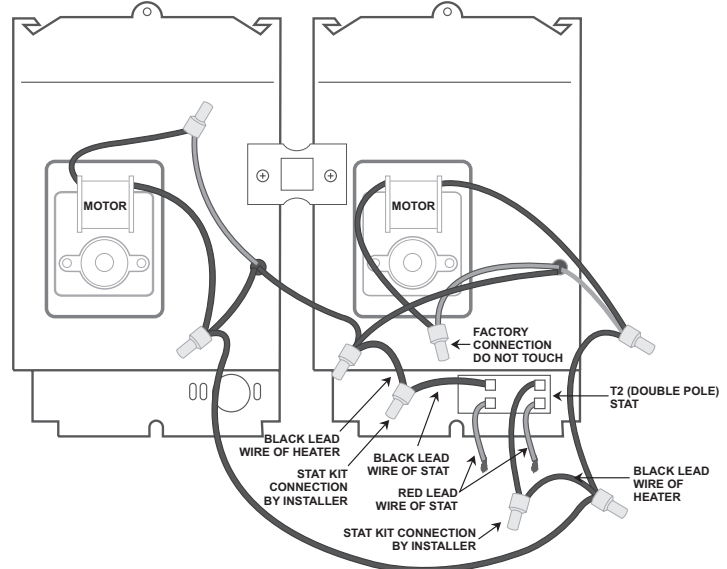

CST Model Double Pole Thermostat (T2)

INSTALLATION INSTRUCTIONS

C & CT lead models manufactured 08/1999 to 08/2009

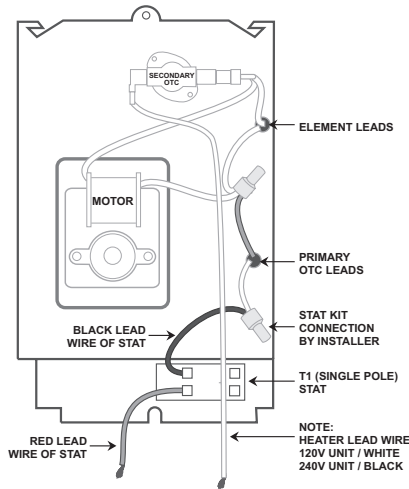

C Model Single Pole Thermostat (T1)

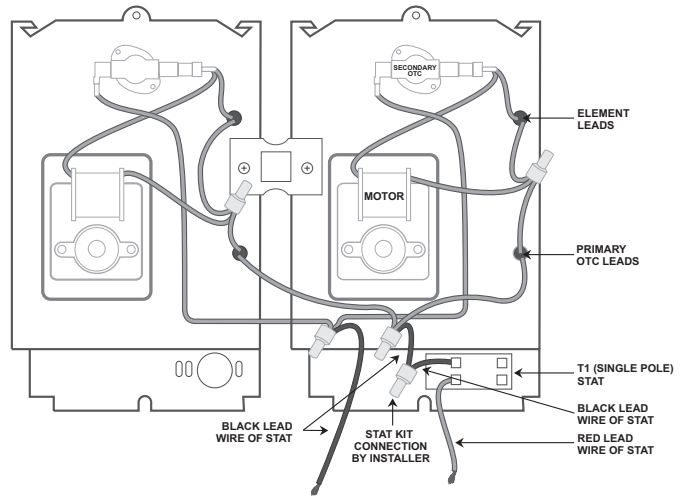

CT Model Single Pole Thermostat (T1)

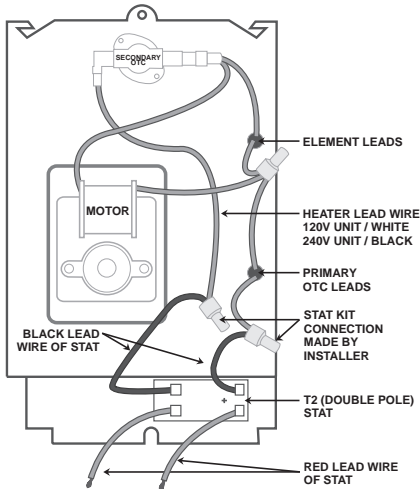

C Model Double Pole Thermostat (T2)

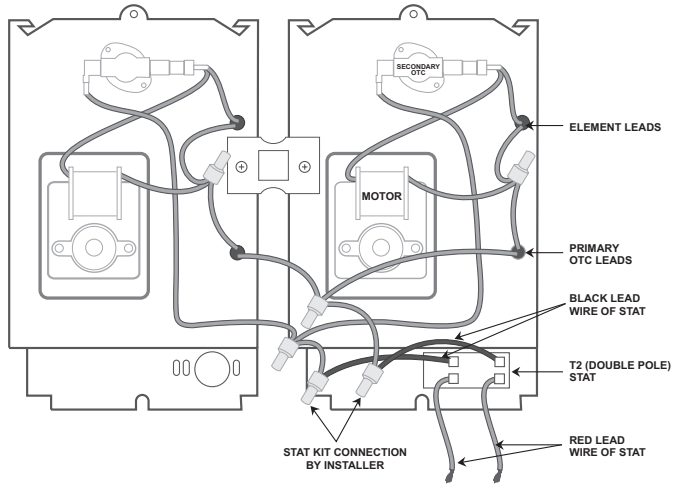

CT Model Double Pole Thermostat (T2)

Warranty

For more effective and safer operation and to prolong the life of the heater, read the Owner's Guide and follow the maintenance instructions. Failure to properly maintain the heater will void any warranty and may cause the heater to function improperly. Warranties are non transferable and apply to original consumer only. Warranty terms are set out below.

LIMITED ONE-YEAR WARRANTY: Cadet will repair or replace any CTT1, CTT2, CTT2P, or CTT2P thermostat found to be defective within one year after the date of purchase.

These warranties do not apply:

1. Damage occurs to the product through improper installation or incorrect supply voltage;
2. Damage occurs to the product through improper maintenance, misuse, abuse, accident, or alteration;
3. The product is serviced by anyone other than Cadet;
4. If the date of manufacture of the product cannot be determined;
5. If the product is damaged during shipping through no fault of Cadet.
6. The use of unauthorized accessories or unauthorized components constitutes an alteration and voids all warranties. Refer to Cadet website or call customer service at 855.CADET.US for list of authorized accessories and components.
7. CADET'S WARRANTY IS LIMITED TO REPAIR OR REPLACEMENT AS SET OUT HEREIN. CADET SHALL NOT BE LIABLE FOR DAMAGES SUCH AS PROPERTY DAMAGE OR FOR CONSEQUENTIAL DAMAGES AND/OR INCIDENTAL EXPENSES RESULTING FROM BREACH OF THESE WRITTEN WARRANTIES OR ANY EXPRESS OR IMPLIED WARRANTY.

8. IN THE EVENT CADET ELECTS TO REPLACE ANY PART OF YOUR CADET PRODUCT, THE REPLACEMENT PARTS ARE SUBJECT TO THE SAME WARRANTIES AS THE PRODUCT. THE INSTALLATION OF REPLACEMENT PARTS DOES NOT MODIFY OR EXTEND THE UNDERLYING WARRANTIES. REPLACEMENT OR REPAIR OF ANY CADET PRODUCT OR PART DOES NOT CREATE ANY NEW WARRANTIES.

9. These warranties give you specific legal rights, and you may also have other rights which vary from state to state. Cadet neither assumes, nor authorizes anyone to assume for it, any other obligation or liability in connection with its products other than as set out herein.

If you believe your Cadet product is defective, please contact Cadet Manufacturing Co. at 855.CADET.US, during the warranty period, for instructions on how to have the repair or replacement processed. Warranty claims made after the warranty period has expired will be denied. Products returned without authorization will be refused.

Parts and Service

Visit cadetheat.com/support/parts-service for information on where to obtain parts and service.



Reduce-Reuse-Recycle

This product is made primarily of recyclable materials. You can reduce your carbon footprint by recycling this product at the end of its useful life. Contact your local recycling support center for further recycling instructions.