

BITBUDDIE™ DUST SHROUD

Air pressure from the vacuum holds the BitBuddie in place. No need for brackets or other connections.

Dustless
THE END OF CLEANUP

INSTALLING THE 1 3/8" BITBUDDIE

Use for cutting faucet holes in stone countertops with a diamond core bit, or when drilling up to 1-3/8" holes with a hand drill or percussion hammer. Use for wet or dry drilling to capture dust and/or slurry.



1-3/8" BitBuddie
Model D1900

- 1 Attach vacuum hose to BitBuddie.



- 2 Turn-on vacuum and allow air flow to secure the BitBuddie to the drilling surface.



- 3 Proceed with drilling, allowing BitBuddie to capture dust and/or slurry.



INSTALLING THE 4" or 8" BITBUDDIE

Use for cutting concrete or stone with a diamond core bit. Use for wet or dry drilling to capture dust and/or slurry.

The 4" BitBuddie can also be used for cutting drywall. See next page.



- 1 Attach vacuum hose to BitBuddie.



- 2 Turn-on vacuum and allow air flow to secure the BitBuddie to the drilling surface.



- 3 Proceed with drilling, allowing BitBuddie to capture dust and/or slurry.



800.568.3949
dustlesstools.com

REV0215

MANUFACTURED BY
Dustless
TECHNOLOGIES

BITBUDDIE™

DUST SHROUD

Dustless®
THE END OF CLEANUP

DRYWALL CUTTING WITH THE 4" BITBUDDIE – Use a box knife to cut a slot, rectangle or circle in the face of the BitBuddie, depending on what type of cutting you need to do. See diagrams below.

Slot Cut for vent holes

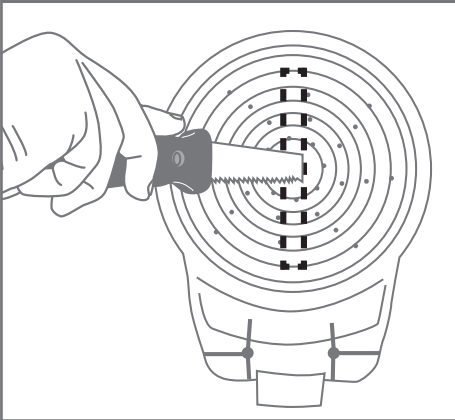

Rectangle cut for electric outlet holes

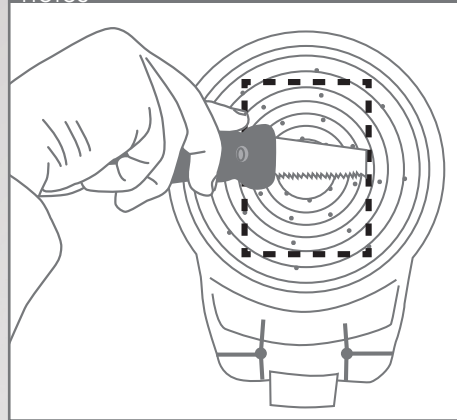

Circle cut for light fixture holes

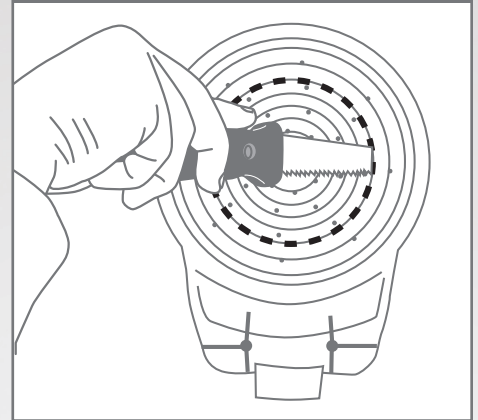

- 1 Attach vacuum hose to BitBuddie.
- 2 Turn-on vacuum and allow air flow to secure the BitBuddie to the drywall.
- 3 Proceed cutting with a hand-held drywall saw. When using a slot-cut BitBuddie for larger vent holes, you will find it easy to simply slide the BitBuddie across the surface to reposition it as you cut.



800.568.3949
dustlesstools.com

MANUFACTURED BY
Dustless®
TECHNOLOGIES