



## Model : TGM-5R

ELECTRICAL DATA	
Voltage	115/60/1
Plug Type	Ⓜ NEMA 5-15P
Full Load Amperes	2.2
Compressor HP	1/10
Cord Length (ft.)	9
Refrigerant	R-134A
DIMENSIONAL DATA	
# of Doors	1
Net Capacity (cu. ft.)	5
Ext. Length Overall (in.)	18 <sup>7</sup> / <sub>8</sub> (480mm)
Ext. Depth Overall (in.)*	20 <sup>3</sup> / <sub>4</sub> (526mm)
Ext. Height Overall (in.)	34 <sup>1</sup> / <sub>8</sub> (867mm)
Int. Length Overall (in.)	16 <sup>1</sup> / <sub>4</sub> (413mm)
Int. Depth Overall (in.)	17 (432mm)
Int. Height Overall (in.)	29 <sup>1</sup> / <sub>4</sub> (743mm)
Net Weight lbs.	75
Gross Weight lbs.	82
# of Shelves	3
Shelf Size (L x D) (in.)	16 <sup>1</sup> / <sub>8</sub> x 14 <sup>1</sup> / <sub>4</sub> , 16 <sup>1</sup> / <sub>8</sub> x 15 <sup>3</sup> / <sub>4</sub> , 16 <sup>1</sup> / <sub>8</sub> x 9

Design and specifications subject to change without notice.

Actual shipping weight may differ due to extra packing materials for product protection.

\* Depth does not include 1" for door handle and 2" for rear condenser.

- **WARRANTY : 2 Year Parts and Labor Warranty  
Additional 3 Year Warranty on Compressor**
- **White color cabinet & black color frame on door**
- **Door locks standard**

## PLAN VIEW

(unit : inch)

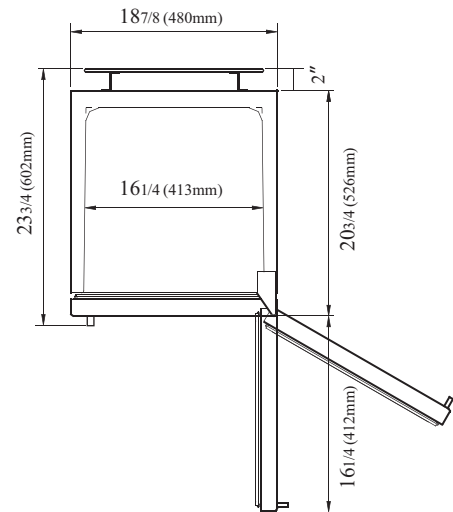

PLAN VIEW

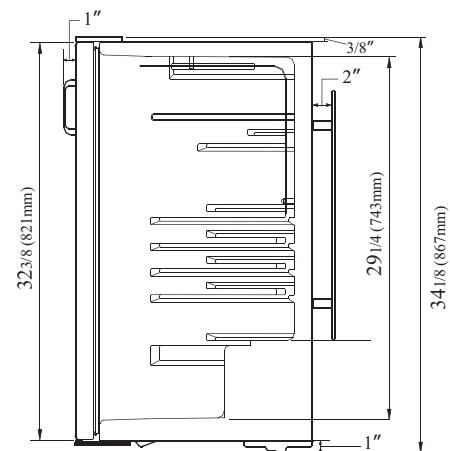

SIDE VIEW

Ver.201510

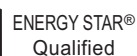

- Turbo Air : 800-627-0032
- GK : 800-500-3519
- Warranty : 800-381-7770
- AC : 888-900-1002

