

KWIB12043

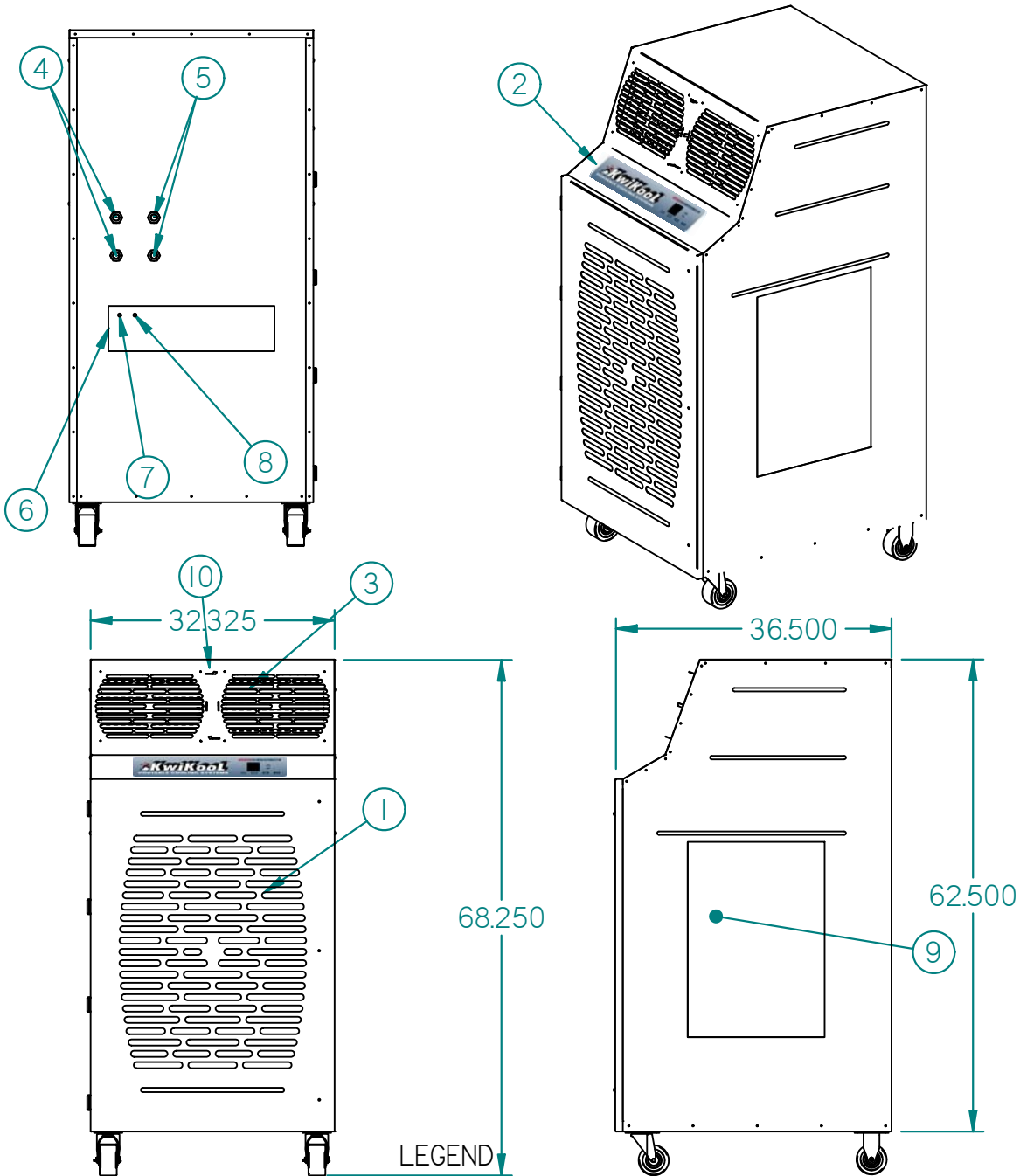

- 1 Cold Air Return
- 2 Control Pad
- 3 Cold Air Supply
- 4 Water Inlets - Two, 0.75" NPT
- 5 Water Outlets - Two, 0.75" NPT

- 6 Power Cord
- 7 Condensate Nipple
- 8 Condensate Alarm Jack
- 9 Access Door
- 10 Vent Control



SPECIFICATIONS

KWIB12043 - 10 Ton

COOLING CAPACITY		
	BTU/hr @ 95F at 60% RH	120,000 (10 Tons)
COMPRESSOR DATA		
	Compressor Type	Hermetic Recip./2 Stage
	Operating Temperatures	60-110 F 50%RH
	Refrigerant	407C
FAN DATA		
Evaporator		
	Fan Type (Centrifugal)	Belt Drive
	Air Flow (CFM)	1800/3800
	Supply Air Device	Adjustable Vent
	Supply Air Chute Kit (optional)	2 - 12" Dia. x 30" Length
	Supply Air Chute Max. Length	65'
Water Flow Data		
	Flow Regulation Valve - 2, 0.75NPT	Automatic
	Inlet Water 85F-95F Exit (GPM)	30
	Inlet Water 75F-95F Exit (GPM)	15
	Inlet Water 65F-95F Exit (GPM)	10
	Inlet Water 55F-95F Exit (GPM)	7.5
	2 Seperate Cooling Loops	2 Inlets & 2 Outlets
ELECTRICAL DATA		
	Power Supply (Volts)	460 - 3 Phase
	Current Consumption (Amps)	18.4
	Power Consumption (KW)	16.3
	Maximum Circuit Breaker (Amps)	30
	Minimum Circuit Ampacity(Amps)	22.9
	Min./Max. Voltage	420-500
	Power Cord Gauge/Length	10AWG/10'
	Plug Configuration	Field Supplied
DIMENSIONAL DATA		
	Width x Depth x Height (Inches)	32.325" x 36.5" x 68.25"
	Weight (Lbs.)	766
	Shipping Weight (Lbs.)	826
SAFETY DEVICE DATA		
	Compressor Overload	Internal
	Fan Motor Overload	Automatic Internal
	Evaporator Freeze Protection	Hot Gas Bypass
	High Pressure Switch	Manual
	Low Pressure Switch	Automatic
	Compressor Short Cycle	Yes
	Automatic Restart	Yes
	Thermostat Type	Microprocessor/Digital
	Condensate Pump Overflow	Yes
	Condensate Tank Overflow	Yes

1-800-KWIKOOL