

Installation Instructions
For
Securall Tornado Safe Rooms
and Tornado Shelters



Manufactured by
A & A Sheet Metal Products, Inc.
5122 N. State Road 39
La Porte, Indiana 46350
(888)326-7890
custserv@securallproducts.com

Caution!

Use proper personal protective equipment (safety glasses, etc.) while installing Securall Tornado Safe Rooms and Tornado Shelters.

Installation Instructions:

Supporting Structure:

The supporting structure shall be designed by others for wind forces of 1,935 pounds per linear foot of perimeter uplift and 410 pounds per linear foot of perimeter shear.

For maximum effectiveness in wind speeds up to 250 mph, the shelter must be installed onto a level concrete pad:

- Minimum pad thickness: 6".
- Minimum pad size: 24" in each direction beyond perimeter of shelter footprint.
- Pad must be constructed in accordance with local building codes.

****The concrete pad must be approved by the local authority having jurisdiction. ****



Securall Tornado Safe Rooms and Shelters are shipped on flatbed semi trucks. Offloading and placement may require special equipment, such as fork trucks. Please contact Equipment Riggers in your area.

1. Prepare supporting structure (concrete pad) by removing all debris.
2. Position the shelter on the pad exactly where it will be installed. Be sure that the door(s) have adequate space to open. Also be sure that there is clear access to the door(s).
3. Detach and remove the fork-lift channels and supports. These are for shipping and fork-lift mobility only.
4. With shelter in place, use a 5/8" diameter cement-boring drill bit to drill out the cement below each of the pre-punched anchor locations in the wall bottom channels. Make the holes a minimum 5" deep from the surface of the cement.
5. Follow anchor manufacturer's instructions for installing the anchors (see below). Begin by installing the anchors nearest all 4 corners.

INSTALLATION STEPS

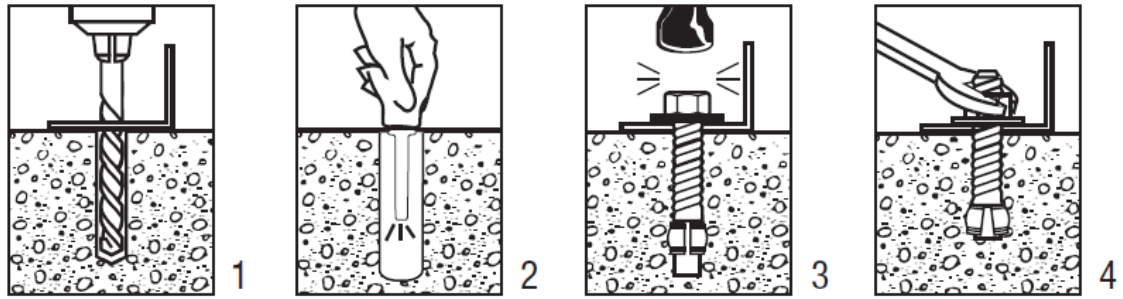

1. Select a carbide drill bit with a diameter equal to the anchor diameter. Drill hole to any depth exceeding the desired embedment. See chart for minimum recommended embedment.
2. Clean hole or continue drilling additional depth to accommodate drill fines.
3. Assemble washer and nut, leaving nut flush with end of anchor to protect threads. Drive anchor through material to be fastened until washer is flush to surface of material.
4. Expand anchor by tightening nut 3-5 turns past the hand tight position, or to the specified torque requirement.

NOTE: Read **Caution** on back page before installation.

WARNING!

 **Use in concrete ONLY.** Not recommended for use in lightweight masonry such as block or brick.

 Always wear safety glasses and other necessary protective devices or apparel when installing or working with anchors.

CAUTION:

Use of core drills is not recommended to drill holes for use with this anchor.

Not recommended for use in new concrete which has not had sufficient time to cure.

The use of carbide drill bits manufactured within ANSI B212.15 drill bit diameter requirements is recommended for installation of this anchor.

Anchor spacing and edge distance requirements (anchor installation locations) are the responsibility of the engineer of record.

ITW Red Head

© 1-800-899-7890
www.itwredhead.com
2171 Executive Drive
Suite 100
Addison, IL 60101

F833P-Rev. 08/09



**TRUBOLT WEDGE
ANCHOR**

•
**ANCLA DE CUÑA
TRUBOLT**

•
**ANCRAGE À BOULON
TRUBOLT**

Installation Instructions
Instrucciones de Instalación
Mode D'Installation

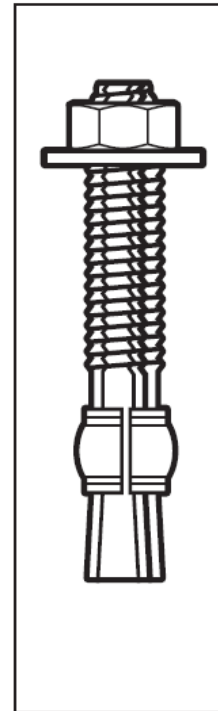

Anchor Model Number WS-5860

6. Tighten all bolts, beginning with those nearest each corner of the shelter.
7. Consider stocking your shelter with emergency supplies such as water, food, communications devices, lighting, blankets, first aid kits, etc.