

# EXTRUDED RUBBER BUMPER - M-2-12

APPROXIMATE WEIGHT IS: 0.69 lbs.

DURO METER READING OF 70 +/- 5  
 TENSIL: 1850 PSI  
 ELONGATION: 220%  
 TEAR STRENGTH: 229 LBS  
 IMPACT RESISTANCE: 75%

\*\*\* ANY ADDITIONS, DELETIONS, OR OMISSIONS  
 THIS DRAWING AS THIS DRAWING WILL BE CON

ALL GRAPHICS PROVIDED ARE FOR REFERENCE ONLY. IF CERTAIN  
 ARE CRITICAL PLEASE VERIFY THOSE DIMENSIONS WITH YOUR

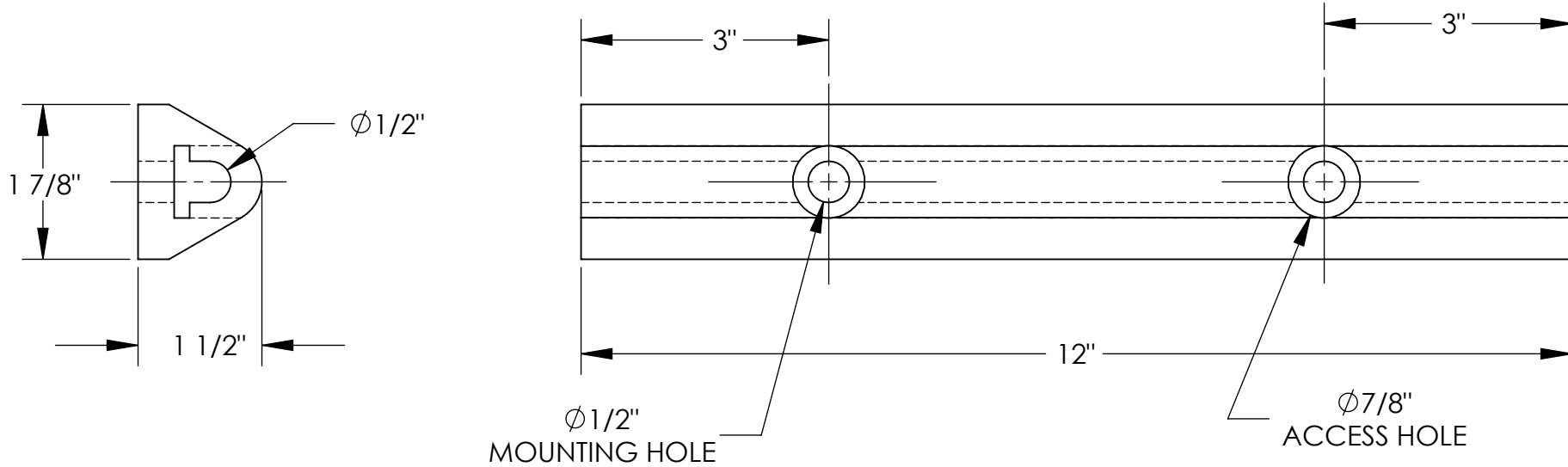

**ALL SPECIAL UNITS  
 ARE NON-RETURNABLE**

**A  
P  
P  
R  
O  
V  
A  
L**

I, the undersigned, hereby approve this print.  
 This includes my approval of design & dimensions

[ ] As drawn      [ ] As marked

Signed: \_\_\_\_\_ Date: \_\_\_\_\_

**LEAD TIME WILL START UPON RECEIPT  
 OF SIGNED APPROVAL DRAWING**

## STANDARD FEATURES

MODEL NUMBER IS: M-2-12  
 OVERALL WIDTH IS: 1 7/8"  
 OVERALL LENGTH IS: 12"  
 OVERALL PROJECTION IS: 1 1/2"  
 NUMBER OF MOUNTING HOLES: 2  
 MOUNTING HOLE SIZE: Ø1/2"  
 ACCESS HOLE SIZE: Ø7/8"

## SPECIAL FEATURES

NONE

DISTRIBUTOR'S NAME: <b>VESTIL MANUFACTURING</b>		P.O.# X
DRAWN BY: JDB	DATE: 8/7/08	W.O.# X
REFERENCE: X	QUOTE # X	SALES: X
		FILE NAME: 29-007-098
SCALE: 1:2		