

Assembly Instructions	Instrucciones de Ensamblaje	Directives d'assemblage
Customer Service US: 1-800-645-2986	Servicio de atención al Cliente México: 01.800.681.6940	Service à la clientèle Canada: 888-645-2986

## Pass Through Specimen Cabinet

Model 647108

CONTENTS		
Ref.	Qty.	Description
1	1	Cabinet
2	1	Frame
3	1	Spill Tray
H1	8	Plastic Anchor
H2	8	#6 x 1.5 Lg. Phillips Pan Head Wood Screw
H3	2	Door Knob
H4	2	Axle Flange Washer
H5	2	M4 x .7 x 7mm Lg. Phillips Pan Head Screw

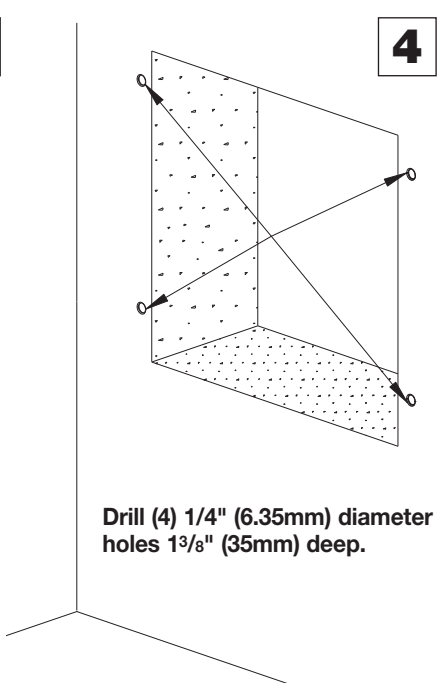
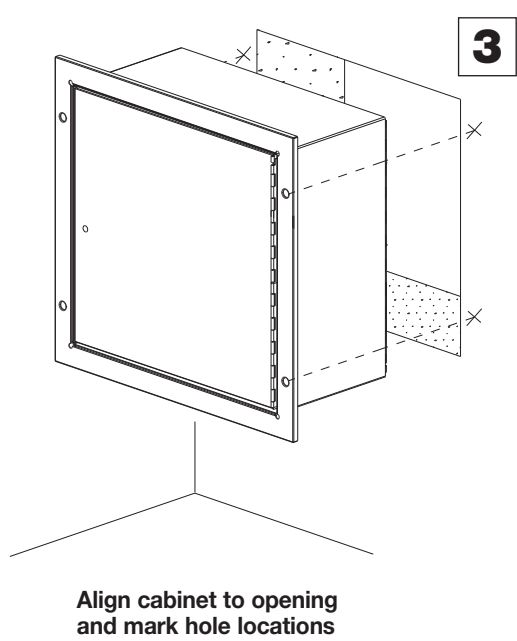
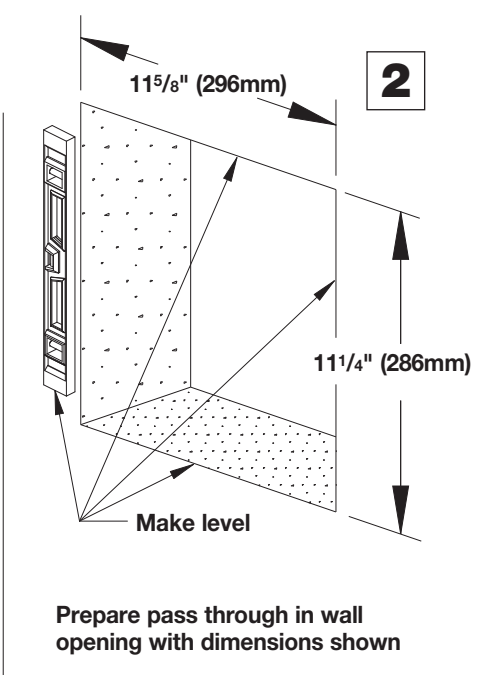
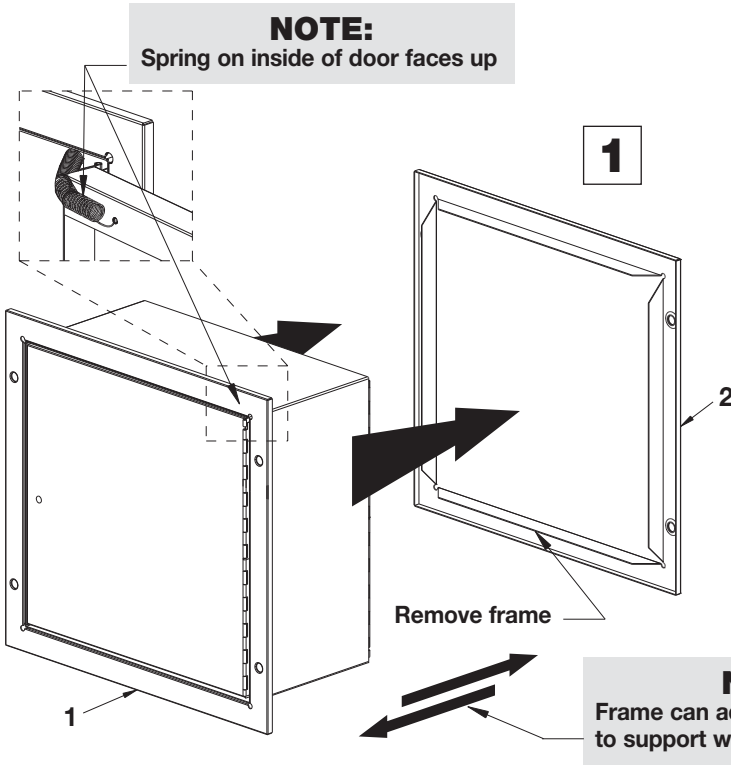

# Pass Through Specimen Cabinet

5

Insert plastic anchors flush to wall

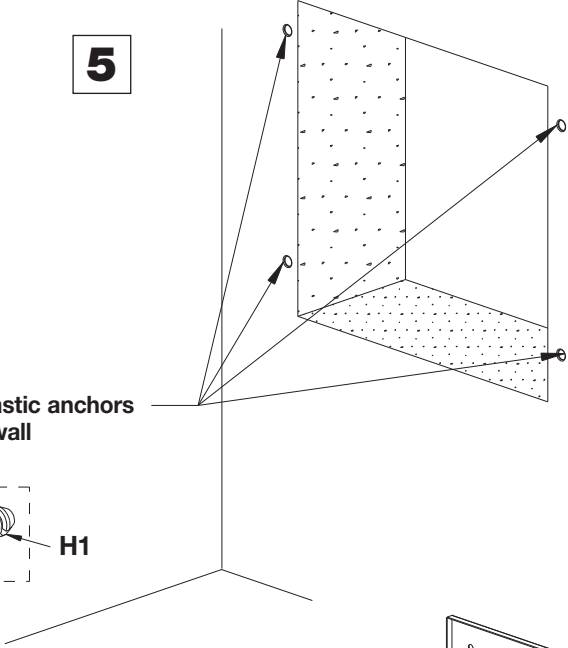
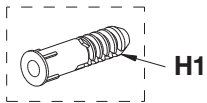

6

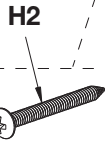

Install cabinet with screws provided

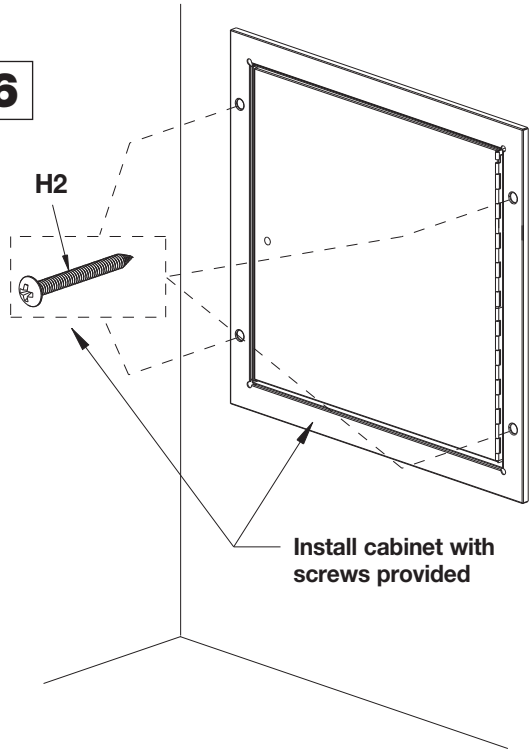

7

Repeat step 4 through 6 to attach frame from the opposite wall with remaining screws and anchors.

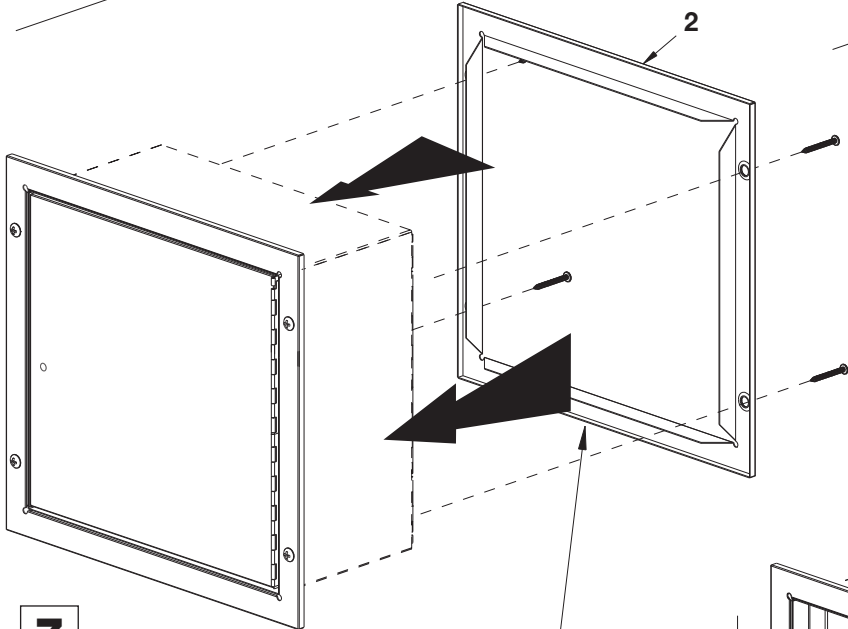

8

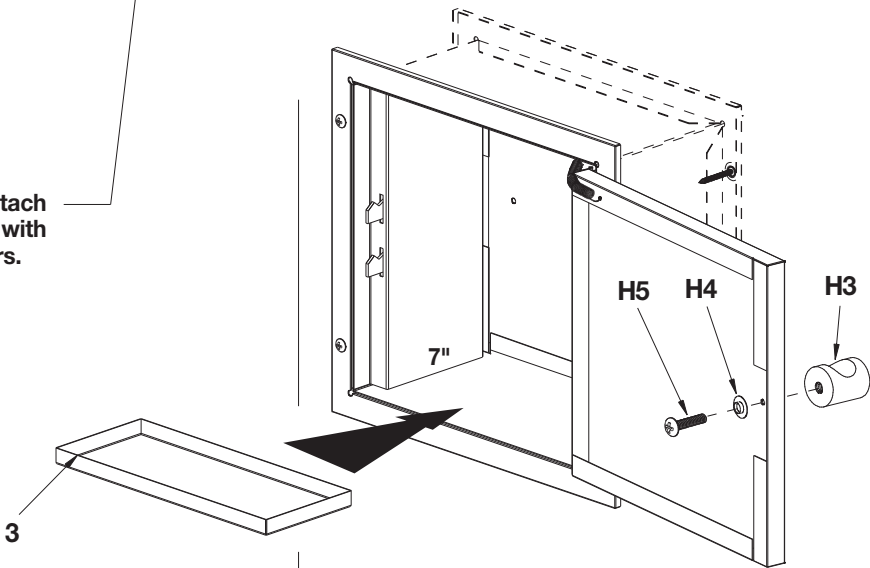

**NOTE:**  
Doors are interlocked so that when one door is open, the opposite door is locked.

Assembly Instructions	Instrucciones de Ensamblaje	Directives d'assemblage
Customer Service US: 1-800-645-2986	Servicio de atención al Cliente México: 01.800.681.6940	Service à la clientèle Canada: 888-645-2986

**NOTA:**  
Resorte dentro de la puerta hacia arriba

## Pasar a Través del Gabinete de Muestra

Modelo 647108

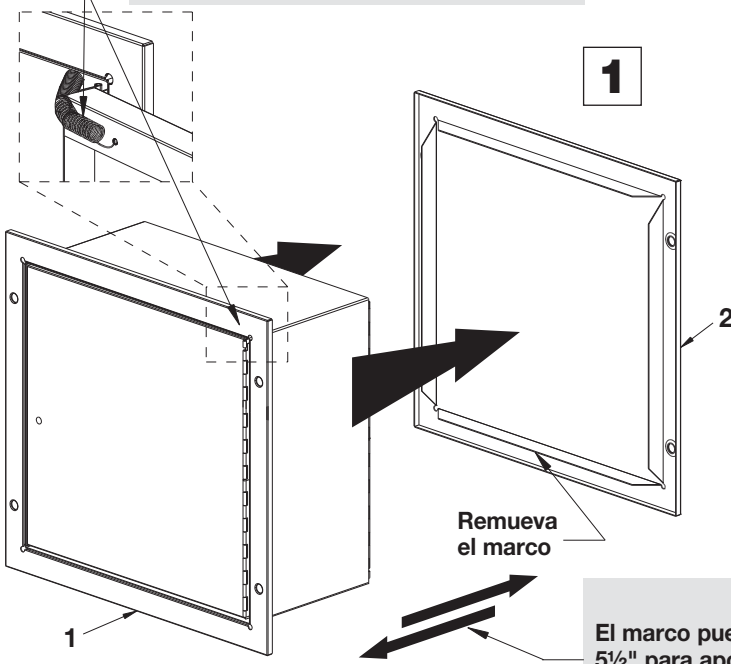

CONTENIDO		
Ref.	Cant.	Descripción
1	1	Amarrio
2	1	Marco
3	1	Bandeja de Derrames
H1	8	Anclaje Plástico
H2	8	Tornillo Phillips de Madera de Cabeza Plana #6 x 1.5 Lg.
H3	2	Llavín de puerta
H4	2	Arandela Brida de Eje
H5	2	Tornillo Phillips de Cabeza Plana M4 x .7 x 7mm Lg.

**NOTA:**  
El marco puede ajustarse desde 1" hasta 5½" para apoyar el espesor de pared

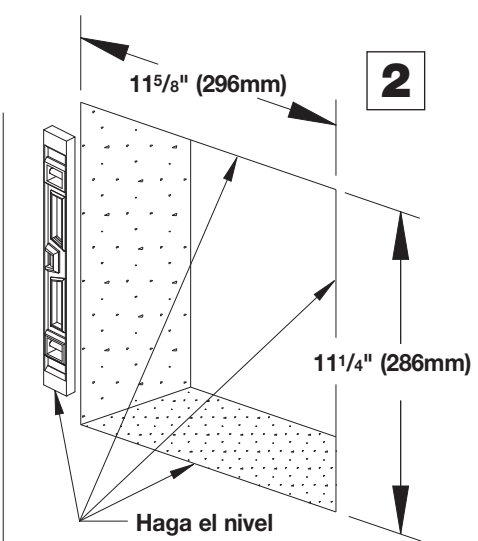

Prepare pasar a través de la abertura de pared con las dimensiones mostradas

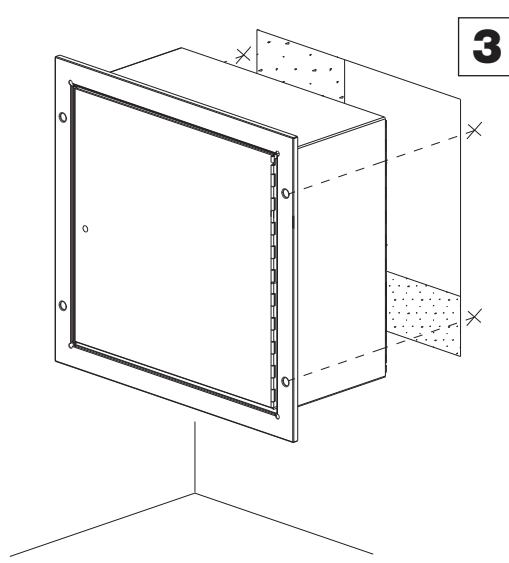

Alinee el gabinete a la abertura y marque las ubicaciones de los agujeros

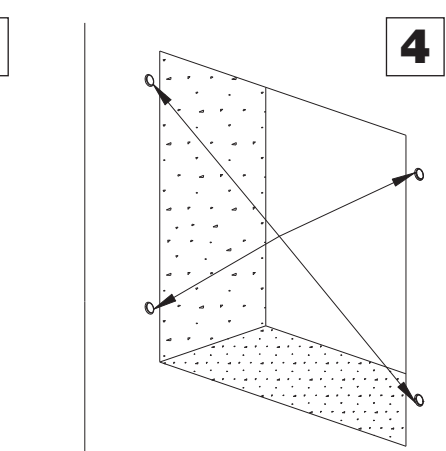

Perfore (4) hoyos de 1/4" (6.35mm) de diámetro de 1 3/8" (35mm) de profundidad.

# Pasar a Través del Gabinete de Muestra

5

Inserte los anclajes plásticos al ras con la pared

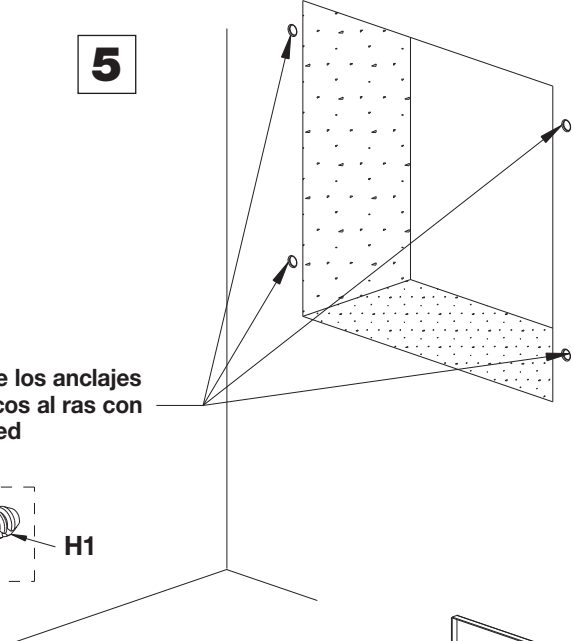
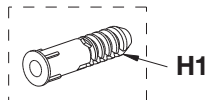

6

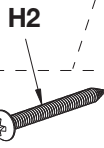

Instale el armario con los tornillos proporcionados

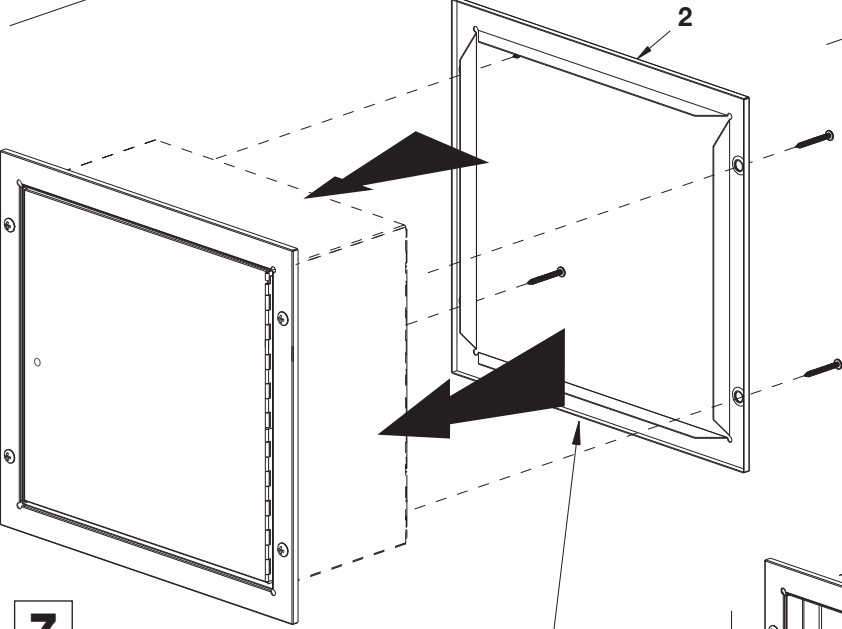
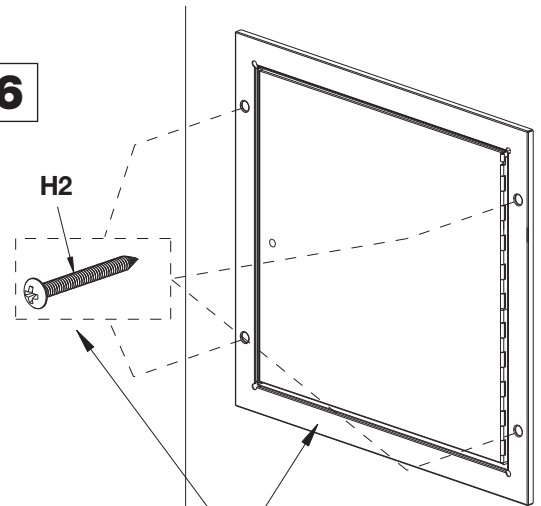

7

Repita pasos 4 al 6 para fijar el marco de la pared opuesta con los tornillos y anclajes restantes.

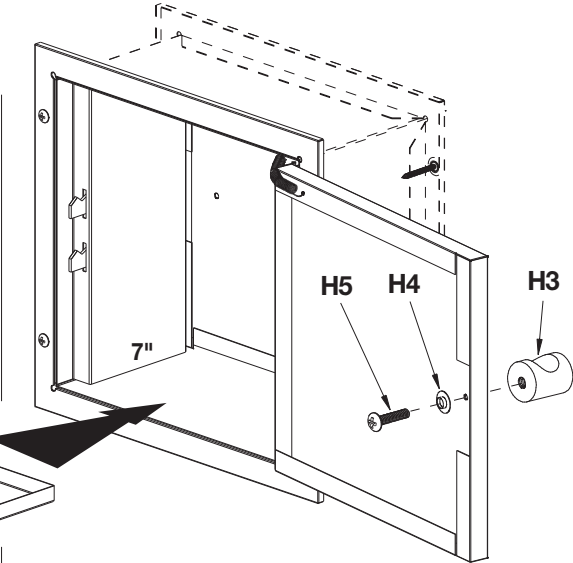

8

**NOTA:**  
Las puertas están interconectadas de tal manera que cuando una puerta está abierta, la puerta opuesta está bloqueada.

Assembly Instructions	Instrucciones de Ensamblaje	Directives d'assemblage
Customer Service US: 1-800-645-2986	Servicio de atención al Cliente México: 01.800.681.6940	Service à la clientèle Canada: 888-645-2986

## Armoire d'échantillon traversante

Modèle 647108

CONTENU		
Réf.	Qté	Description
1	1	Armoire
2	1	Cadre
3	1	Plateau de décharge
H1	8	Cheville en plastique
H2	8	Vis en bois à tête cylindrique Phillips #6 x 1.5 Lg.
H3	2	Poignée de la porte
H4	2	Rondelle à bride de l'essieu
H5	2	Vis à tête cylindrique Phillips M4 x .7 x 7mm Lg.

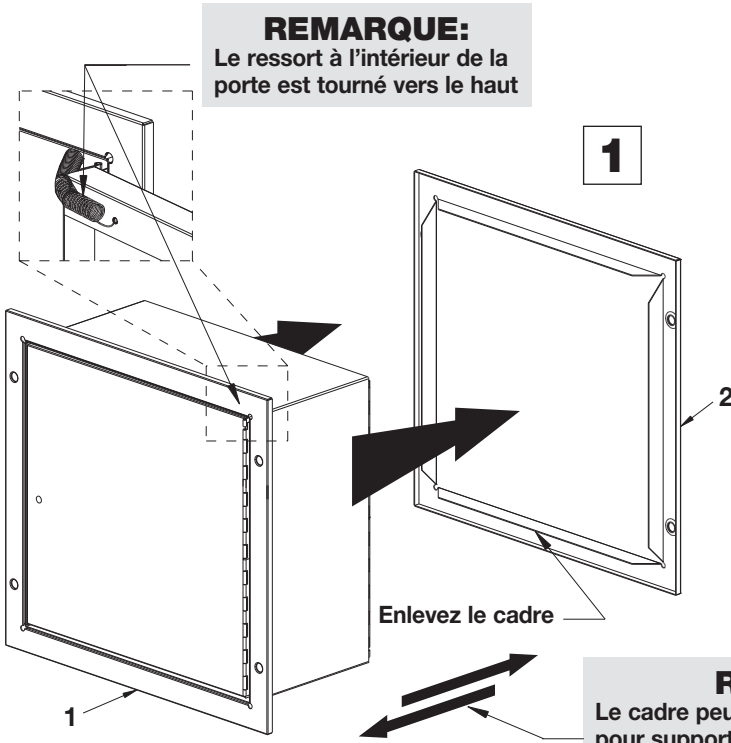

**REMARQUE:**  
Le cadre peut s'ajuster de 30 cm à 1,5 m pour supporter l'épaisseur des murs

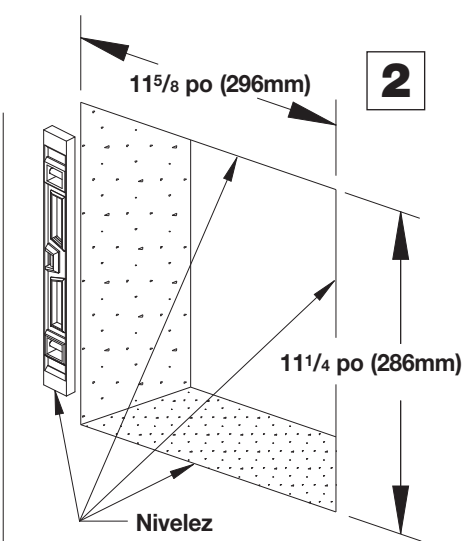

Préparez le passage à travers l'ouverture du mur aux dimensions indiquées

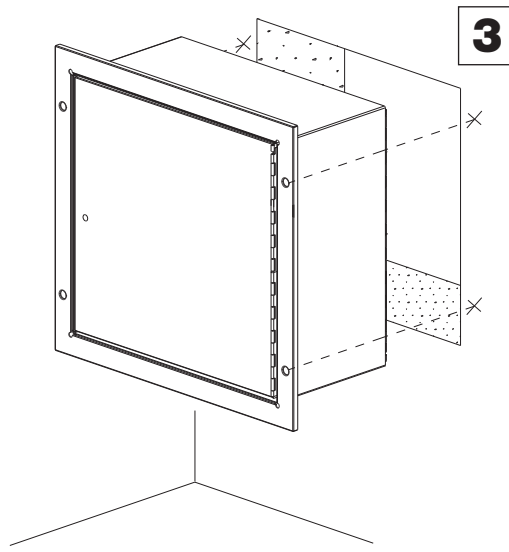

Alignez l'armoire à l'ouverture et marquez les emplacements des trous

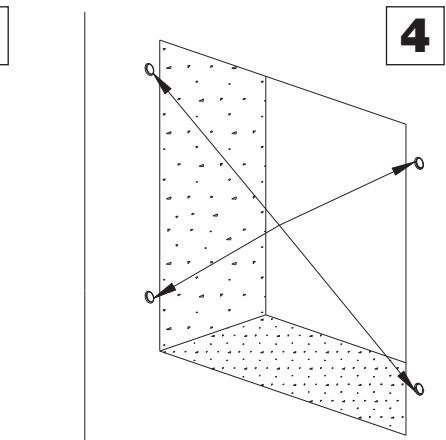

Percez (4) trous de 6,35 mm de diamètre et 35 mm de profondeur.

# Armoire d'échantillon traversante

5

Insérez les chevilles en plastique au ras du mur

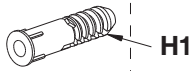

H1

6

H2

Installez l'armoire avec les vis fournies

7

Recommencez l'étape 4 à 6 pour attacher le cadre depuis le mur opposé à l'aide des autres vis et chevilles.

3

8

7 po

H5

H4

H3

**REMARQUE:**  
Les portes sont imbriquées de sorte que lorsqu'une porte est ouverte, la porte opposée est verrouillée.