

WARMING CABINETS



Superior Performance;
Outstanding Reliability



*Delivering Total Healthcare Value
— Since 1935 —*

INTRODUCING

WARMING CABINETS



OR-7854
Single Compartment

Warm your blankets, fluids and solutions quickly and safely with Imperial Surgical **Warming Cabinets**.

Our warmers are ergonomic, aesthetically designed, and use state-of-the-art microprocessors.



NEW! Easy Access System

- We have made every aspect of the cabinet easy to service - with a simple turn of a secured key, all the electrical components are exposed.

NEED ADDITIONAL INFORMATION? CALL US TODAY!
1.800.661.5432 (TOLL-FREE)



CABINET DESIGN

- Cabinets are designed to ensure maximum storage
- All cabinet bodies and interior components are fully welded stainless steel with a #4 polished finish and insulated with R-6 rating
- Cabinets come complete with adjustable leveling feet

Cabinet doors are fully insulated stainless steel with a reversible hinge/handle assembly (for left or right opening configurations)

- Stainless steel: 18 gauge exterior, 20 gauge door and shelves
- The door and frame are sealed using a high-temperature rubber gasket with a magnetic insert; this provides a guaranteed air tight seal with no mechanical handles that can break or require maintenance, AND prevents the possibility of heat loss.

SUPERIOR AIR CIRCULATION

- Long lasting muffin fan system provides improved air distribution throughout the cabinet and rapid heat recovery
- Interior shelves are perforated stainless steel providing excellent weight capacity with no flexing, and allow for improved air circulation
- All shelves are adjustable and designed with fully welded retainers and stops to prevent tipping when in the extended position (up to 50%) or accidental removal.

All models
available with
glass inset doors!



Toll Free: 1.800.661.5432 / 1.514.631.7988
www.surgmed.com • e-mail: info@surgmed.com

Fax: 514.631.9083

TEMPERATURE CONTROL

- A microprocessor-based thermostat, complete with digital display, accurately controls the temperature setting.
- Temperature setting and display are accurate to within +/- 1.5 degrees Celsius (+/- 2.7°F)*

*Units are available in Fahrenheit or Celsius. Please specify when ordering. The default is Celsius.



- All cabinets are equipped with a high-temperature overload switch which will disconnect all power to the cabinet should an electrical malfunction occur
- Microprocessor thermostat controller is pre-set by the factory; re-programming is user-friendly
- Standard maximum temperature selection is 71°C/160°F in order to avoid accidentally injuring the hospital staff or patient
- A high-temperature warning light is also provided should the cabinet temperature exceed the pre-selected setting by 6°C/10°F
- Lockable temperature settings for added safety

(On request, the maximum setting can be programmed up to 82°C/180°F.)



7 Year Warranty

We offer one of the best warranties in the industry. First year covers parts and labor, the remaining 6 years for parts only. If any part breaks due to normal wear and tear or is defective, it will be replaced. Warranty includes everything: fans, couplers, processors, hinges, there are no exclusions. The stainless steel cabinet is warranted for 7 years against manufacturing defects.



- Units with double compartment cabinets include two microprocessor thermostats individually controlling each cabinet
- Cabinet heat is provided by heavy-duty low wattage tubular elements for safe even heating; element cycles are monitored by a pilot light indicator on the control panel
- All electronic components are easily accessible for maintenance.



OR-9000
Single Compartment



OR-8154
Inset glass door reduces heat loss and is more durable than full glass doors, while permitting excellent content visibility.



OR-7954
Double Compartment

User Instructions: User instructions are written on the front panel. Instructions are available in multiple languages (call for details).

Redundant Safety: Should the temperature elevate more than 20% above the maximum, it will shut down completely.

Cool Cabinet: Our insulation R factor is probably one of the best. Even when running at maximum temperature, the exterior of the cabinet will remain cool.

By default, all our warming cabinets are mounted on a **caster dolley**. If you require a **caster frame** to be installed, please call us for more information.

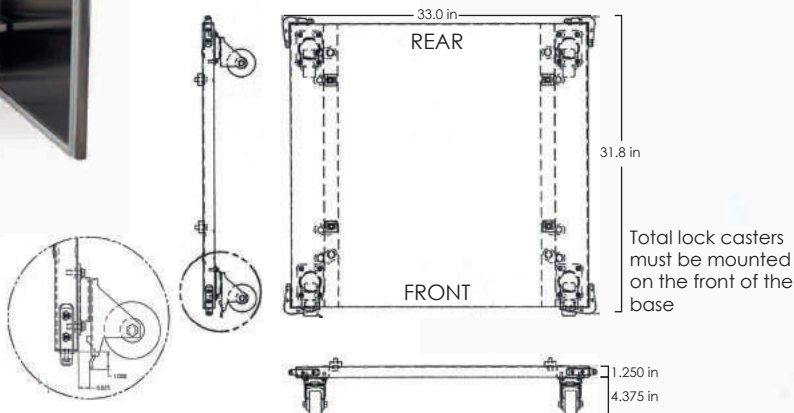

WARMING CABINETS - TECHNICAL SPECIFICATIONS

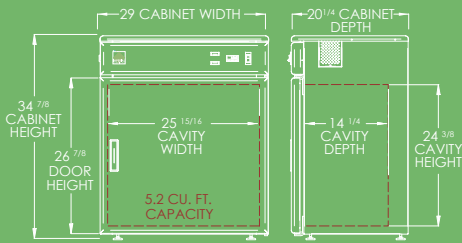

OR-7054 / OR-8054

Single Compartment 29 x 20 x 34

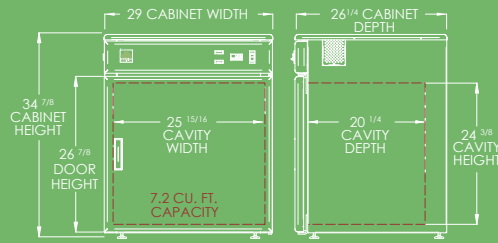

OR-7154 / OR-8154

Single Compartment 29 x 26 x 34

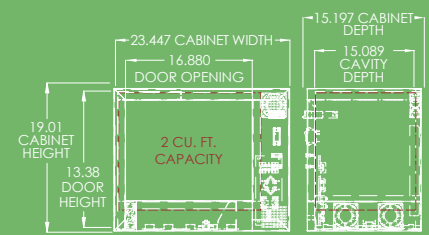

OR-9000

Single Compartment Plexi-Glass Door 23.4x15.2x19

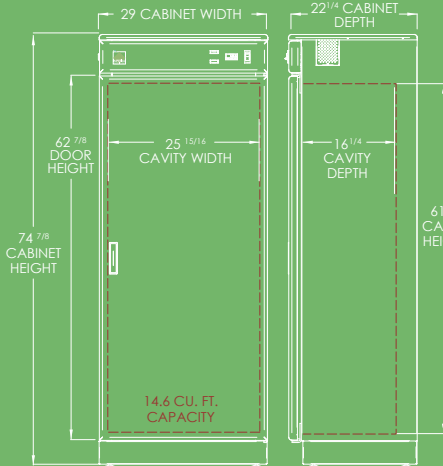

OR-7754 / OR-8754

Single Compartment 29 x 22 x 74

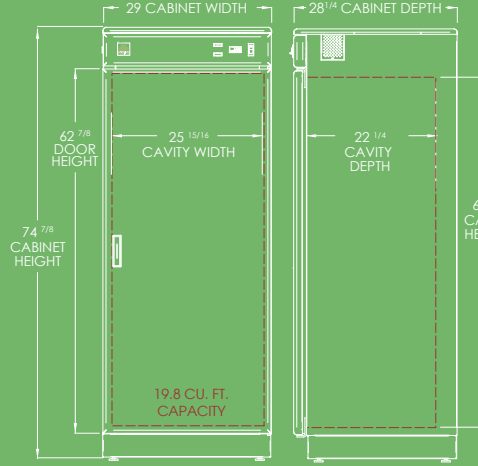

OR-7854 / OR-8854

Single Compartment 29 x 28 x 74

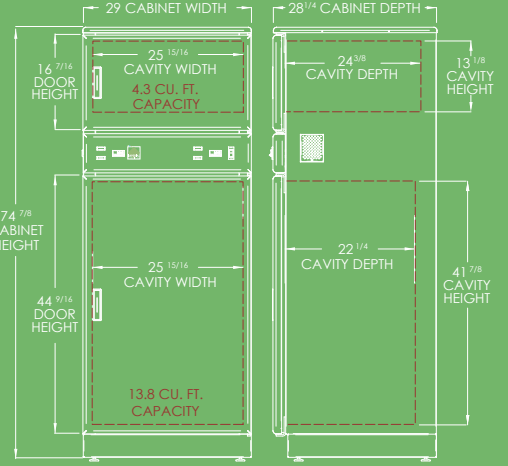

OR-7954 / OR-8954

Double Compartment 29 x 28 x 74

Electrical Data

ITEM NO:	OR-7054 / OR-7154 OR-8054 / OR-8154	OR-7754 / OR-7854 OR-8754 / OR-8854	OR-7954 / OR-8954 OR-9954	OR-9000
SERVICE REQUIRED:	120V, 60Hz	120V, 60Hz	120V, 60Hz	120V, 60Hz
AMPERAGE:	3.1 Amps	6.0 Amps	9.0 Amps	1.67 Amps
WATTS:	370	700	1050	200

(220 volt available on request)

(Hospital grade power cord length 185cm/72")

Product Codes

ITEM NO. STAINLESS STEEL DOORS	ITEM NO. GLASS DOORS	DESCRIPTION	CABINET DIMENSIONS (WxDxH) - INCHES	CAPACITY (CU.FT)	NUMBER OF SHELVES	SHELF DIMENSIONS (WxD) - INCHES
OR-7054	OR-8054	Single Compartment	29 x 20 x 34	5.2	1	24.25 x 14
OR-7154	OR-8154	Single Compartment	29 x 26 x 34	7.2	1	24.25 x 16
OR-7754	OR-8754	Single Compartment	29 x 22 x 74	14.6	3	24.25 x 20
OR-7854	OR-8854	Single Compartment	29 x 28 x 74	19.8	3	24.25 x 22
OR-7954	OR-8954	Double Compartment	29 x 28 x 74	(upper) 4.3 (lower) 13.8	3	24.25 x 22
	OR-9000	Single Compartment	23.4 x 15.2 x 19	2	1	17 x 15.1
	OR-9954	Double Compartment	26 x 25 x 74	TBD	3	TBD

In the event you do not have a counter available, the counter Top models (OR-7054, OR-8054, OR-7154 & OR-8154) are available with a stand (OR-7995) specifically designed to support the weight of a table top/counter top warming cabinet. Call us for more details.



IMPERIAL SURGICAL LTD.

Toll Free : 1.800.661.5432 Fax: 514.631.9083
 North America: 514.631.7988 International: +1.514-631-7988

Corporate Website: www.surgmed.com E-Mail (General): info@surgmed.com