

### Application

Ideal for use where Lead-Free\* fittings are required. Designed for installation on potable water lines to protect against piping system deterioration caused by galvanic and stray current corrosion. A dielectric fitting is necessary where dissimilar metals are used in piping systems.

### LEAD PLUMBING LAW COMPLIANCE

(0.25% MAX. WEIGHTED AVERAGE LEAD CONTENT)

- Lead Plumbing Law Certified by IAPMO R&T

### Materials

Body & flanges	Steel w/Galvanized Coat
Bolts & nuts	Steel w/Galvanized Coat
Tailpiece	Low Lead Brass
Insulator	Nylon
Gaskets	EPDM (Standard) Viton (High Temp)

### Features

Sizes:	1/2", 3/4", 1", 1 1/4", 1 1/2", 2", 2 1/2", 3"
Maximum working water pressure	250 PSI
Maximum working water temperature	180°F
Thread connections	ANSI B 1.20.1
Copper connections	ANSI B 16.22

### Dimensions & Weights (do not include pkg.)

FEMALE IRON PIPE BY FEMALE COPPER SOLDER JOINT								
PART NUMBER	DIMENSIONS						WEIGHT	
	INLET SIZE	OUTLET SIZE	A		B		lbs.	kg
			in.	mm	in.	mm		
12-DUXLC	1/2"	1/2"	1 13/16	46	1	25	0.4	0.2
34-DUXLC	3/4"	3/4"	2	51	1 1/4	32	0.5	0.2
34-DUXL12C	3/4"	1/2"	1 13/16	46	1 1/4	32	0.5	0.2
1-DUXLC	1"	1"	2 1/4	57	1 1/2	38	0.6	0.3
114-DUXLC	1 1/4"	1 1/4"	2 13/32	61	1 7/8	48	0.8	0.4
112-DUXLC	1 1/2"	1 1/2"	2 1/2	64	2 5/32	55	1.3	0.6
2-DUXLC	2"	2"	2 15/16	75	2 25/32	71	2.5	1.1
FLANGED FEMALE IRON PIPE BY FEMALE COPPER SOLDER JOINT								
212-DUXLC	2 1/2"	2 1/2"	3 5/8	92	6	152	13	5.9
3-DUXLC	3"	3"	3 5/8	92	6 11/16	170	15	6.8

MALE IRON PIPE BY FEMALE COPPER SOLDER JOINT								
PART NUMBER	INLET SIZE	OUTLET SIZE	A		B		WEIGHT	
			in.	mm	in.	mm	lbs.	kg
12-DUXLM	1/2"	1/2"	2 3/4	70	13/16	21	0.5	0.2
34-DUXLM	3/4"	3/4"	3	76	1	25	0.6	0.3
34-DUXLM12C	3/4"	1/2"	2 3/4	70	13/16	21	0.7	0.3

### Specifications

The Dielectric Union shall be ANSI 3<sup>rd</sup> party certified to comply with states' lead plumbing law 0.25% maximum weighted average lead content requirement, rated for 250 psi (ANSI B 16.39). Flanged fittings shall be rated for 175 psi (ANSI B16.42 or B 16.24). The body and nut shall be steel with galvanized coat, the insulator shall be nylon, the tailpiece shall be low lead brass and the gaskets shall be EPDM (standard) or viton (high temp). The Dielectric Union shall be a ZURN WILKINS Model DUXL, DUXLC or DUXLM.



MODEL DUXL



MODEL DUXLC (2 1/2" & 3")



MODEL DUXLC



MODEL DUXLM



### Options

- HT - high temp applications (300°F @ 50 psi) (250°F @75 psi) (200°F @150psi)

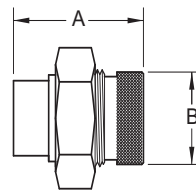

MODEL DUXL

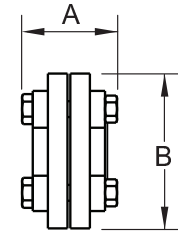

MODEL DUXLC (2 1/2" & 3")

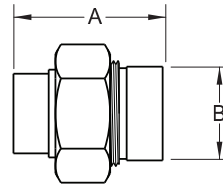

MODEL DUXLC

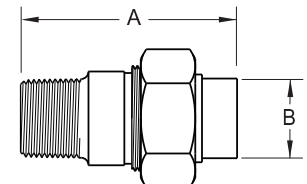

MODEL DUXLM

FEMALE IRON PIPE BY FEMALE BRASS PIPE								
PART NUMBER	DIMENSIONS						WEIGHT	
	INLET SIZE	OUTLET SIZE	A		B		lbs.	kg
			in.	mm	in.	mm		
12-DUXL	1/2"	1/2"	2	51	1	25	0.5	0.2
34-DUXL	3/4"	3/4"	2 1/4	57	1 1/4	32	0.75	0.3
1-DUXL	1"	1"	2 1/2	64	1 1/4	32	1	0.5
114-DUXL	1 1/4"	1 1/4"	2 17/32	64.3	1 13/16	46	1.4	0.6
112-DUXL	1 1/2"	1 1/2"	2 15/16	75	2 3/16	56	3	1.4
2-DUXL	2"	2"	3	76	2 3/4	70	3.87	1.8