



No.:

Date: 28-DEC-2012

Customer :

TECHNICAL PROPOSAL

Three-phase induction motor - Squirrel cage rotor

Product line : Jet Pump - NEMA 56 : Three-Phase - Keyed - ODP (IP21)

Catalog Number : 00236OS3EJPR56C

List Price : \$311

Notes:

Performed by:

Checked:



No.:

Date: 28-DEC-2012

## DATA SHEET

### Three-phase induction motor - Squirrel cage rotor

Customer :  
Product line : Jet Pump - NEMA 56 : Three-Phase - Keyed - ODP (IP21)

Frame : D56  
Output : 2 HP  
Frequency : 60 Hz  
Poles : 2  
Full load speed : 3460  
Slip : 3.89 %  
Voltage : 208-230/460 V  
Rated current : 5.70-5.36/2.68 A  
Locked rotor current : 43.4/21.7 A  
Locked rotor current (I<sub>L</sub>/I<sub>n</sub>) : 8.1  
No-load current : 2.58/1.29 A  
Full load torque : 2.99 lb.ft  
Locked rotor torque : 330 %  
Breakdown torque : 340 %  
Design : A  
Insulation class : B  
Temperature rise : 80 K  
Locked rotor time : 10 s (hot)  
Service factor : 1.20 (1.00 at 208V)  
Duty cycle : S1  
Ambient temperature : -20°C - +40°C  
Altitude : 1000  
Degree of Protection : IP21  
Approximate weight : 38 lb  
Moment of inertia : 0.04129 sq.ft.lb  
Noise level : ---

	D.E.	N.D.E.	Load	Power factor	Efficiency (%)
Bearings	6204 2RS	6202 2RS	100%	0.87	81.0
Regreasing interval	---	---	75%	0.80	80.5
Grease amount	---	---	50%	0.68	78.0

Notes:

Performed by

Checked



No.:

Date: 28-DEC-2012

### PERFORMANCE CURVES RELATED TO RATED OUTPUT

Three-phase induction motor - Squirrel cage rotor

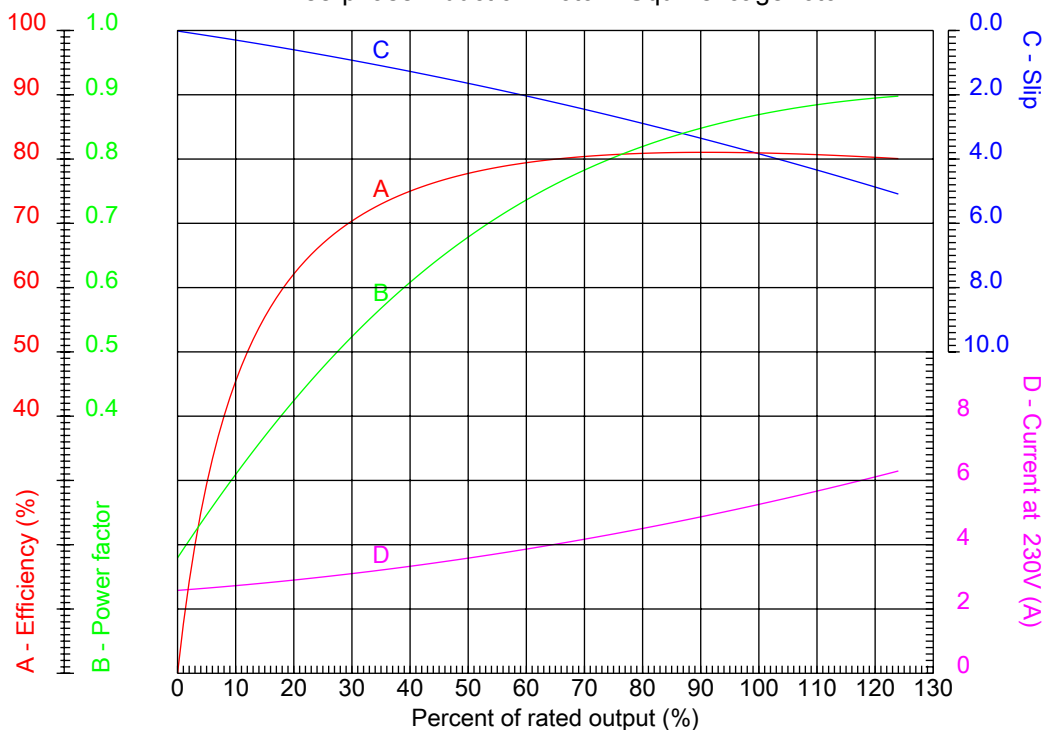

Customer :  
Product line : Jet Pump - NEMA 56 : Three-Phase - Keyed - ODP (IP21)

Frame : D56	Locked rotor current (I <sub>l</sub> /I <sub>n</sub> ) : 8.1
Output : 2 HP	Duty cycle : S1
Frequency : 60 Hz	Service factor : 1.20 (1.00 at 208V)
Full load speed : 3460	Design : A
Voltage : 208-230/460 V	Locked rotor torque : 330 %
Rated current : 5.70-5.36/2.68 A	Breakdown torque : 340 %
Insulation class : B	

Notes:

Performed by

Checked



No.:

Date: 28-DEC-2012

### CHARACTERISTIC CURVES RELATED TO SPEED Three-phase induction motor - Squirrel cage rotor

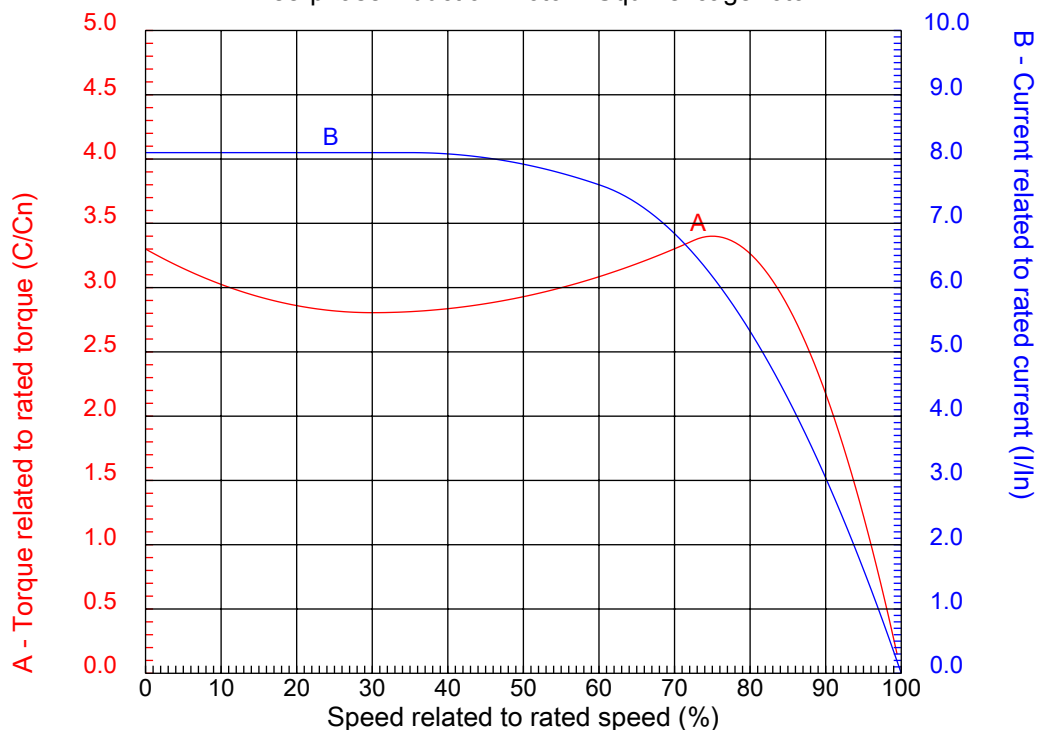

Customer :  
Product line : Jet Pump - NEMA 56 : Three-Phase - Keyed - ODP (IP21)

Frame	: D56	Locked rotor current (I <sub>l</sub> /I <sub>n</sub> )	: 8.1
Output	: 2 HP	Duty cycle	: S1
Frequency	: 60 Hz	Service factor	: 1.20 (1.00 at 208V)
Full load speed	: 3460	Design	: A
Voltage	: 208-230/460 V	Locked rotor torque	: 330 %
Rated current	: 5.70-5.36/2.68 A	Breakdown torque	: 340 %
Insulation class	: B		

Notes:

Performed by

Checked

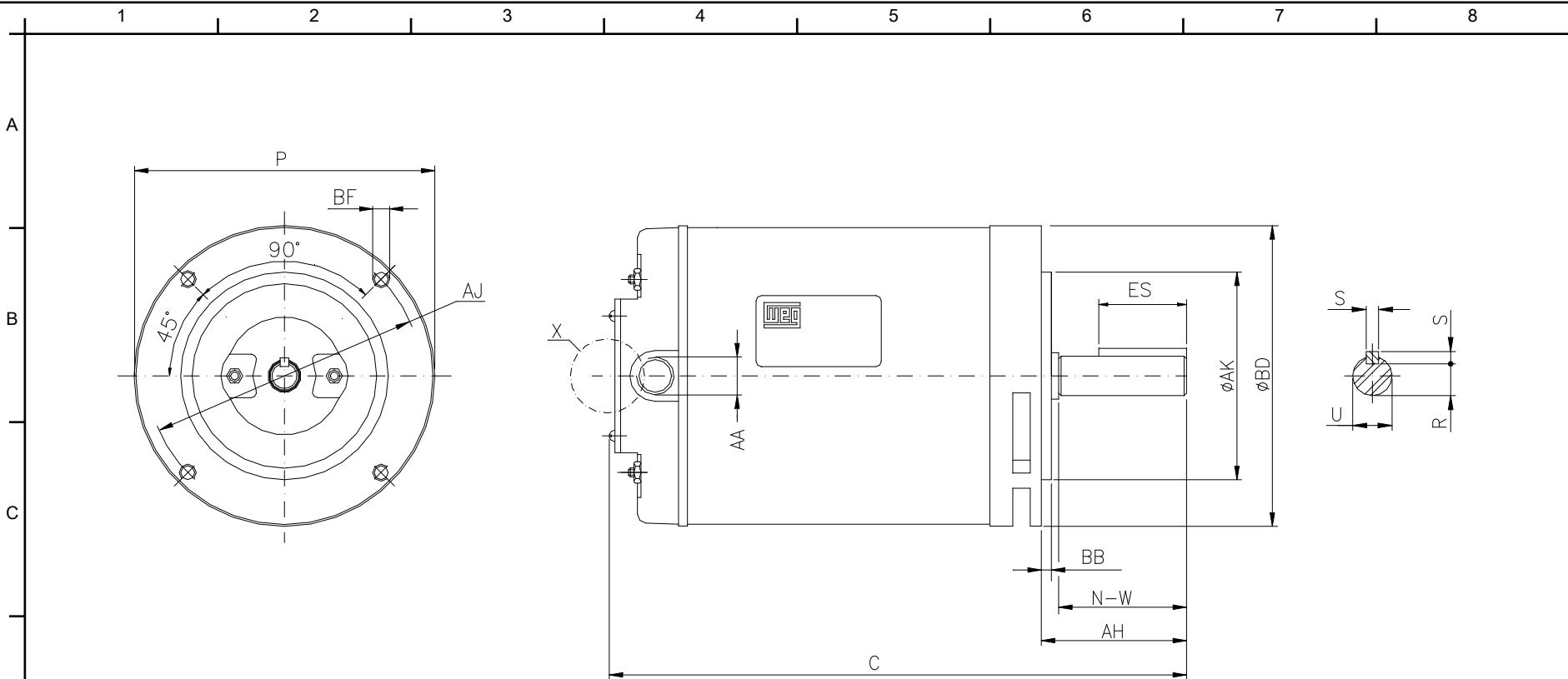

Notes:

Performed by:

Checked:

Customer:

C	P	ES	S	N-W
12.283	6.496	1.417	0.187	1.874
U	R	AA	Flange	AJ
0.625	0.517	NPT 1/2"	FC-149	5.874
AK	BD	BF	BB	BC
4.500	6.535	114.3	0.157	---
AH				
2.063				

Jet Pump - NEMA 56 : Three-Phase - Keyed - ODP (IP21)

Three-phase induction motor  
Frame D56 - IP21

28-DEC-2012

