



No.:

Date: 26-DEC-2012

Customer :

TECHNICAL PROPOSAL

Three-phase induction motor - Squirrel cage rotor

Product line : Close Coupled Pump : Three-Phase - "JM" Type - ODP - High Efficiency

Catalog Number : 00736OP3E184JM

List Price : \$862

Notes:

Performed by:

Checked:



No.:

Date: 26-DEC-2012

DATA SHEET

Three-phase induction motor - Squirrel cage rotor

Customer :
Product line : Close Coupled Pump : Three-Phase - "JM" Type - ODP - High Efficiency

Frame : 184JM
Output : 7.5 HP
Frequency : 60 Hz
Poles : 2
Full load speed : 3485
Slip : 3.19 %
Voltage : 208-230/460 V
Rated current : 19.8-17.9/8.97 A
Locked rotor current : 126/62.8 A
Locked rotor current (I_L/I_n) : 7.0
No-load current : 6.20/3.10 A
Full load torque : 11.1 lb.ft
Locked rotor torque : 220 %
Breakdown torque : 300 %
Design : B
Insulation class : F
Temperature rise : 80 K
Locked rotor time : 13 s (hot)
Service factor : 1.15
Duty cycle : S1
Ambient temperature : -20°C - +40°C
Altitude : 1000
Degree of Protection : IP21
Approximate weight : 60 lb
Moment of inertia : 0.16350 sq.ft.lb
Noise level : ---

| | D.E. | N.D.E. | Load | Power factor | Efficiency (%) |
|---------------------|---------|---------|------|--------------|----------------|
| Bearings | 6207 ZZ | 6205 ZZ | 100% | 0.88 | 87.5 |
| Regreasing interval | --- | --- | 75% | 0.84 | 87.5 |
| Grease amount | --- | --- | 50% | 0.75 | 86.5 |

Notes:

Performed by

Checked



No.:

Date: 26-DEC-2012

PERFORMANCE CURVES RELATED TO RATED OUTPUT
Three-phase induction motor - Squirrel cage rotor

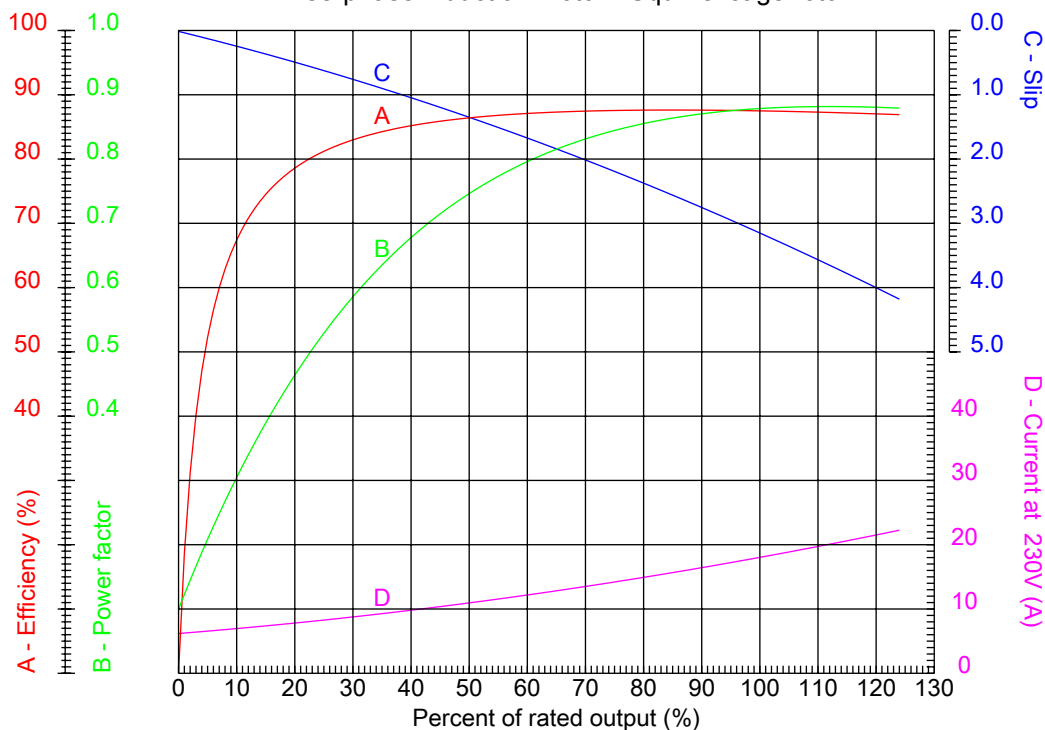

Customer :
Product line : Close Coupled Pump : Three-Phase - "JM" Type - ODP - High Efficiency

| | | | |
|------------------|--------------------|--|---------|
| Frame | : 184JM | Locked rotor current (I _l /I _n) | : 7.0 |
| Output | : 7.5 HP | Duty cycle | : S1 |
| Frequency | : 60 Hz | Service factor | : 1.15 |
| Full load speed | : 3485 | Design | : B |
| Voltage | : 208-230/460 V | Locked rotor torque | : 220 % |
| Rated current | : 19.8-17.9/8.97 A | Breakdown torque | : 300 % |
| Insulation class | : F | | |

Notes:

Performed by

Checked



No.:

Date: 26-DEC-2012

CHARACTERISTIC CURVES RELATED TO SPEED

Three-phase induction motor - Squirrel cage rotor

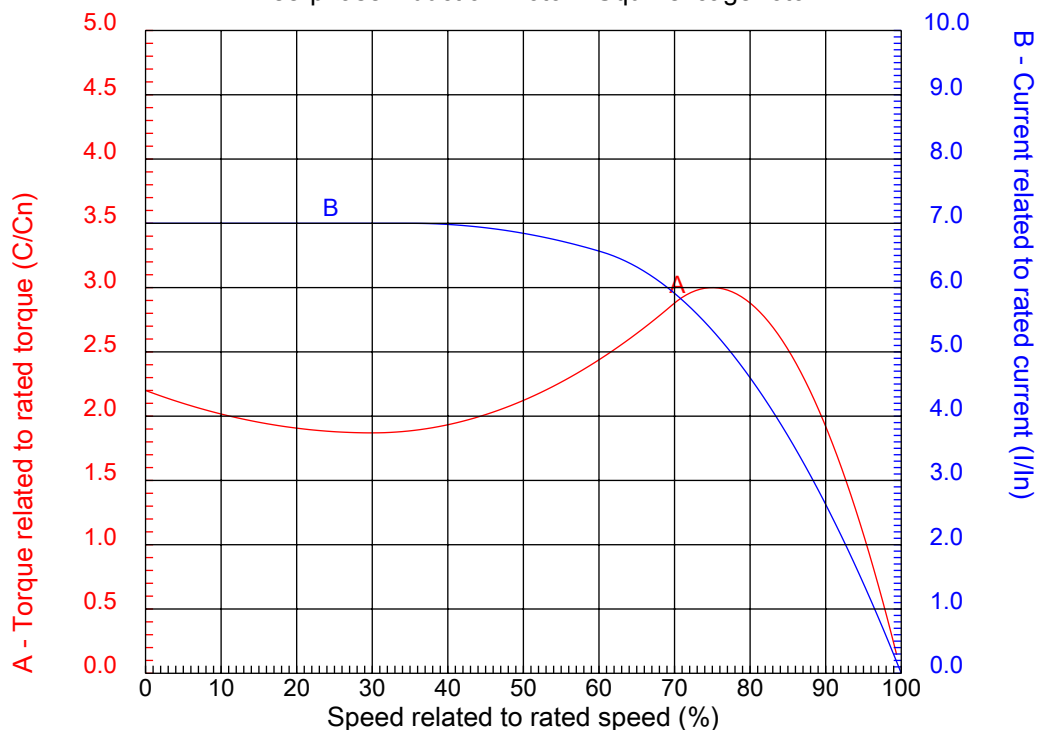

Customer :
Product line : Close Coupled Pump : Three-Phase - "JM" Type - ODP - High Efficiency

| | | | |
|------------------|--------------------|--|---------|
| Frame | : 184JM | Locked rotor current (I _l /I _n) | : 7.0 |
| Output | : 7.5 HP | Duty cycle | : S1 |
| Frequency | : 60 Hz | Service factor | : 1.15 |
| Full load speed | : 3485 | Design | : B |
| Voltage | : 208-230/460 V | Locked rotor torque | : 220 % |
| Rated current | : 19.8-17.9/8.97 A | Breakdown torque | : 300 % |
| Insulation class | : F | | |

Notes:

Performed by

Checked

1 2 3 4 5 6 7 8

A

B

C

D

E

F

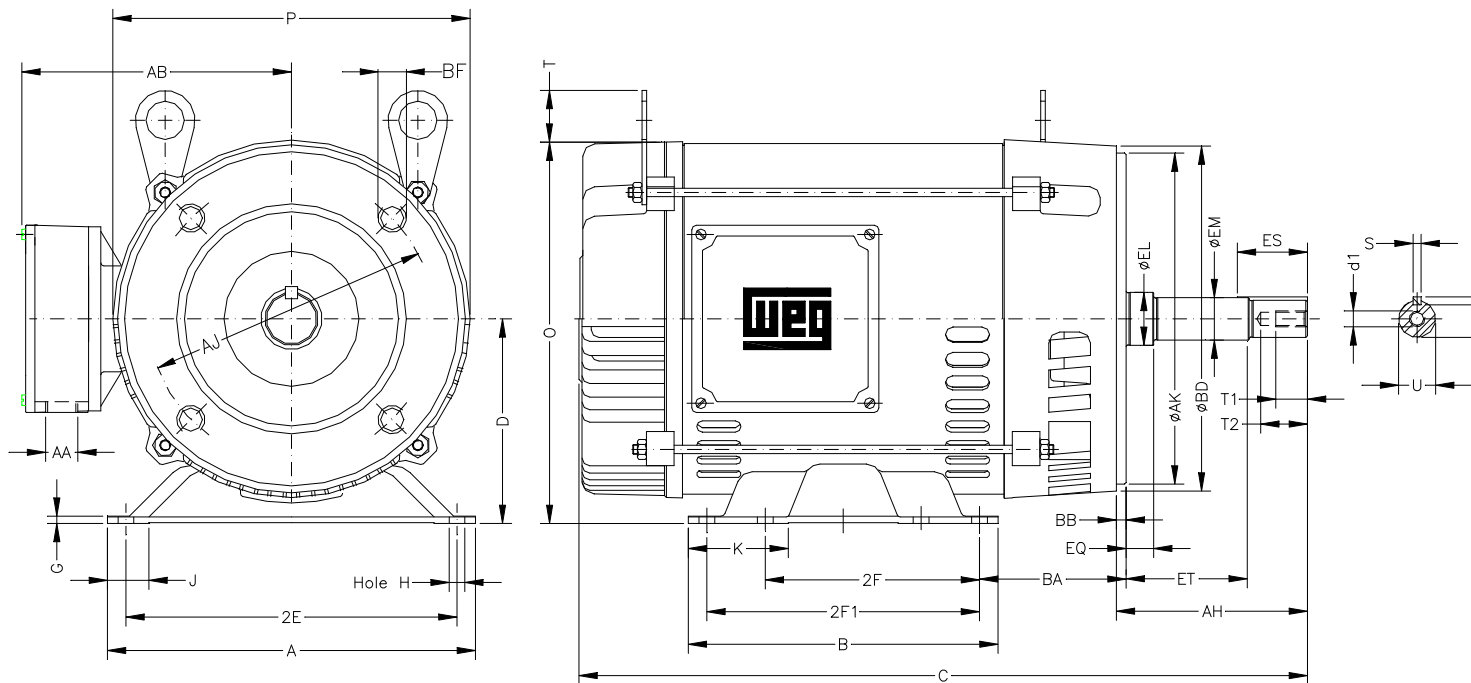

Notes:

Performed by:

Checked:

Customer:

Close Coupled Pump : Three-Phase - "JM" Type - ODP - High Efficiency

Three-phase induction motor
Frame 184JM - IP21

26-DEC-2012



| | | | | |
|--------------------|-------------|-------------------|-------------------|------------------|
| 2E 7.500 | A 8.661 | 2F 4.500/5.500 | B 6.299 | J 1.171 |
| BA 2.750 | D 4.500 | K 1.988 | G 0.187 | O 8.307 |
| P 7.637 | T 1.614 | HD 9.921 | AB 6.574 | H 0.406 |
| AA NPT 3/4" | EQ 0.630 | ET 2.880 | U 0.874 | EM 1.000 |
| EL 1.250 | S 0.187 | EP 1.376 | R 0.767 | ES 1.575 |
| d1 EUNC 3/8"-16 | t1 0.748 | t2 1.102 | C 15.315 | Flange FC-149 |
| AJ 5.874 | AK 4.500 | BD 6.496 | BF UNC 3/8"x16 | BB 0.157 |
| BC | AH 4.258 | | | |