



No.:

Date: 24-DEC-2012

Customer :

TECHNICAL PROPOSAL

Three-phase induction motor - Squirrel cage rotor

Product line : Three-Phase: W21 IE3 IEC Tru-Metric - TEFC (IP55) Multi-Mounting Aluminum Frame

Catalog Number : 00158ET3WAL90L

List Price : \$524

Notes:

Performed by:

Checked:



No.:

Date: 24-DEC-2012

DATA SHEET

Three-phase induction motor - Squirrel cage rotor

Customer :
Product line : Three-Phase: W21 IE3 IEC Tru-Metric - TEFC (IP55) Multi-Mounting Aluminum Frame

Frame : 90S/L
Output : 2 HP
Frequency : 60 Hz
Poles : 4
Full load speed : 1755
Slip : 2.50 %
Voltage : 460 V
Rated current : 2.79 A
Locked rotor current : 23.2 A
Locked rotor current (I_L/I_n) : 8.3
No-load current : 1.68 A
Full load torque : 5.90 lb.ft
Locked rotor torque : 300 %
Breakdown torque : 400 %
Design : N
Insulation class : F
Temperature rise : 80 K
Locked rotor time : 14 s (hot)
Service factor : 1.25
Duty cycle : S1
Ambient temperature : -20°C - +40°C
Altitude : 1000
Degree of Protection : IP55
Approximate weight : 43 lb
Moment of inertia : 0.15662 sq.ft.lb
Noise level : 49 dB(A)

	D.E.	N.D.E.	Load	Power factor	Efficiency (%)
Bearings	6205 ZZ	6204 ZZ	100%	0.78	86.5
Regreasing interval	---	---	75%	0.69	85.5
Grease amount	---	---	50%	0.56	82.5

Notes:

Performed by

Checked



No.:

Date: 24-DEC-2012

PERFORMANCE CURVES RELATED TO RATED OUTPUT
 Three-phase induction motor - Squirrel cage rotor

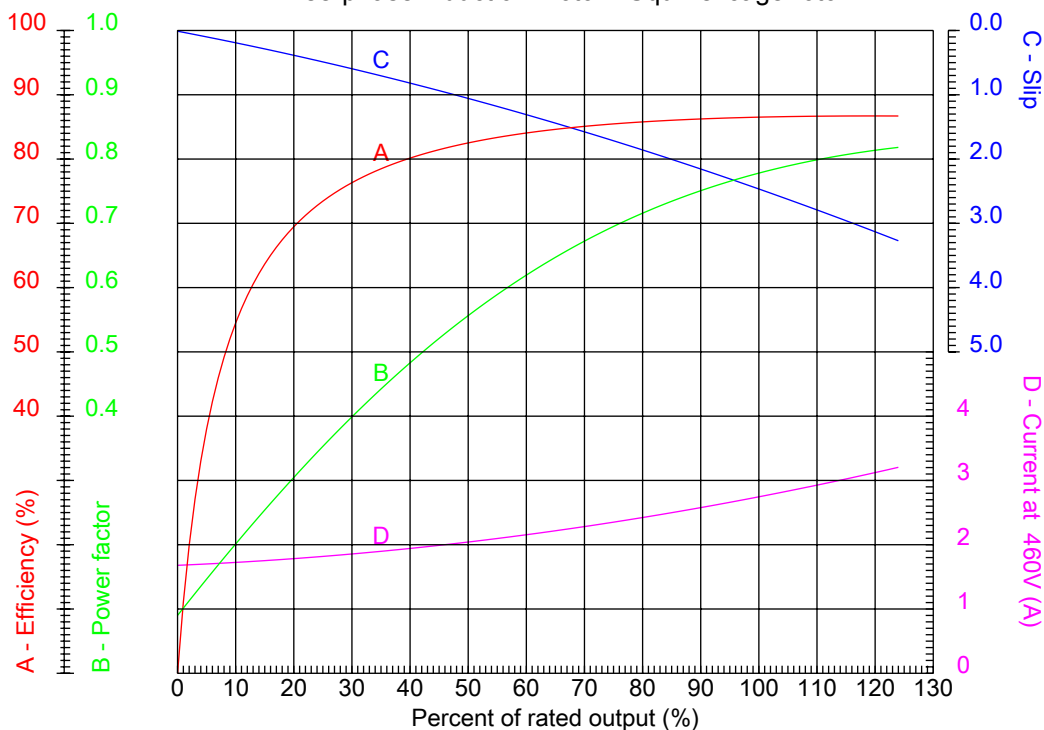

Customer :
 Product line : Three-Phase: W21 IE3 IEC Tru-Metric - TEFC (IP55) Multi-Mounting Aluminum Frame

Frame	: 90S/L	Locked rotor current (I _l /I _n)	: 8.3
Output	: 2 HP	Duty cycle	: S1
Frequency	: 60 Hz	Service factor	: 1.25
Full load speed	: 1755	Design	: N
Voltage	: 460 V	Locked rotor torque	: 300 %
Rated current	: 2.79 A	Breakdown torque	: 400 %
Insulation class	: F		

Notes:

Performed by

Checked



No.:

Date: 24-DEC-2012

CHARACTERISTIC CURVES RELATED TO SPEED Three-phase induction motor - Squirrel cage rotor

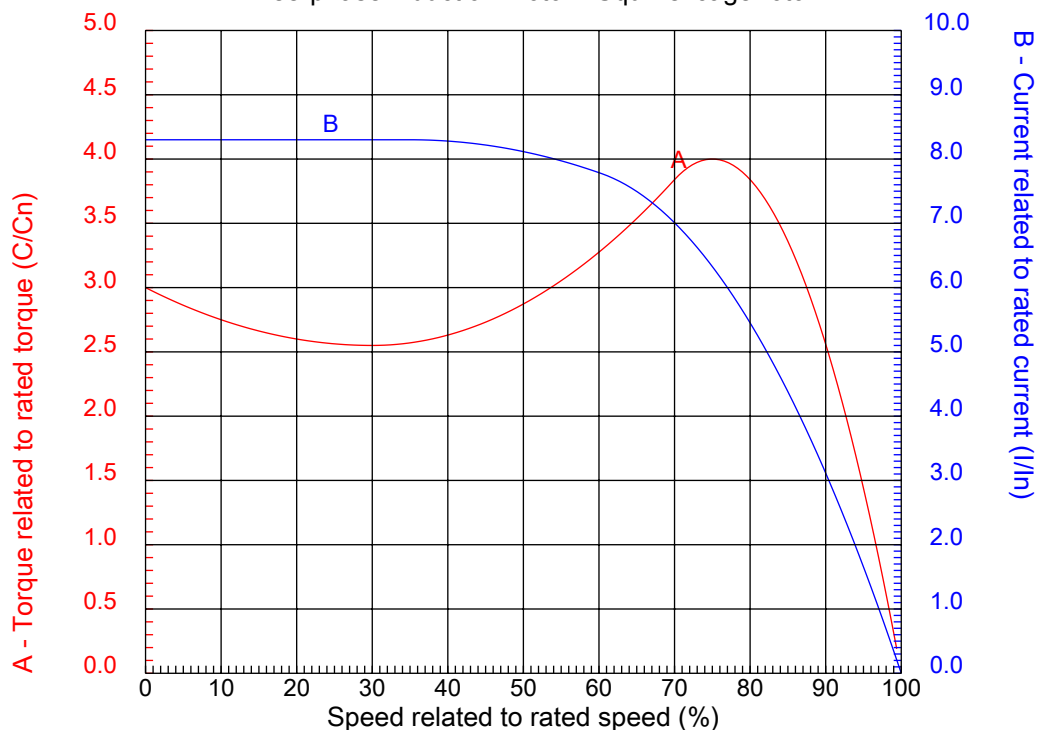

Customer :
Product line : Three-Phase: W21 IE3 IEC Tru-Metric - TEFC (IP55) Multi-Mounting Aluminum Frame

Frame	: 90S/L	Locked rotor current (I _l /I _n)	: 8.3
Output	: 2 HP	Duty cycle	: S1
Frequency	: 60 Hz	Service factor	: 1.25
Full load speed	: 1755	Design	: N
Voltage	: 460 V	Locked rotor torque	: 300 %
Rated current	: 2.79 A	Breakdown torque	: 400 %
Insulation class	: F		

Notes:

Performed by

Checked

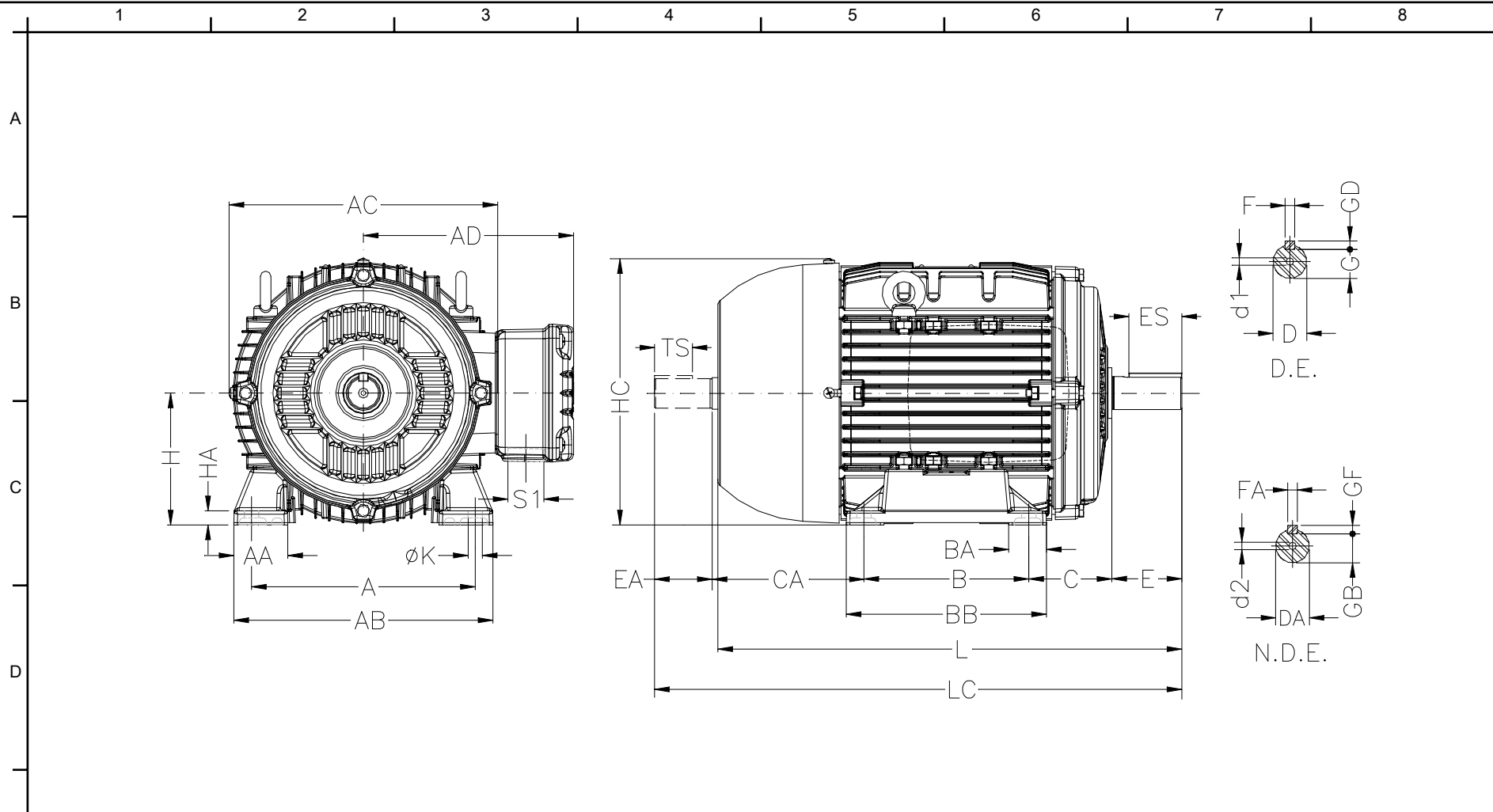

E	A 140	AA 35	AB 170	AC 179	AD 155	Notes:	
	B 100/125	BA 24	BB 146	C 56	CA 129/104		
F	D 24j6	E 50	ES 36	F 8	G 20	Performed by:	
	GD 7	DA 16j6	EA 40	TS 28	FA 5	Checked:	
	GB 13	GF 5	H 90	HA 9	HC 177	Customer:	
	HD 240	K 10	L 329	LC 375	S1 NPT 3/4"	Three-Phase: W21 IE3 IEC Tru-Metric - TEFC (IP55) Multi-Mounting Aluminum	
F	d1 DM8	d2 DM6	Flange FF-165	LA 10	M 165	Three-phase induction motor Frame 90S/L - IP55	
	N 130	P 200	T 3.5	S 12	Angle 45°		
	Holes 4					24-DEC-2012	