



No.:

Date: 24-DEC-2012

Customer :

TECHNICAL PROPOSAL

Three-phase induction motor - Squirrel cage rotor

Product line : Three-Phase: W21 IE3 IEC Tru-Metric - TEFC (IP55) Multi-Mounting Aluminum Frame

Catalog Number : 00418ET3YAL112M

List Price : \$679

Notes:

Performed by:

Checked:



No.:

Date: 24-DEC-2012

## DATA SHEET

### Three-phase induction motor - Squirrel cage rotor

Customer :  
Product line : Three-Phase: W21 IE3 IEC Tru-Metric - TEFC (IP55) Multi-Mounting Aluminum Frame

Frame : 112M  
Output : 5.5 HP  
Frequency : 60 Hz  
Poles : 4  
Full load speed : 1755  
Slip : 2.50 %  
Voltage : 460 V  
Rated current : 7.10 A  
Locked rotor current : 56.8 A  
Locked rotor current (I<sub>L</sub>/I<sub>n</sub>) : 8.0  
No-load current : 3.69 A  
Full load torque : 16.2 lb.ft  
Locked rotor torque : 250 %  
Breakdown torque : 350 %  
Design : N  
Insulation class : F  
Temperature rise : 80 K  
Locked rotor time : 19 s (hot)  
Service factor : 1.25  
Duty cycle : S1  
Ambient temperature : -20°C - +40°C  
Altitude : 1000  
Degree of Protection : IP55  
Approximate weight : 84 lb  
Moment of inertia : 0.43117 sq.ft.lb  
Noise level : 56 dB(A)

	D.E.	N.D.E.	Load	Power factor	Efficiency (%)
Bearings	6307 ZZ	6206 ZZ	100%	0.79	89.5
Regreasing interval	---	---	75%	0.72	89.5
Grease amount	---	---	50%	0.60	87.5

Notes:

Performed by

Checked



No.:

Date: 24-DEC-2012

PERFORMANCE CURVES RELATED TO RATED OUTPUT  
Three-phase induction motor - Squirrel cage rotor

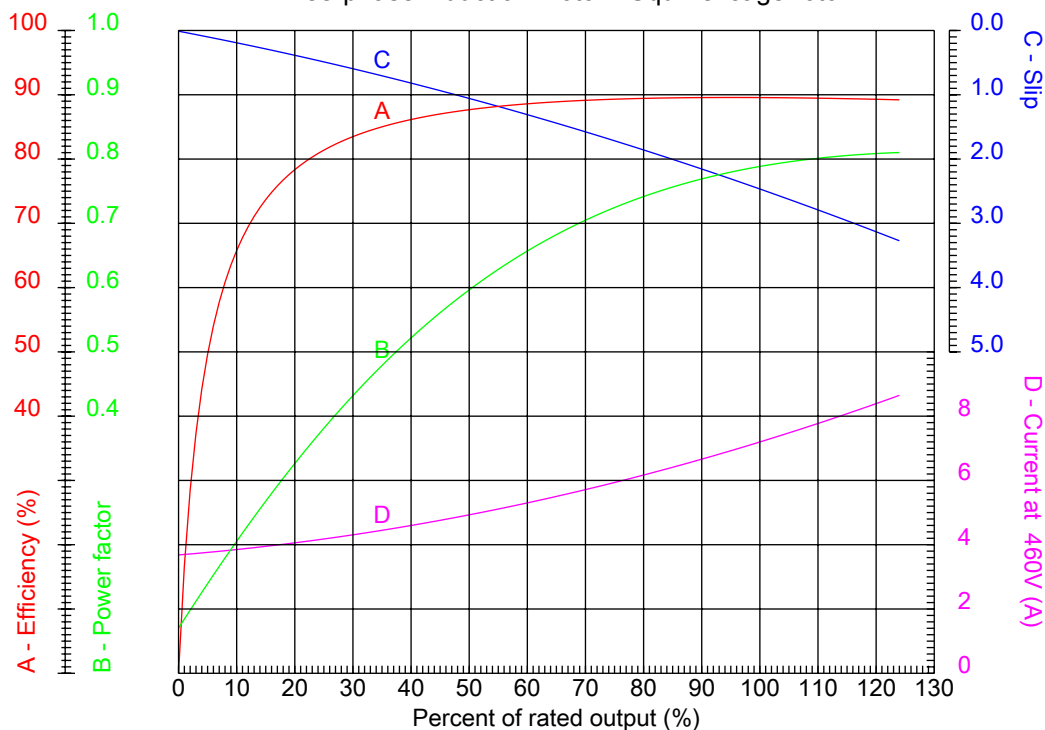

Customer :  
Product line : Three-Phase: W21 IE3 IEC Tru-Metric - TEFC (IP55) Multi-Mounting Aluminum Frame

Frame	: 112M	Locked rotor current (I <sub>l</sub> /I <sub>n</sub> )	: 8.0
Output	: 5.5 HP	Duty cycle	: S1
Frequency	: 60 Hz	Service factor	: 1.25
Full load speed	: 1755	Design	: N
Voltage	: 460 V	Locked rotor torque	: 250 %
Rated current	: 7.10 A	Breakdown torque	: 350 %
Insulation class	: F		

Notes:

Performed by

Checked



No.:

Date: 24-DEC-2012

### CHARACTERISTIC CURVES RELATED TO SPEED Three-phase induction motor - Squirrel cage rotor

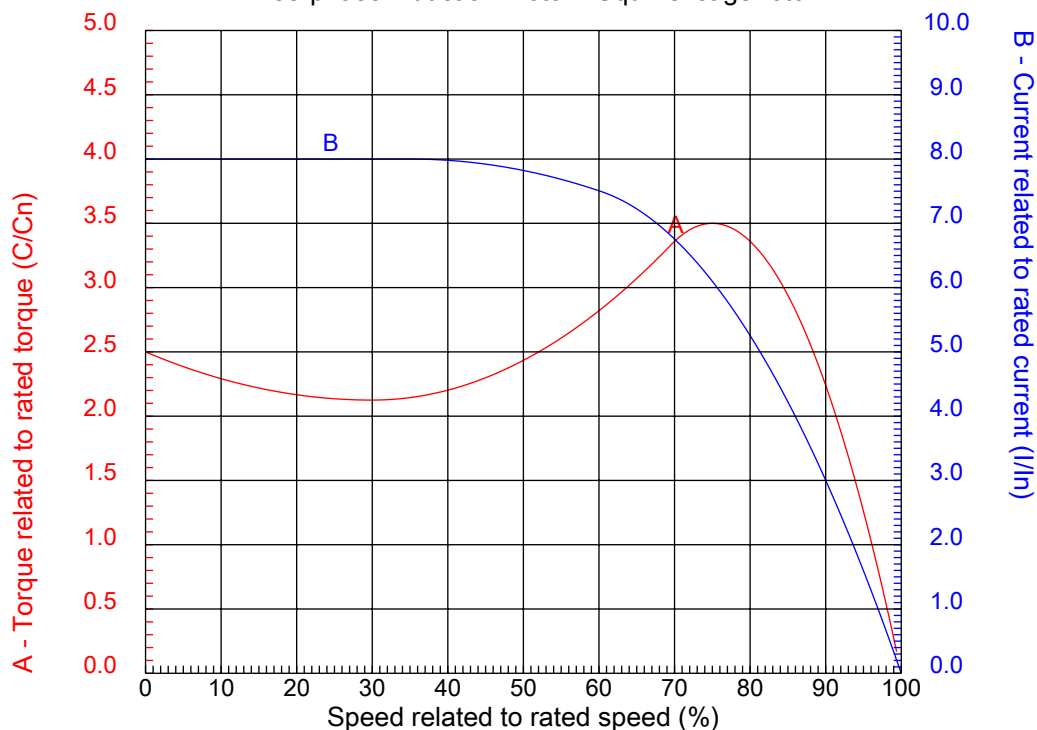

Customer :  
Product line : Three-Phase: W21 IE3 IEC Tru-Metric - TEFC (IP55) Multi-Mounting Aluminum Frame

Frame	: 112M	Locked rotor current (I <sub>l</sub> /I <sub>n</sub> )	: 8.0
Output	: 5.5 HP	Duty cycle	: S1
Frequency	: 60 Hz	Service factor	: 1.25
Full load speed	: 1755	Design	: N
Voltage	: 460 V	Locked rotor torque	: 250 %
Rated current	: 7.10 A	Breakdown torque	: 350 %
Insulation class	: F		

Notes:

Performed by

Checked

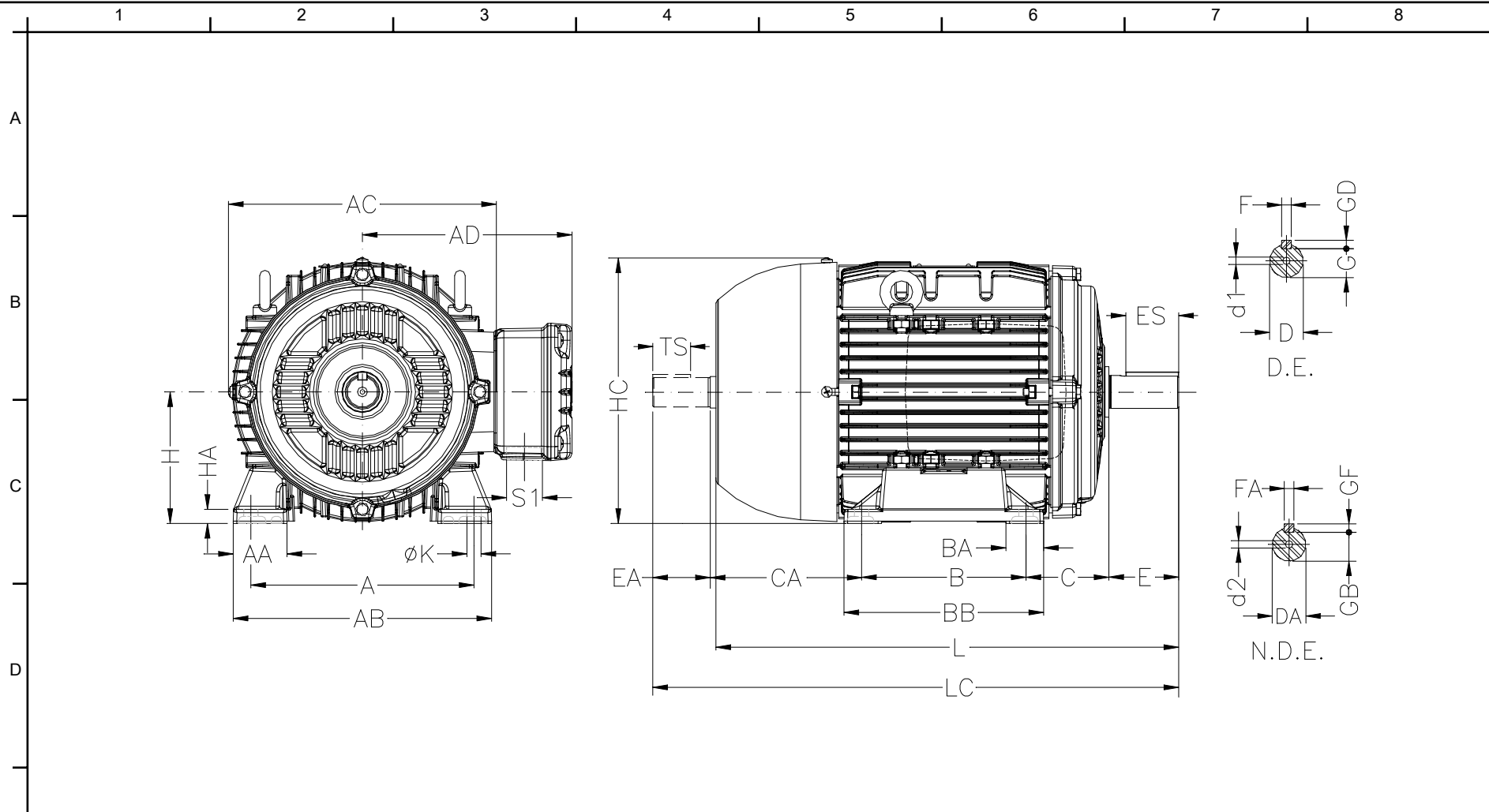

E	A	AA	AB	AC	AD	Notes:
	190	46	220	223	184	
F	B	BA	BB	C	CA	Performed by:
	140	32	170	70	128	
F	D	E	ES	F	G	Checked:
	28j6	60	45	8	24	
F	GD	DA	EA	TS	FA	Customer:
	7	24j6	50	36	8	
F	GB	GF	H	HA	HC	Three-Phase: W21 IE3 IEC Tru-Metric - TEFC (IP55) Multi-Mounting Aluminum
	20	7	112	12	235	
F	HD	K	L	LC	S1	Three-phase induction motor
	312	12	393	448	NPT 1"	
F	d1	d2	Flange	LA	M	Frame 112M - IP55
	DM10	DM8	FF-215	11	215	
F	N	P	T	S	Angle	24-DEC-2012
	180	250	4	15	45°	
F	Holes					
	4					