



No.:

Date: 24-DEC-2012

Customer :

TECHNICAL PROPOSAL

Three-phase induction motor - Squirrel cage rotor

Product line : Three-Phase: W21 IE3 IEC Tru-Metric - TEFC (IP55) Multi-Mounting Aluminum Frame

Catalog Number : 00718ET3YAL132M

List Price : \$1,110

Notes:

Performed by:

Checked:



No.:

Date: 24-DEC-2012

## DATA SHEET

### Three-phase induction motor - Squirrel cage rotor

Customer :  
Product line : Three-Phase: W21 IE3 IEC Tru-Metric - TEFC (IP55) Multi-Mounting Aluminum Frame

Frame : 132M  
Output : 10 HP  
Frequency : 60 Hz  
Poles : 4  
Full load speed : 1770  
Slip : 1.67 %  
Voltage : 460 V  
Rated current : 12.2 A  
Locked rotor current : 110 A  
Locked rotor current (I<sub>L</sub>/I<sub>n</sub>) : 9.0  
No-load current : 5.70 A  
Full load torque : 29.3 lb.ft  
Locked rotor torque : 270 %  
Breakdown torque : 430 %  
Design : N  
Insulation class : F  
Temperature rise : 80 K  
Locked rotor time : 16 s (hot)  
Service factor : 1.25  
Duty cycle : S1  
Ambient temperature : -20°C - +40°C  
Altitude : 1000  
Degree of Protection : IP55  
Approximate weight : 154 lb  
Moment of inertia : 1.5235 sq.ft.lb  
Noise level : 56 dB(A)

	D.E.	N.D.E.	Load	Power factor	Efficiency (%)
Bearings	6308 ZZ	6207 ZZ	100%	0.84	91.7
Regreasing interval	---	---	75%	0.78	91.0
Grease amount	---	---	50%	0.66	90.2

Notes:

Performed by

Checked



No.:

Date: 24-DEC-2012

### PERFORMANCE CURVES RELATED TO RATED OUTPUT Three-phase induction motor - Squirrel cage rotor

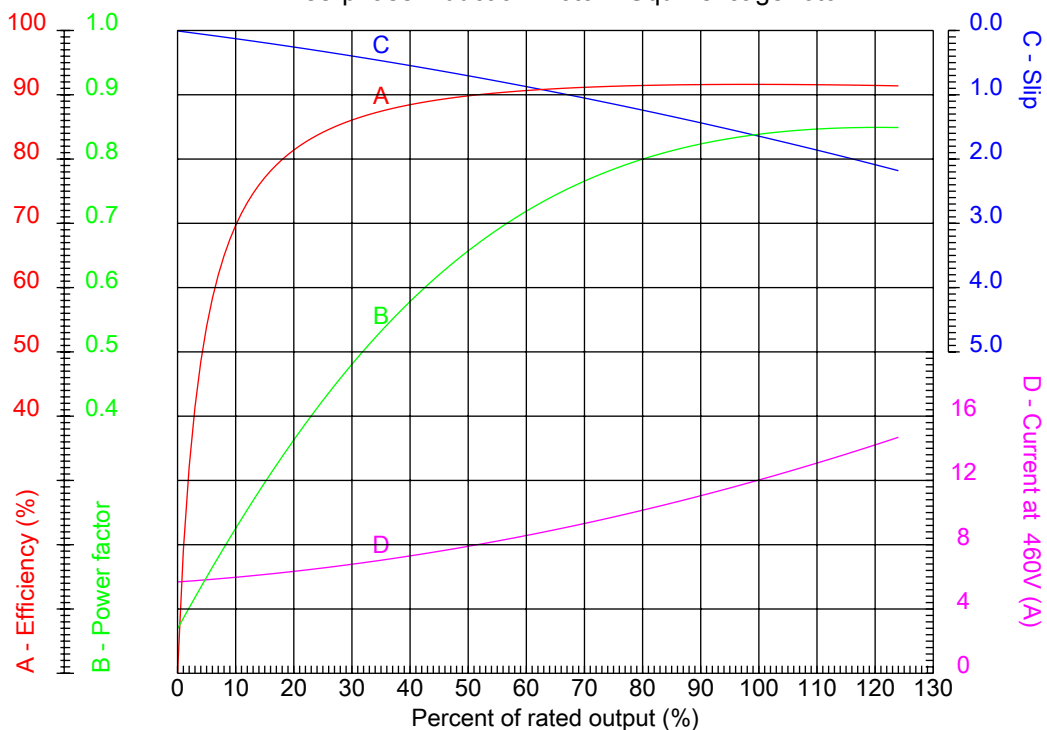

Customer :  
Product line : Three-Phase: W21 IE3 IEC Tru-Metric - TEFC (IP55) Multi-Mounting Aluminum Frame

Frame : 132M	Locked rotor current (I <sub>l</sub> /I <sub>n</sub> ) : 9.0
Output : 10 HP	Duty cycle : S1
Frequency : 60 Hz	Service factor : 1.25
Full load speed : 1770	Design : N
Voltage : 460 V	Locked rotor torque : 270 %
Rated current : 12.2 A	Breakdown torque : 430 %
Insulation class : F	

Notes:

Performed by

Checked



No.:

Date: 24-DEC-2012

### CHARACTERISTIC CURVES RELATED TO SPEED Three-phase induction motor - Squirrel cage rotor

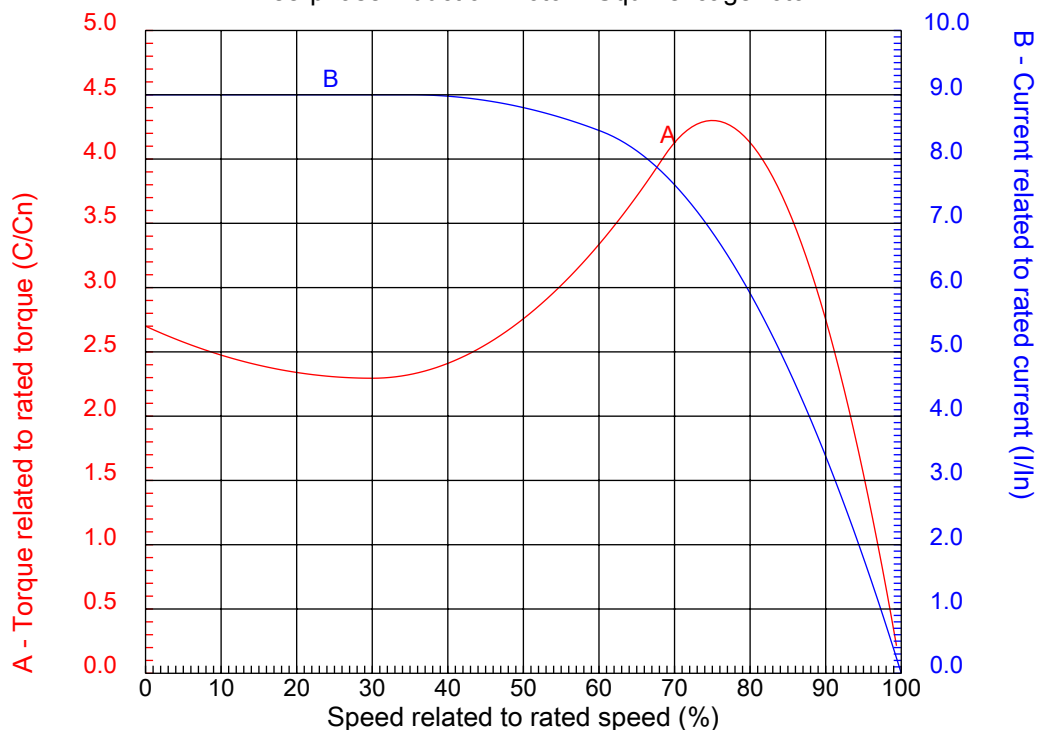

Customer :  
Product line : Three-Phase: W21 IE3 IEC Tru-Metric - TEFC (IP55) Multi-Mounting Aluminum Frame

Frame	: 132M	Locked rotor current (I <sub>l</sub> /I <sub>n</sub> )	: 9.0
Output	: 10 HP	Duty cycle	: S1
Frequency	: 60 Hz	Service factor	: 1.25
Full load speed	: 1770	Design	: N
Voltage	: 460 V	Locked rotor torque	: 270 %
Rated current	: 12.2 A	Breakdown torque	: 430 %
Insulation class	: F		

Notes:

Performed by

Checked

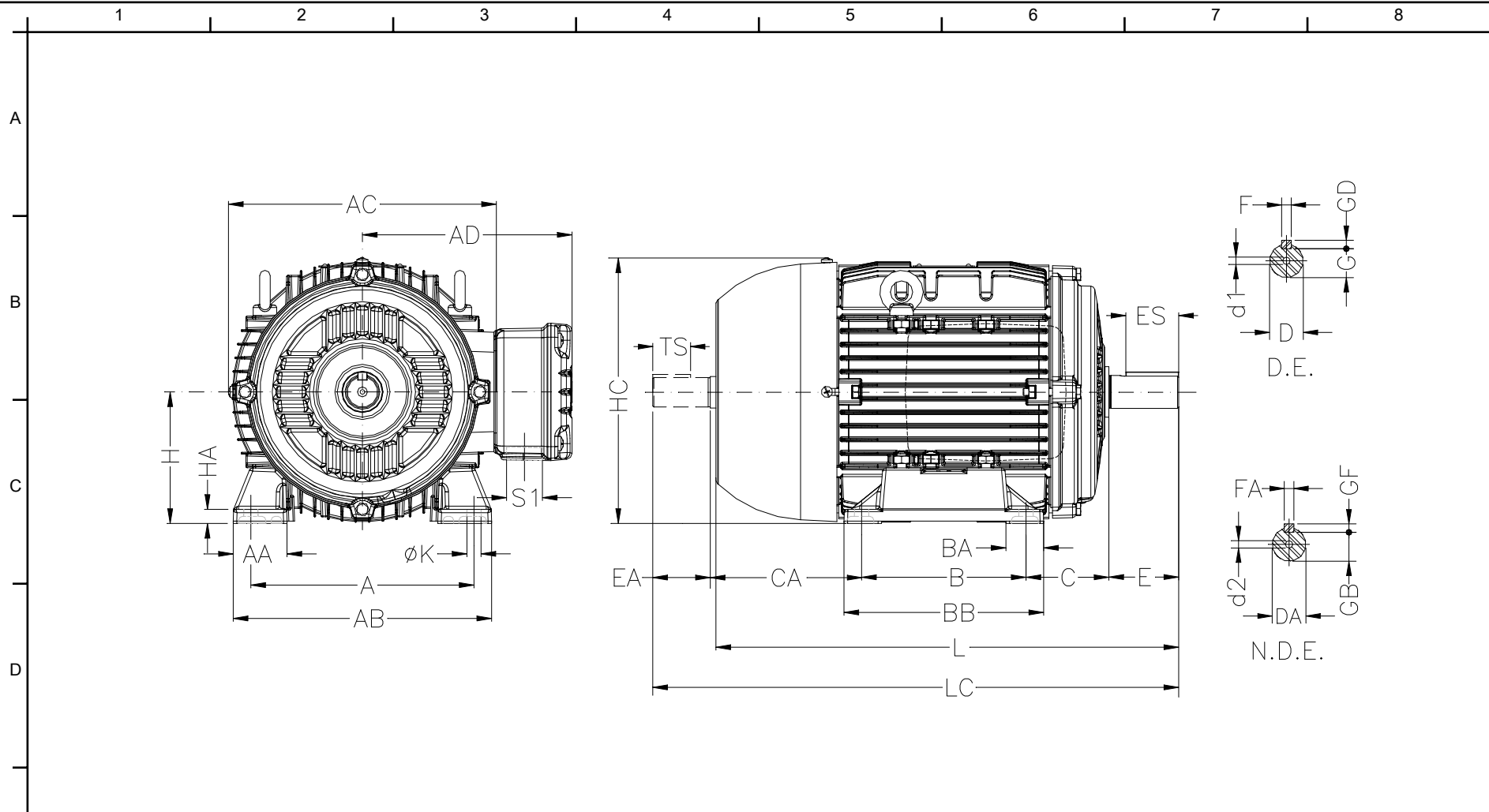

	A 216	AA 44	AB 248	AC 270	AD 212	Notes:
E	B 178	BA 37	BB 210	C 89	CA 150	
	D 38j6	E 80	ES 63	F 10	G 33	Performed by:
	GD 8	DA 28j6	EA 60	TS 45	FA 8	Checked:
	GB 24	GF 7	H 132	HA 12	HC 274	Customer:
	HD 360	K 12	L 490	LC 557	S1 NPT 1"	Three-Phase: W21 IE3 IEC Tru-Metric - TEFC (IP55) Multi-Mounting Aluminum
F	d1 DM12	d2 DM10	Flange FF-265	LA 12	M 265	
	N 230	P 300	T 4	S 15	Angle 45°	Three-phase induction motor
	Holes 4					Frame 132M - IP55
						24-DEC-2012