



No.:

Date: 31-DEC-2012

Customer :

TECHNICAL PROPOSAL

Three-phase induction motor - Squirrel cage rotor

Product line : Cooling Tower Motors : High Efficiency - Two Speed

Catalog Number : 00389EP3QCT182V

List Price : \$1,369

Notes:

Performed by:

Checked:



No.:

Date: 31-DEC-2012

## DATA SHEET

### Three-phase induction motor - Squirrel cage rotor

Customer :  
Product line : Cooling Tower Motors : High Efficiency - Two Speed

Frame : 182T  
Output : 0.75 HP  
Frequency : 60 Hz  
Poles : 8  
Full load speed : 875  
Slip : 2.78 %  
Voltage : 460 V  
Rated current : 1.74 A  
Locked rotor current : 5.74 A  
Locked rotor current (I<sub>L</sub>/I<sub>n</sub>) : 3.3  
No-load current : 1.50 A  
Full load torque : 4.44 lb.ft  
Locked rotor torque : 140 %  
Breakdown torque : 220 %  
Design : A  
Insulation class : F  
Temperature rise : 80 K  
Locked rotor time : 45 s (hot)  
Service factor : 1.15  
Duty cycle : S1  
Ambient temperature : -20°C - +40°C  
Altitude : 1000  
Degree of Protection : IP55  
Approximate weight : 97 lb  
Moment of inertia : 0.38205 sq.ft.lb  
Noise level : 50 dB(A)

	D.E.	N.D.E.	Load	Power factor	Efficiency (%)
Bearings	6307 2RS	6206 2RS	100%	0.55	72.0
Regreasing interval	---	---	75%	0.48	72.0
Grease amount	---	---	50%	0.40	65.0

Notes:

Performed by

Checked



No.:

Date: 31-DEC-2012

### PERFORMANCE CURVES RELATED TO RATED OUTPUT

Three-phase induction motor - Squirrel cage rotor

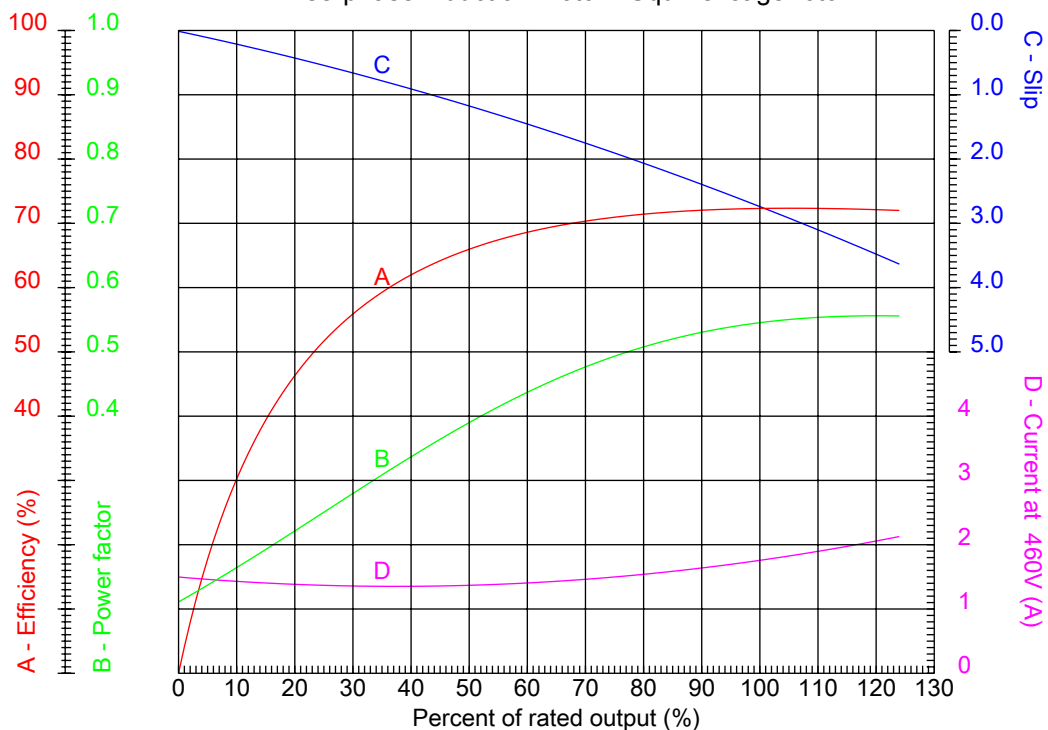

Customer :  
Product line : Cooling Tower Motors : High Efficiency - Two Speed

Frame	: 182T	Locked rotor current (I <sub>l</sub> /I <sub>n</sub> )	: 3.3
Output	: 0.75 HP	Duty cycle	: S1
Frequency	: 60 Hz	Service factor	: 1.15
Full load speed	: 875	Design	: A
Voltage	: 460 V	Locked rotor torque	: 140 %
Rated current	: 1.74 A	Breakdown torque	: 220 %
Insulation class	: F		

Notes:

Performed by

Checked



No.:

Date: 31-DEC-2012

### CHARACTERISTIC CURVES RELATED TO SPEED

Three-phase induction motor - Squirrel cage rotor

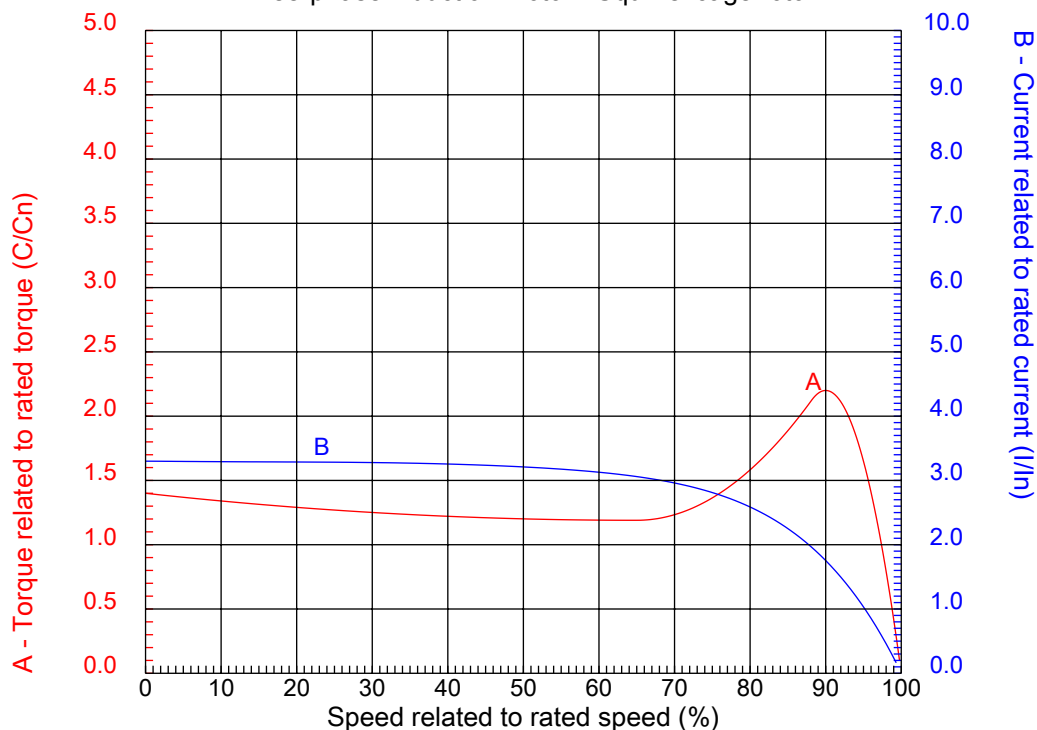

Customer :  
Product line : Cooling Tower Motors : High Efficiency - Two Speed

Frame	: 182T	Locked rotor current (Ih/Ih)	: 3.3
Output	: 0.75 HP	Duty cycle	: S1
Frequency	: 60 Hz	Service factor	: 1.15
Full load speed	: 875	Design	: A
Voltage	: 460 V	Locked rotor torque	: 140 %
Rated current	: 1.74 A	Breakdown torque	: 220 %
Insulation class	: F		

Notes:

Performed by

Checked

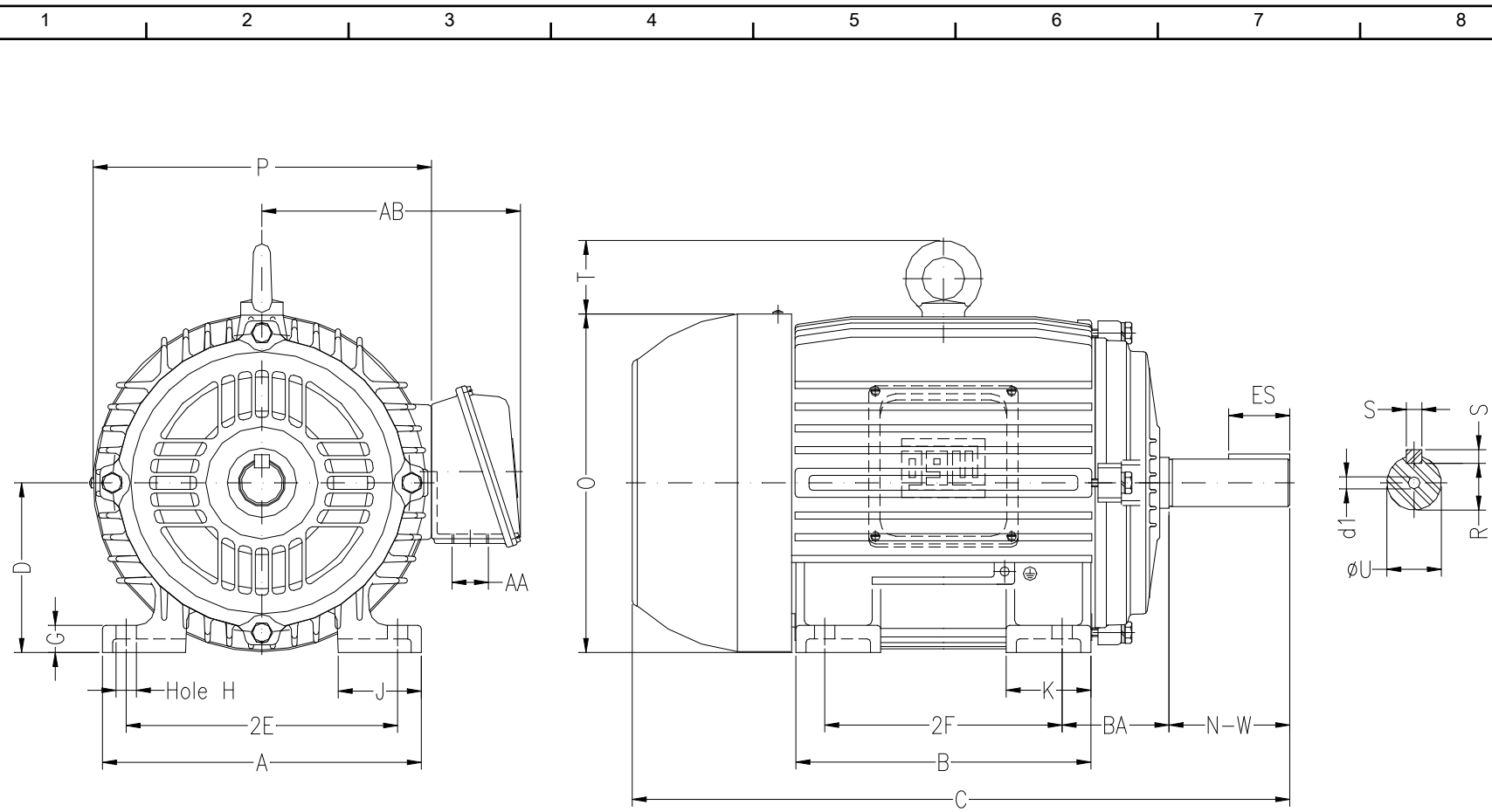

Notes:

Performed by:

Checked:

Customer:

Cooling Tower Motors : High Efficiency - Two Speed

	2E 7.500	2F 4.500	H 0.406	BA 2.750	A 8.661
	B 5.945	C 14.860	D 4.500	G 0.720	J 1.890
	K 1.969	O 9.343	P 8.740	ES 1.969	S 0.250
F	N-W 2.750	U 1.125	R 0.984	AB 7.086	AA NPT 1"
	d1 A 4	Flange FD-254	AJ 10.000	AK 9.000	BD 11.000
	BF 0.562	BB 0.203			

Three-phase induction motor  
Frame 182T - IP55

31-DEC-2012

