



No.:

Date: 31-DEC-2012

Customer :

TECHNICAL PROPOSAL

Three-phase induction motor - Squirrel cage rotor

Product line : Cooling Tower Motors : High Efficiency - Two Speed

Catalog Number : 00789EP3QCT254V2

List Price : \$2,808

Notes:

Performed by:

Checked:



No.:

Date: 31-DEC-2012

DATA SHEET

Three-phase induction motor - Squirrel cage rotor

Customer :
Product line : Cooling Tower Motors : High Efficiency - Two Speed

Frame : 254T
Output : 1.75 HP
Frequency : 60 Hz
Poles : 8
Full load speed : 885
Slip : 1.67 %
Voltage : 230 V
Rated current : 9.19 A
Locked rotor current : 34.0 A
Locked rotor current (I_L/I_n) : 3.7
No-load current : 8.00 A
Full load torque : 10.2 lb.ft
Locked rotor torque : 220 %
Breakdown torque : 280 %
Design : A
Insulation class : F
Temperature rise : 80 K
Locked rotor time : 24 s (hot)
Service factor : 1.15
Duty cycle : S1
Ambient temperature : -20°C - +40°C
Altitude : 1000
Degree of Protection : IP55
Approximate weight : 265 lb
Moment of inertia : 2.6198 sq.ft.lb
Noise level : 54 dB(A)

	D.E.	N.D.E.	Load	Power factor	Efficiency (%)
Bearings	6309 2RS	6209 2RS	100%	0.48	74.0
Regreasing interval	---	---	75%	0.40	75.0
Grease amount	---	---	50%	0.32	66.0

Notes:

Performed by

Checked



No.:

Date: 31-DEC-2012

PERFORMANCE CURVES RELATED TO RATED OUTPUT

Three-phase induction motor - Squirrel cage rotor

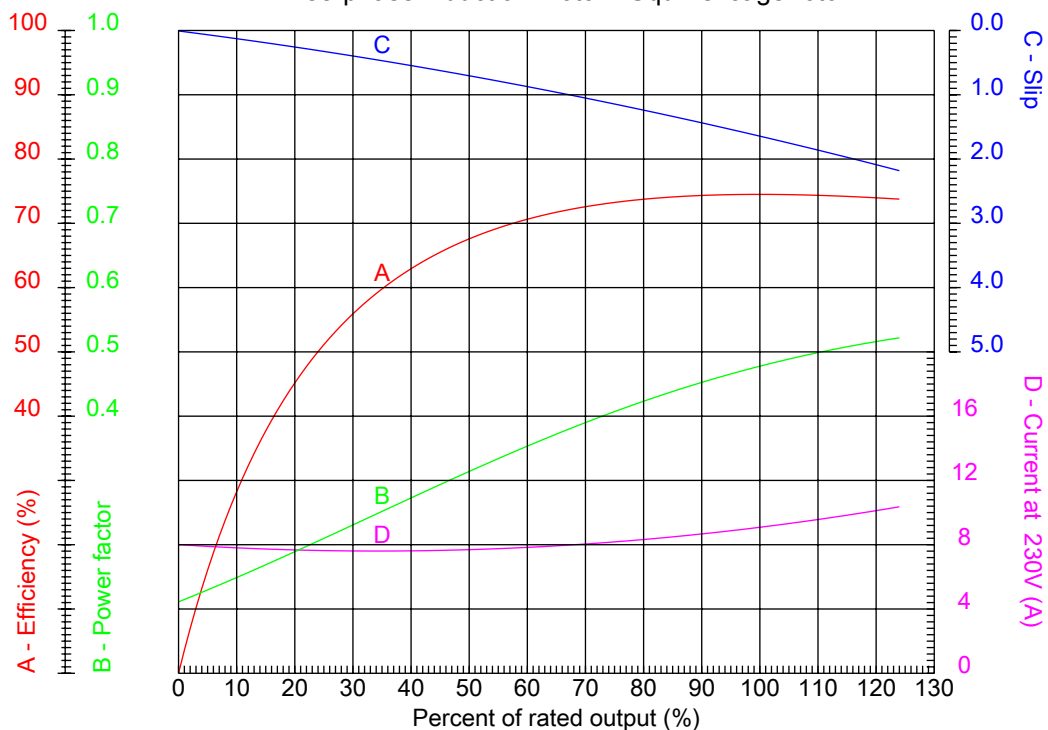

Customer :
Product line : Cooling Tower Motors : High Efficiency - Two Speed

Frame	: 254T	Locked rotor current (I _l /I _n)	: 3.7
Output	: 1.75 HP	Duty cycle	: S1
Frequency	: 60 Hz	Service factor	: 1.15
Full load speed	: 885	Design	: A
Voltage	: 230 V	Locked rotor torque	: 220 %
Rated current	: 9.19 A	Breakdown torque	: 280 %
Insulation class	: F		

Notes:

Performed by

Checked



No.:

Date: 31-DEC-2012

CHARACTERISTIC CURVES RELATED TO SPEED

Three-phase induction motor - Squirrel cage rotor

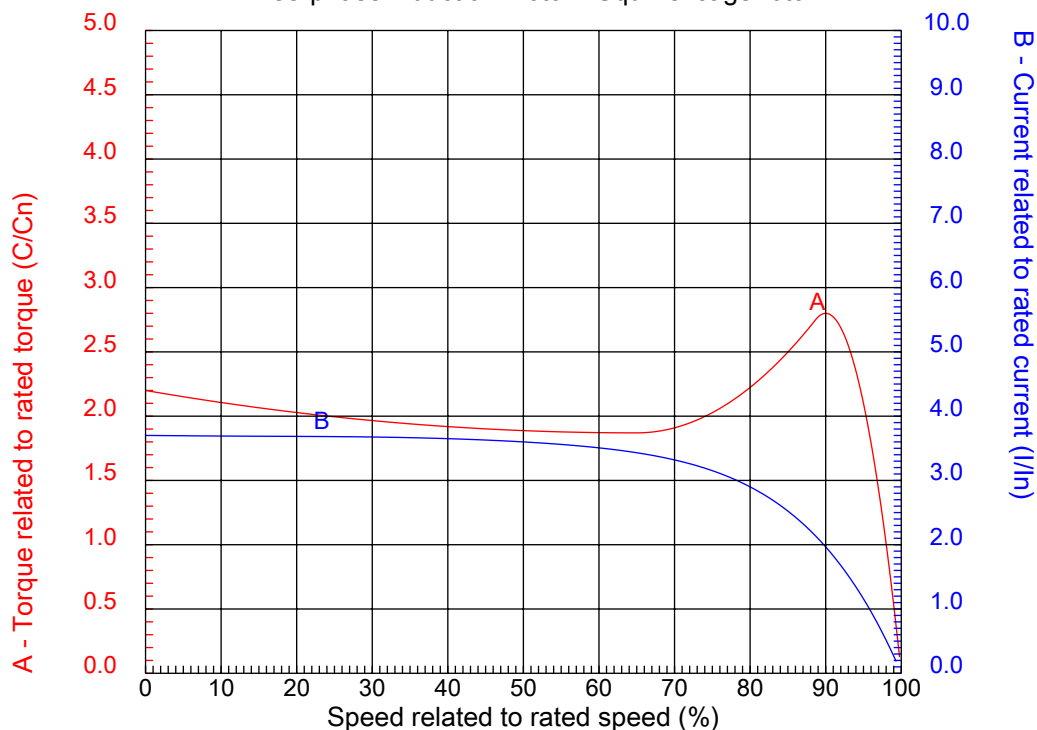

Customer :
Product line : Cooling Tower Motors : High Efficiency - Two Speed

Frame	: 254T	Locked rotor current (I _l /I _n)	: 3.7
Output	: 1.75 HP	Duty cycle	: S1
Frequency	: 60 Hz	Service factor	: 1.15
Full load speed	: 885	Design	: A
Voltage	: 230 V	Locked rotor torque	: 220 %
Rated current	: 9.19 A	Breakdown torque	: 280 %
Insulation class	: F		

Notes:

Performed by

Checked

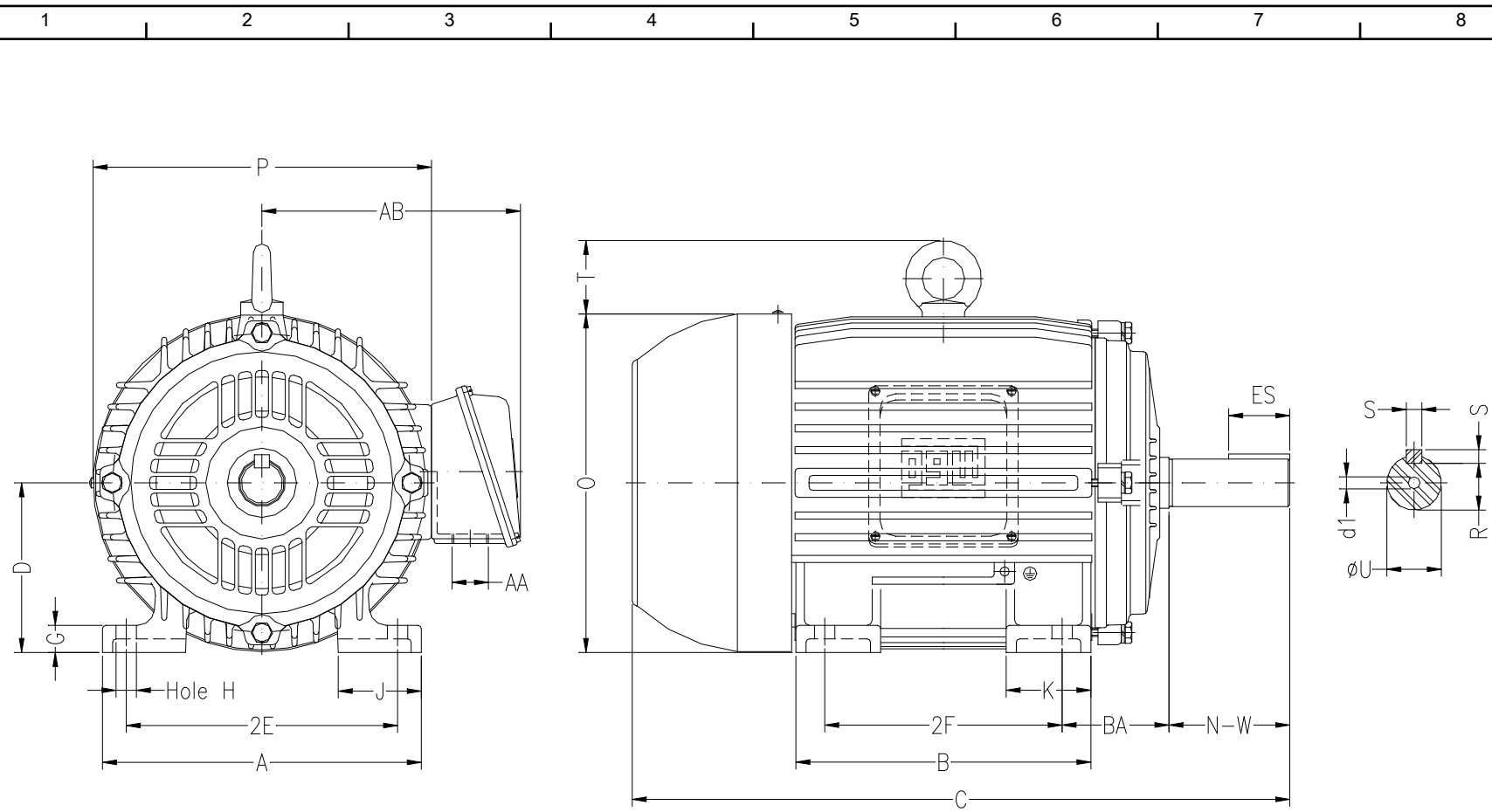

Notes:

Performed by:

Checked:

Customer:

Cooling Tower Motors : High Efficiency - Two Speed

Three-phase induction motor
Frame 254T - IP55

31-DEC-2012



2E 10.000	2F 8.252	H 0.531	BA 4.250	A 12.126
B 10.000	C 23.213	D 6.250	G 0.817	J 2.520
K 2.559	O 12.431	P 12.283	ES 2.756	S 0.375
N-W 4.000	U 1.625	R 1.406	AB 10.079	AA NPT 1 1/2"
d1 A 4	Flange FD-317	AJ 12.500	AK 11.000	BD 14.000
BF 0.828	BB 0.203			