



No.:

Date: 17-DEC-2012

Customer :

TECHNICAL PROPOSAL

Three-phase induction motor - Squirrel cage rotor

Product line : Three-Phase : Rolled Steel Motor - NEMA Premium Efficiency

Catalog Number : 00156ET3ERS143T

List Price : \$473

Notes:

Performed by:

Checked:



No.:

Date: 17-DEC-2012

DATA SHEET

Three-phase induction motor - Squirrel cage rotor

Customer :
 Product line : Three-Phase : Rolled Steel Motor - NEMA Premium Efficiency

Frame : 143/5T
 Output : 1.5 HP
 Frequency : 60 Hz
 Poles : 2
 Full load speed : 3420
 Slip : 5.00 %
 Voltage : 208-230/460 V
 Rated current : 4.30-3.90/1.95 A
 Locked rotor current : 33.2/16.6 A
 Locked rotor current (I_L/I_n) : 8.5
 No-load current : 1.70/0.850 A
 Full load torque : 2.27 lb.ft
 Locked rotor torque : 420 %
 Breakdown torque : 390 %
 Design : B
 Insulation class : F
 Temperature rise : 80 K
 Locked rotor time : 15 s (hot)
 Service factor : 1.15 (1.00 at 208V)
 Duty cycle : S1
 Ambient temperature : -20°C - +40°C
 Altitude : 1000
 Degree of Protection : IP55
 Approximate weight : 34 lb
 Moment of inertia : 0.05102 sq.ft.lb
 Noise level : ---

	D.E.	N.D.E.	Load	Power factor	Efficiency (%)
Bearings	6205 ZZ	6203 ZZ	100%	0.86	84.0
Regreasing interval	---	---	75%	0.81	81.5
Grease amount	---	---	50%	0.71	77.0

Notes:

Performed by

Checked



No.:

Date: 17-DEC-2012

PERFORMANCE CURVES RELATED TO RATED OUTPUT
Three-phase induction motor - Squirrel cage rotor

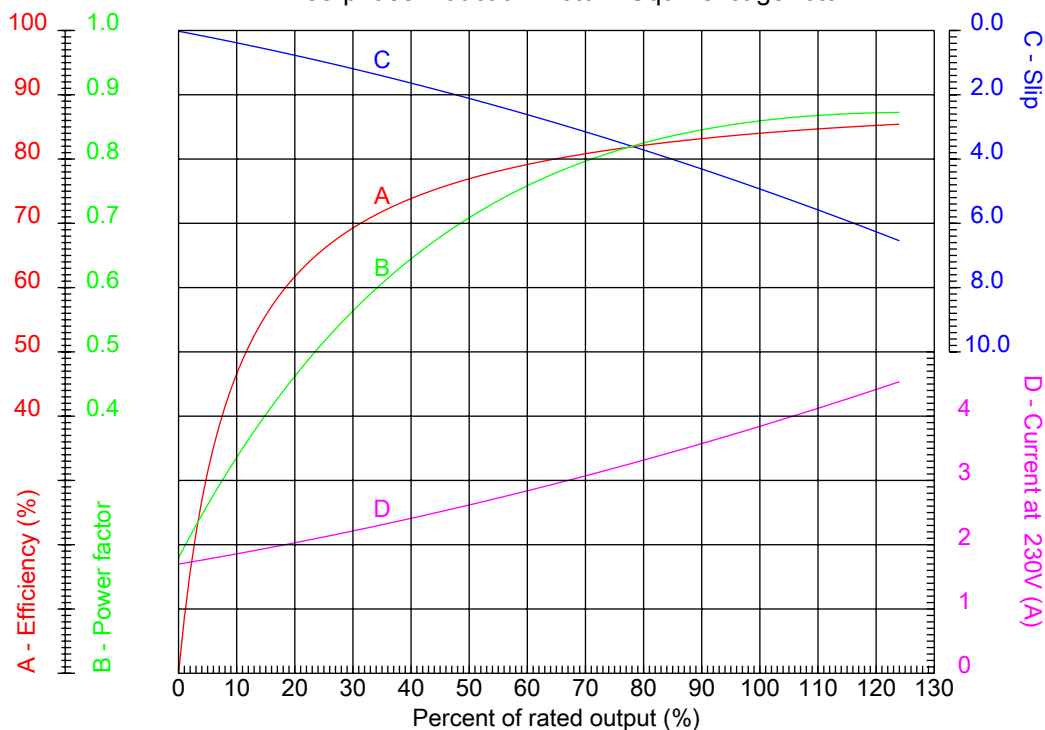

Customer :
Product line : Three-Phase : Rolled Steel Motor - NEMA Premium Efficiency

Frame	: 143/5T	Locked rotor current (I _l /I _n)	: 8.5
Output	: 1.5 HP	Duty cycle	: S1
Frequency	: 60 Hz	Service factor	: 1.15 (1.00 at 208V)
Full load speed	: 3420	Design	: B
Voltage	: 208-230/460 V	Locked rotor torque	: 420 %
Rated current	: 4.30-3.90/1.95 A	Breakdown torque	: 390 %
Insulation class	: F		

Notes:

Performed by

Checked



No.:

Date: 17-DEC-2012

CHARACTERISTIC CURVES RELATED TO SPEED

Three-phase induction motor - Squirrel cage rotor

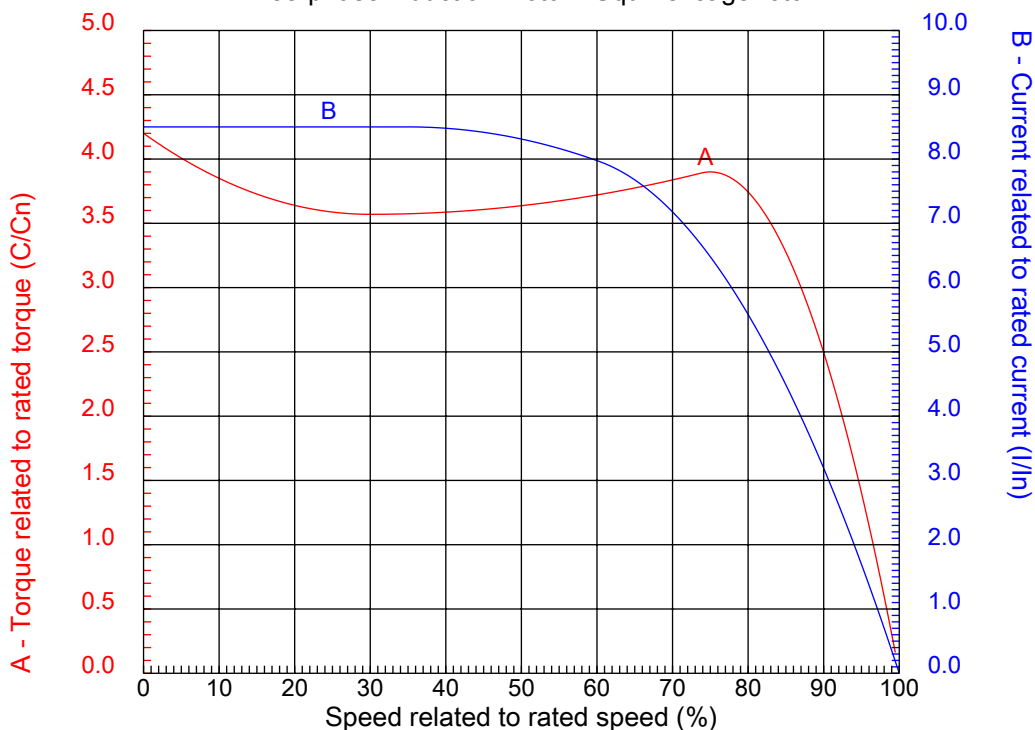

Customer :
Product line : Three-Phase : Rolled Steel Motor - NEMA Premium Efficiency

Frame	: 143/5T	Locked rotor current (I _l /I _n)	: 8.5
Output	: 1.5 HP	Duty cycle	: S1
Frequency	: 60 Hz	Service factor	: 1.15 (1.00 at 208V)
Full load speed	: 3420	Design	: B
Voltage	: 208-230/460 V	Locked rotor torque	: 420 %
Rated current	: 4.30-3.90/1.95 A	Breakdown torque	: 390 %
Insulation class	: F		

Notes:

Performed by

Checked

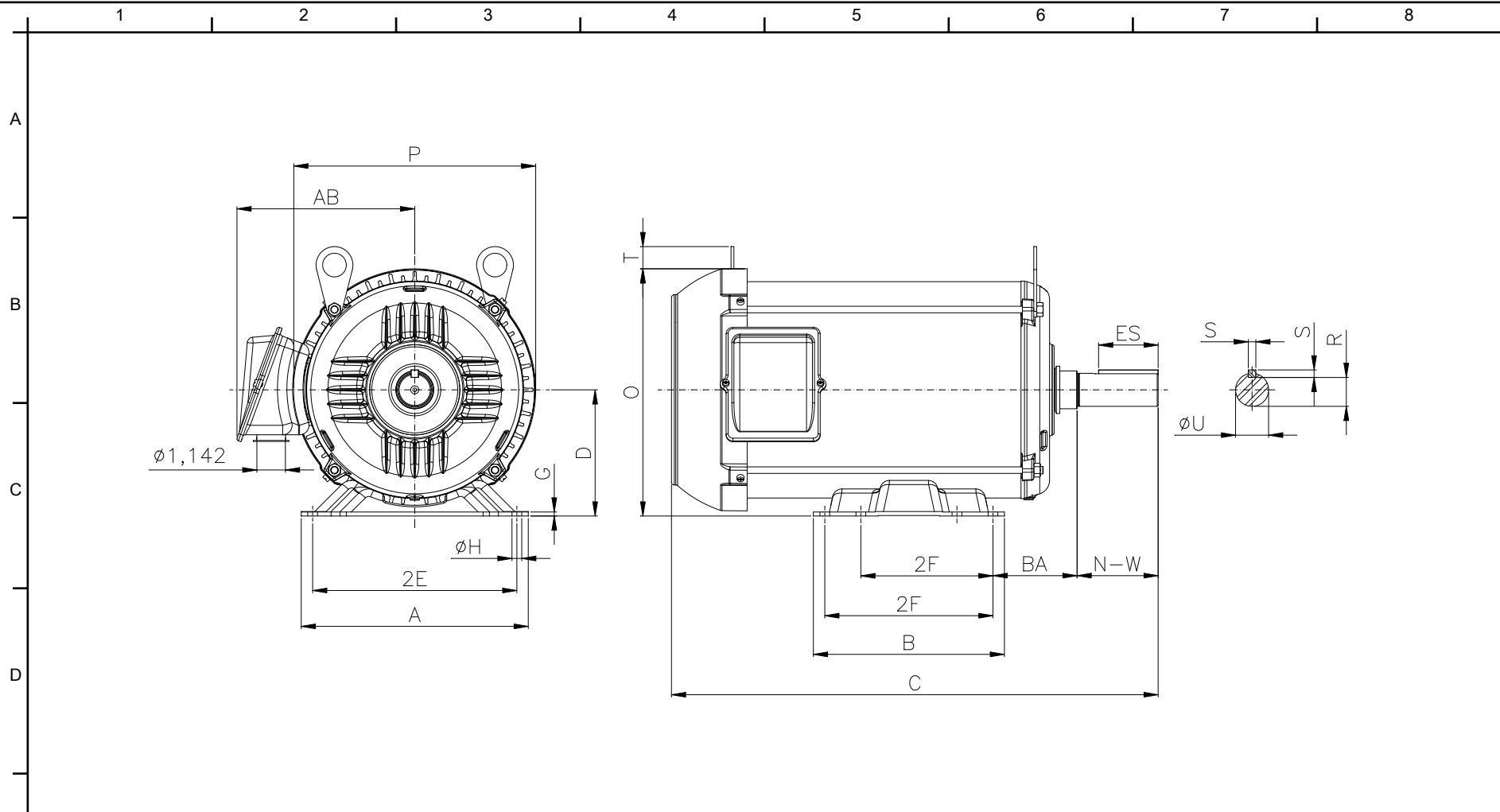

Notes:

Performed by:

Checked:

Customer:

Three-Phase : Rolled Steel Motor - NEMA Premium Efficiency

Three-phase induction motor
Frame 143/5T - IP55

17-DEC-2012



2E	A	P	AB	2F
5.500	6.535	7.323	5.945	4.016
B	BA	U	N-W	ES
6.496	2.250	0.8750	2.250	1.417
S	R	depth	D	O
0.187	0.766	0.187	3.500	7.165
T	H	C	FC	d1
1.063	0.343	14.095	7.874	A 4
d2	Flange	AJ	AK	BD
DM6	FC-149	5.874	4.500	6.535
BF	BB	BC	AH	
UNC 3/8"x16	0.157	---		