

Catalog Number	
Notes	Type

FEATURES & SPECIFICATIONS

INTENDED USE

Ideal for a wide variety of low- to medium-height ceiling applications including commercial, retail and hospitality spaces where a wet location lensed fixture is required. Ideal for shower and outdoor applications.

CONSTRUCTION

Utilizes an extruded socket housing that attaches to the reflector via key hole mount, which provides superior heat dissipation and extended lamp life. Socket housing also adjusts to accommodate varying lamp lengths.

Heavy-gauge, die-formed galvanized steel mounting frame. Attached to frame are vertically adjustable mounting brackets for use with C channels, ½" steel conduit or 16-gauge flat bar hangers included, standard. Frames are equipped with galvanized junction box UL Listed for through-wire applications. Junction boxes equipped with (2) ¾" and (4) ½" conduit knockouts with pryout slots and removable access doors. Reflector clips packed with reflector for installation on rough-in.

Maximum 1-1/2" ceiling thickness.

OPTICS

Aluminum clear semi-specular upper reflectors are optically designed to maximize lumen output and to provide superior glare control.

Glass lenses are available in clear flat glass, tempered prismatic or fresnel glass lens to provide optimal visual comfort and improved aesthetics.

ELECTRICAL

Electronic ballast with end of lamp life protection standard. Class P thermally protected ballast protects against improper contact with insulation. Minimum starting temperature is 0°F/-18°C.

Rated for #12 AWG conductor thru-branch wiring. Minimum 90° supply wire. Ground wire provided.

Lamp Socket Base:

DTT 4-pin lamps – 13W (G24Q-1); 18W (G24Q-2); 26W (G24Q-3)

TRT 4-pin lamps – 13W (GX24Q-1); 18W (GX24Q-2); 26W & 32W (GX24Q-3); 42W (GX24Q-4)

LISTINGS

Fixtures are UL Listed for thru-branch wiring, Non-IC recessed mounting, wet location, and to U.S. and Canadian Safety Standards.

Compact Fluorescent Downlighting

6" LP6FN

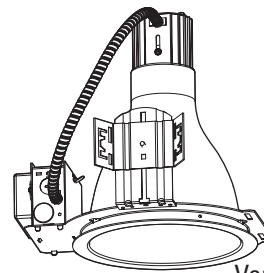

WET LENS
Vertical 1-Lamp, Double Twin-Tube (DTT) or Triple-Tube (TRT)

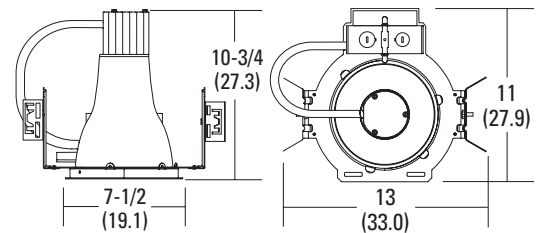

Specifications

Max. height: 10-3/4 (27.3)

Ceiling opening: 7 (17.8)

Overlap trim: 7-1/2 (19.1)

Length: 13 (33.0)

Width: 11 (27.9)

All dimensions are inches (centimeters).

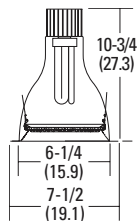

ORDERING INFORMATION

For shortest lead times, configure product using **standard options (shown in bold)**.

Example: LP6FN 26-42TRT 6LRF1 MVOLT

LP6FN

Series	Wattage/lamp	Reflector/lens ³	Voltage	Options ⁹
LP6FN	13DTT ¹	6LRF1 White splay, clear lens	MVOLT⁴ 120 277 347 ⁵	ADEZ Advance Mark 10™ electronic dimming ballast, 120V or 277V. Must be voltage specific. Minimum dimming level 5%
	18DTT	6LRFB1 Black baffle, clear lens		ECOS Lutron EcoSystem electronic dimming ballast, 120V - 277V. Must be wattage specific. Minimum dimming level 5%
	26DTT	6LR4 White splay, fresnel lens		EL Emergency PSDL3 DL battery pack with integral test switch. Lens removal required before EL testing⁶
	13TRT ¹	6LRB4 Black baffle, fresnel lens	6LRD3 White splay, drop opal lens	ELR Emergency PSDL3 DL battery pack with remote test switch⁶
	18TRT			ELHL Iota I-420-R High lumen output emergency battery pack. Internal test switch provided. Maximum average lumen output is 1300 (42W) ⁷
	26-42TRT²	6LRDB3 Black baffle, drop opal lens	6LRF3 White splay, flat black lens	ELRHL Iota I-420-EM-B High lumen output emergency battery pack. Remote test switch provided. Maximum average lumen output is 1300 (42W) ⁷
	26TRT	6LRF3 White splay, flat black lens		GMF Single slow-blow fuse, must specify voltage
	32TRT	6LRFB3 Black baffle, flat white lens		BDP Ballast disconnect plug (meets codes that require in-fixture disconnect) ⁵
	42TRT	6LRF73 White splay, tempered prismatic lens		RIF1 Radio interference filter
		6LRFB73 Black baffle, tempered prismatic lens		LBH Less barhangers
				NSD Sensor Switch nLight™ dimming relay ⁸
				WLP 35K lamp (shipped separately)

NOTES:

- Not available with ADEZ or ECOS.
- Not available with ECOS or WLP.
- White painted flange standard.
- Electronic multi-volt ballast capable of operating any line voltage from 120-277V, 50 or 60Hz.
- Not available with EL or ELR.
- Add 3" (7.6) to width and 4-1/2" (11.4) to length.
- Not recommended for field installation.
- One 5A relay with one 0-10 VDC dimming output, shipped installed. Requires additional nLight bus power supply.
- For additional options see lithonia.com.

Accessories

Order as separate catalog number

SCA6 Sloped ceiling adaptor. Degree of slope must be specified (10D, 15D, 20D, 25D, 30D) Ex: SCA6 10D.

CTE6 Ceiling thickness extender is used when ceiling thickness is greater than 1-1/2 (3.8). Maximum thickness 2 (5.1).

6" LP6FN Vertical 1-Lamp, Double Twin-Tube (DTT) or Triple Tube (TRT), Wet Lens

Distribution Curve Distribution Data Output Data Coefficient of Utilization

LP6FN 1/26TRT 6LR4 MVOLT, (1) 26W TRT lamp, 1800 rated lumens, 1.0 s/mh, Test no. LTL10759

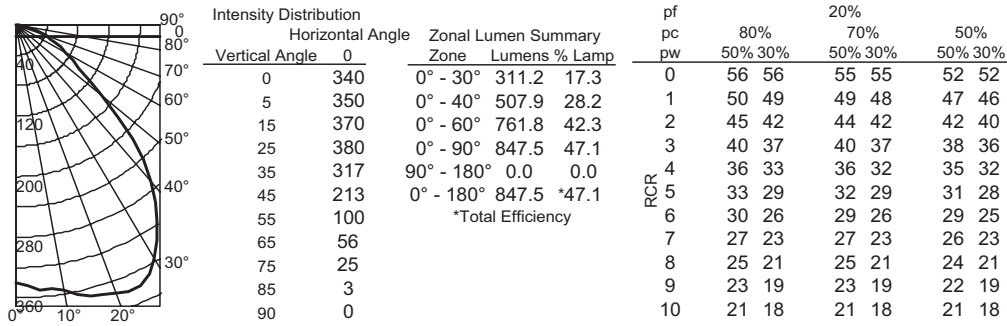

LP6FN 1/18TRT 6LR4 MVOLT, (1) 18W TRT lamp, 1200 rated lumens, 1.0 s/mh, Test no. LTL9929

