



BEVERAGE-AIR

3779 Champion Blvd., Winston-Salem, NC 27105
1-888-845-9800 Fax# 1-336-245-6453
<http://www.Beverage-Air.com>

Commercial Refrigeration Equipment General Specification

3 Year Parts/Labor Warranty Additional 2 Year Compressor Warranty

WTR AND WTF—SERIES WORKTOP UNITS

Select from 5 standard sizes in widths of 41" (1 door), 46" (1 door), 67" (2 door), 93" (3 door), and 119" (4 door). Working height* is 35 1/2" with units installed on 6 inch casters (2 with brakes).

CABINET CONSTRUCTION

Heavy duty construction includes stainless steel on front, sides, door(s) and grille. Worktop is stainless steel with built-in back-splash. Cabinet back and bottom are galvanized steel. Interior liner is made of aluminum for longer lasting corrosion protection. Interior thermometer is standard.

Cabinets are insulated with foamed-in-place polyurethane insulation of 2" minimum thickness. Work tops are 2 1/2". Doors are mounted to cabinet on self-closing, cartridge style hinges with 120° stay open feature. Door openings include low wattage, anti-condensate heaters (WTF67A only). A plug-in type vinyl magnetic gasket is attached to each door for positive seal. Convenient, contoured, pull handle is made of black anodized aluminum. Interior arrangement includes 2 steel wire epoxy coated shelves behind each door, adjustable in 1/2 inch increments.

REFRIGERATION

Balanced refrigeration systems used in all 5 sizes of self-contained refrigerated worktops provide high humidity storage of product at 35°F to 38°F. One size worktop freezer WTF67 holds product at 0° F and below. Unit is equipped with time activated, temperature terminated, electric defrost. Refrigerants include CFC-free R134a in refrigerators and 404A in freezers.

ELECTRICAL

Units wired at factory and ready for connection to a 115/60/1 phase, 15 amp dedicated outlet.

SPECIAL FEATURES

- WTR67A has earned the ENERGY STAR®.
- 6" casters, two with brakes standard.
- Optional 6" legs or 3" casters available

Item No. _____
Quantity _____

WORK TOP REFRIGERATORS AND FREEZER WORKTOP FREEZER 32" BASE MODEL SERIES

MODELS:
WTR41
WTR46A
WTR67A
WTR93A
WTR119A
WTF67A



WTR46



WTR67/WTF67

WTR67A has earned the ENERGY STAR.

ELECTRICAL CONNECTION

Units pre-wired at factory and include 8' long cord and plug set.



115/60/1
NEMA-5-15P

*Note: Overall heights of casters may vary with different types of casters depending upon caster manufacturer designations.

Available From:



Model Specified _____

Store# _____

Location _____

Quantity _____



BEVERAGE-AIR

Work Top Refrigerators and Freezer

Models: WTR41, WTR46A, WTR67A, WTR93A, WTR119A, WTF67A

MODEL	WTR41	WTR46A	WTR67A	WTR93A	WTR119A	WTF67A
EXTERNAL DIMENSIONAL DATA						
Length Overall (inches)	41"	46"	67"	93"	119"	67"
Length Overall (mm)	1041	1168	1702	2362	3023	1702
Depth Overall (inches) - Less handle	32"	32"	32"	32"	32"	32"
Depth Overall (mm) - Less handle	813	813	813	813	813	813
Height Overall—on 6" casters (inches)*	39 1/2"	39 1/2"	39 1/2"	39 1/2"	39 1/2"	39 1/2"
Height Overall—on 6" casters (mm)*	1003	1003	1003	1003	1003	1003
Depth with Door Open 90 °	55 3/8"	55 3/8"	55 3/8"	55 3/8"	55 3/8"	55 3/8"
Clear Door Opening (inches)	21 1/2" x 23 1/2"	21 1/2" x 23 1/2"	21 1/2" x 23 1/2"	21 1/2" x 23 1/2"	21 1/2" x 23 1/2"	21 1/2" x 23 1/2"
Number of doors	1	1	2	3	4	2
INTERNAL DIMENSIONAL DATA						
NET Capacity (cubic ft.)	14.75	16.7	27	39.8	52.5	27
NET Capacity (Liters)	418	473	765	1127	1487	765
Internal Length Overall (inches)	19"	22"	48"	74"	100 1/8"	48"
Internal Length Overall (mm)	483	559	1219	1880	2543	1219
Internal Depth Overall (inches)	28"	28"	28"	28"	28"	28"
Internal Depth Overall (mm)	711	711	711	711	711	711
Internal Height Overall (inches)	25"	25"	25"	25"	25"	25"
Internal Height Overall (mm)	635	635	635	635	635	635
Number of shelves	2	2	4	6	8	4
ELECTRICAL DATA						
Full Load Amperes 115/60/1	6.3	6.3	6.3	8.6	8.6	8.6
ENERGY CONSUMPTION (KWH)						
	n/a	2.81	2.56	3.49	3.91	15.3
REFRIGERATION DATA						
Horsepower	1/4	1/4	1/4	1/3	1/3	3/4
WEIGHT DATA						
Gross Weight (Crated lbs)	295	330	420	546	675	431
Gross Weight (Crated kg)	134	150	191	248	306	196

*Note: Overall heights of casters may vary with different types of casters depending upon caster manufacturer designations.



PLAN VIEWS

COMMON END VIEW

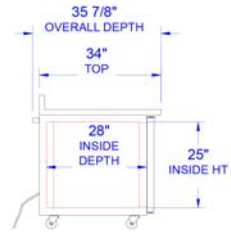

LEFT SIDE VIEW

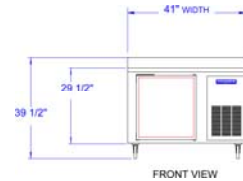

FRONT VIEW

WTR41

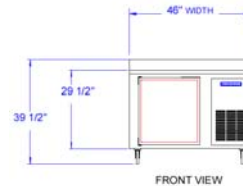

FRONT VIEW

WTR46A

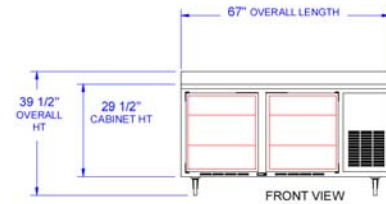

FRONT VIEW

WTR67A

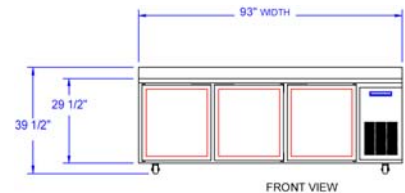

FRONT VIEW

WTR93A

WTR119A

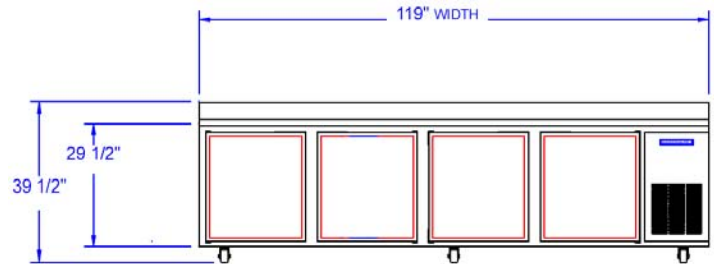

FRONT VIEW

WTF67A

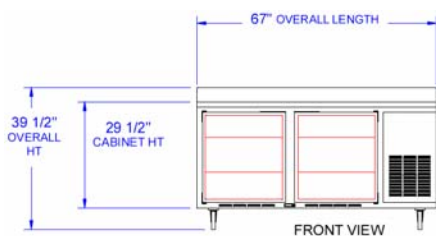

FRONT VIEW

BEVERAGE-AIR® CORPORATION

3779 Champion Blvd. • Winston-Salem, NC 27105 USA • (336) 245-6400 • Fax (336) 245-6453 • (888) 845-9800 • www.beverage-air.com

Specifications are subject to change without prior notice. 06/13