

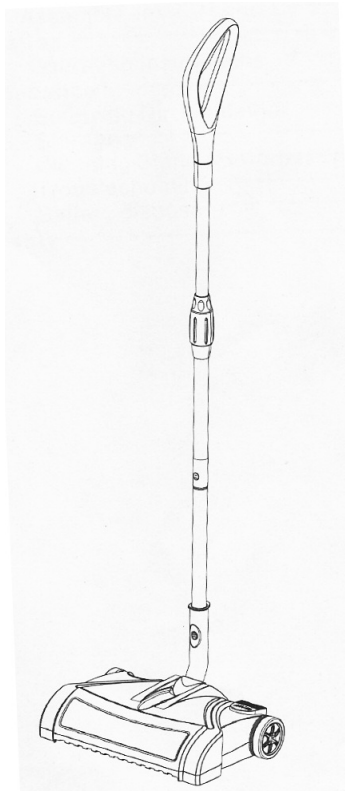

Assembly Instructions	Instrucciones de Ensamblaje	Directives d'assemblage
Customer Service US: 1-800-645-2986	Servicio de atención al Cliente México: 01.800.681.6940	Service à la clientèle Canada: 888-645-2986

RECHARGEABLE CORDLESS SWEEPER 12-INCH CLEANING PATH



Global Equipment Company
Call 1-800-645-2986

Model 641288

IMPORTANT!

Read all instructions carefully, and keep for future reference.

Contents

WARNING	1
Important Safety Instructions	1
Important Battery Handling Instructions	2
Parts List	3
Assembly	4
Assembly Instructions	4
Operation	5
Operation Instructions	5
Maintenance	6
Empty Dirt Container	6
Storage	6
Cleaning Standard Carpet Brushroll	6
Troubleshooting	7
Battery disposal	7
Warranty	8

IMPORTANT SAFETY INSTRUCTIONS!

When using an electrical appliance, basic precautions should always be followed, including the following:

READ ALL INSTRUCTIONS BEFORE USING THIS VACUUM CLEANER.

WARNING!



**To reduce the risk of fire,
electric shock, or injury:**

- Do not use outdoors or on wet surfaces.
- Do not expose to rain, store indoors.
- Do not allow the unit to be used as a toy. Close attention is necessary when used by children.
- Use only as described in this manual. Use only manufacturer's recommended attachments.
- Do not use extension cord or outlets with inadequate current carrying capacity.
- Do not handle charger or vacuum cleaner with wet hands.
- Do not incinerate or mutilate batteries as they will explode at high temperatures.
- Do not pick up anything that is burning or smoking such as cigarettes, matches, or hot material.
- Do not allow the battery to run down completely before charging. In doing so, serious problems may occur in the battery life cycle.
- Do not pick up flammable or combustible liquids such as gasoline, or use in areas where they are present.
- Store the adapter indoors in a cool dry area where it is not exposed to the weather in order to avoid electrical shock and/or cleaner damage.
- Only use the adapter provided by the manufacturer to recharge the appliance.

Additional Safeguards:

- Always disconnect cord from electrical outlet before servicing the cleaner.
- Only charge the unit indoors.

Lubrication:

- Lubrication is not necessary since the motor and brush roller are permanently lubricated.

SAVE THESE INSTRUCTIONS

If the adapter or the interconnection cord is damaged, it must be scrapped.

IMPORTANT BATTERY HANDLING INSTRUCTIONS!

When using an electrical appliance containing a NC/NM battery basic precaution should always be followed, including the following:

READ ALL INSTRUCTIONS BEFORE CHARGING THE BATTERY



WARNING!

**To reduce the risk of fire,
electric shock, or injury:**

Battery charging

- Charge batteries for 3 hours (NM) before initial use.
- Never modify the electrical system. Alterations could cause a fire resulting in serious injury and could also ruin the electrical system.
- Use of the wrong type battery or charger could cause a fire or explosion resulting in serious injury.
- The battery must be handled by adults only Dropping the Battery could result in serious injury.
- Never allow children to charge the battery. Battery charging must be done by adults only. A child could be injured by the electricity involved in charging the battery.
- Never lift or carry the battery by the wires or connector. This can damage the battery and possibly cause a fire resulting in serious injury. Lift and carry the battery by the case only.
- Read the safety instructions on the battery.
- Examine the battery, charger and their connectors for excessive wear or damage each time you charge the battery. If damage or excessive wear is detected, do not use the charger of the battery until you have replaced the worn or damaged part.

Care

- If a battery leak develops, avoid contact with the leaking acid and place the damaged battery in a plastic bag. Please refer to the information on this page for proper disposal.
- If acid comes in contact with skin or eyes, flush with cool water for at least 15 minutes and call a physician.
- Do not allow the battery to run down completely before charging.
- Charge the battery at least once per month, even if the vacuum has not been used.
- Leaving the battery in a discharged condition will ruin it.
- Do not store the battery in temperatures above 75°F or below -10°F.

Parts List

To assist you in identifying your sweeper components, the parts have been numbered as follows:

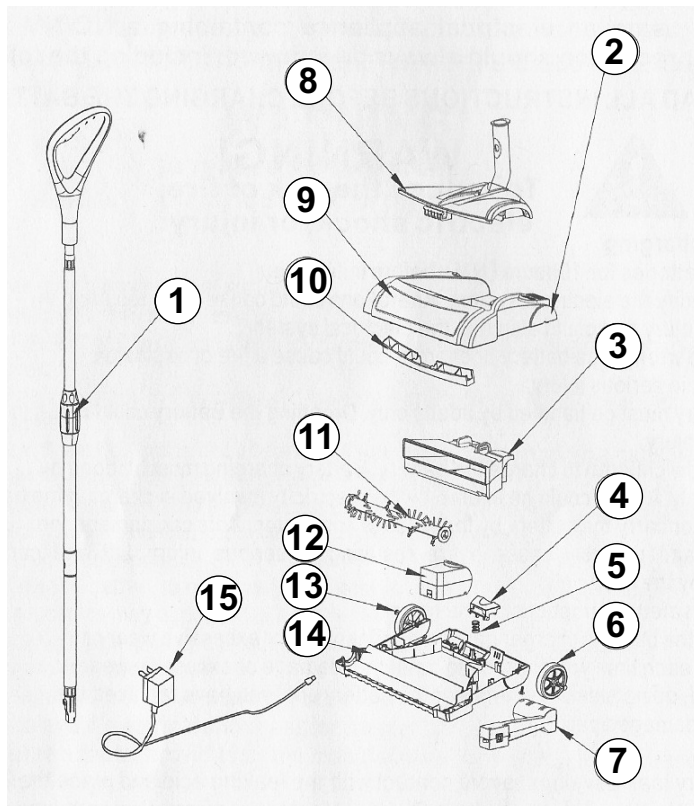

- | | |
|----------------------------------|--|
| 1. Handle complete | 8. Dust box cover |
| 2. Top cover | 9. Crystal window |
| 3. Dust box | 10. Fixed bracket |
| 4. Dust box cover release button | 11. Carpet brushroll w/release button complete |
| 5. Release button spring | 12. Battery package |
| 6. Rear wheel | 13. Rear wheel shaft |
| 7. Belt driving ASM | 14. Bottom base |
| | 15. Battery charger |

Assembly

Assembly Instructions

- 1** Attach wall mount to a flat surface using the screws provided.
- 2** Attach handle to the end of strut with the telescopic wand adjustment
Pressing down the locking tab, slide shorter strut over longer strut until locking tab catches. Insert assembled handle into the base until it locks in place.
Loosen the telescopic wand adjustment to lengthen or shorten the handle to the desired length and then tighten the telescopic wand adjustment
- 3** Insert battery into battery compartment unit it “snaps” in place. Connect the power adapter and allow the unit to charge for 10 hours (NM). Also you can remove the battery from the unit and charge the battery directly.
You can use the machine when the LED charging indicator light changes from red to green. Keep charging about one hour after the LED charging indicator light turns green, it can extend the runtime.
The LED charging display will light when charging.
NOTE: The unit will not charge if left in the ON position.
It is recommended that you remove the power adapter from the unit once the unit has completely charged.

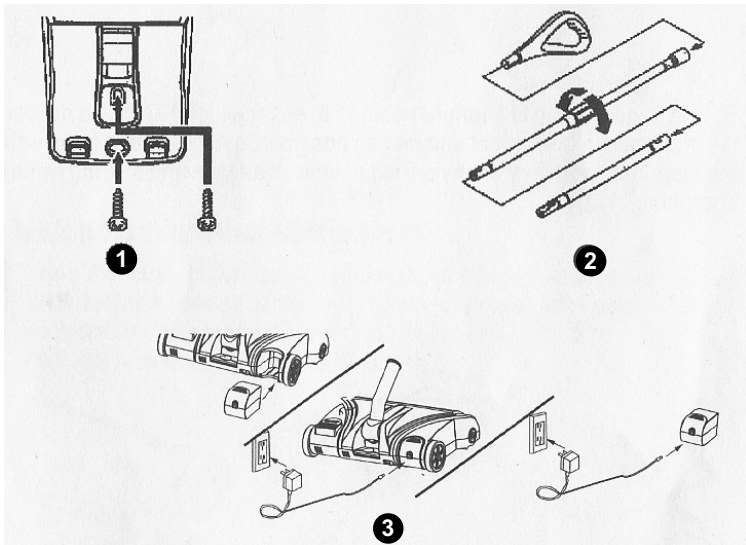

Operation

Operating Instructions

- 4 Press the ON/OFF switch button on top of the power head when ready to operate. Place foot on power head and lean handle back gently to release lock for sweeping use. Twist the handle slightly to make the sweeper turn easily to where you want to go.

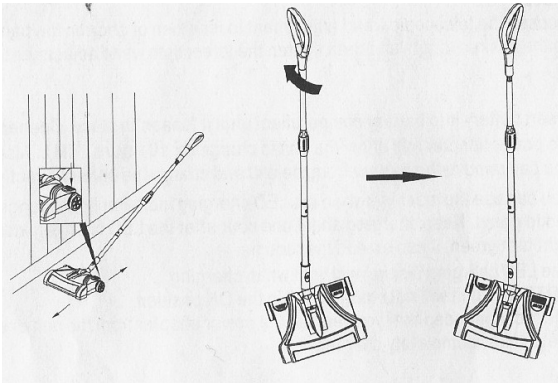

4

- 5 Return handle to the full upright position to engage lock. NOTE: Do not operate the unit while in the upright and locked position. Do not let the unit run while in the stationary position for any period of time. Keep the unit moving while in operation.

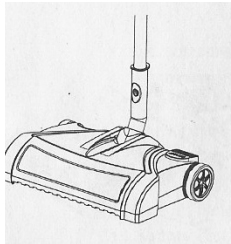

5

Maintenance

The performance of your new cleaner greatly depends upon care and maintenance. The instructions in this manual will guide you in performing basic care and maintenance. To obtain the most satisfying years of service read the instructions and keep them handy for future reference.

Emptying Dirt Container:

- 6 Firmly grasp the unit at handle base and with the other hand, press the dirt container release. Note: Make sure to have a firm grasp on the handle base and carefully lay the handle flat.
- 7 Lift the dirt container out of the unit and dump the contents into wastebasket. Reinsert the dirt container into the unit. Grasp the handle base and carefully rotate it forward until it locks into place.

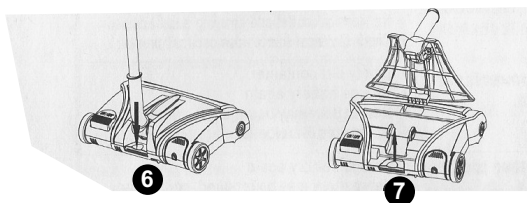

Storage

- 8 Attach the lip of the brushroll chamber over the hooks of the wall mount. Rotate handle upwards until it snaps into the handle lock.

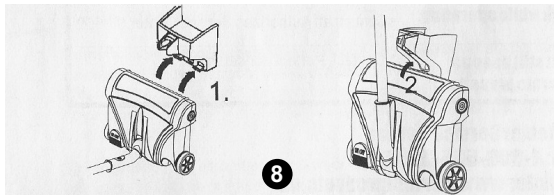

Cleaning Standard Carpet Brushroll

- 9 Press the Brushroll Release to remove the brushroll from the brushroll chamber. Remove any wound up debris using a knife or scissors. Cut debris along patented cleaning grooves in the brushroll for easier cleaning. Reinstall brushroll into brushroll chamber.

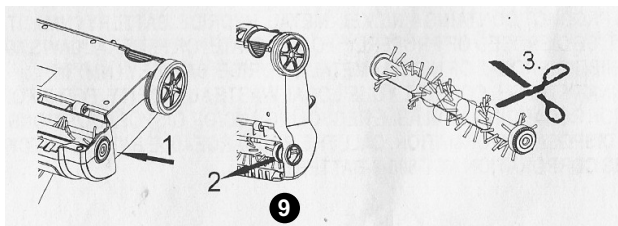

Maintenance

Troubleshooting

Service problems can often be solved easily. You can be your own troubleshooter by reviewing this guide. All other servicing should be done by an authorized service center.

Problem	What to do
Unit does not turn on	<ul style="list-style-type: none">• Charge battery again.• Check electrical source-fuse or circuit breaker.
LED charging indicator not lit while charging	<ul style="list-style-type: none">• Make sure the charging adapter is plugged in the electrical outlet and charging socket properly.• Check electrical source-fuse
Suction power is not sufficient	<ul style="list-style-type: none">• Empty dirt container.• Charge battery again.• New battery may be required, contact an Authorized Service Center.
Running time is not sufficient	<ul style="list-style-type: none">• Charge battery again.• New battery may be required, contact an Authorized Service Center.
Brushroll does not work while operating	<ul style="list-style-type: none">• Clean brushroll.• Contact an Authorized Service Center.
Unit still does not Operate properly	<ul style="list-style-type: none">• Contact Perfect for service.

Customer Service Hotline

Website: www.globalindustrial.com

Battery Disposal

To preserve natural resources, please recycle or dispose of expired battery pack properly.

THIS PRODUCT CONTAINS A NICKEL-METAL HYDRIDE BATTERY (NM). IT MUST BE DISPOSED OF PROPERLY. LOCAL, STATE, OR FEDERAL LAWS MAY PROHIBIT DISPOSAL OF NICKEL-METAL HYDRIDE BATTERY (NM) IN ORDINARY TRASH. CONSULT YOUR LOCAL WASTE AUTHORITY FOR INFORMATION REGARDING AVAILABLE RECYCLING AND/OR DISPOSAL OPTIONS. FOR DISPOSAL INFORMATION, CALL THE RECHARGEABLE BATTERY RECYCLING CORPORATION AT 1-800-8-BATTERY.



WHAT THIS WARRANTY COVERS

Your Global Industrial Sweeper is warranted to be free from all defects in material and workmanship in normal use FOR A PERIOD OF ONE YEAR. The warranty is granted only to the original purchaser of the cleaner. The warranty is subject to the following provisions.

Contact Customer Service (1-800-645-2986) for Warranty Coverage. Global reserves the right to change its warranty policy without notice.

WHAT THIS WARRANTY DOES NOT COVER

- Parts of the cleaner that require replacement under normal use.
- Damages or malfunctions caused by negligence, abuse, or use not in accordance with the Owner's Guide.
- Defects or damages caused by unauthorized service or the use of other than Global original parts

Global Industrial will, at its option, repair or replace a defective sweeper or sweeper part that is covered by this warranty. As a matter of warranty policy, Global Industrial will not refund the consumer's purchase price.

Global Industrial does not recognize internet sales, the warranty is null and void if the unit is purchased on E-Bay or any other non authorized internet site.

