

www.globalindustrial.com

US: 888-628-3466

Canada: 888-645-2986

Mexico: 01.800.681.6940

FORKLIFT RED ZONE PEDESTRIAN SAFETY WARNING LIGHT

Assembly/Mounting Instructions

Model # 988954

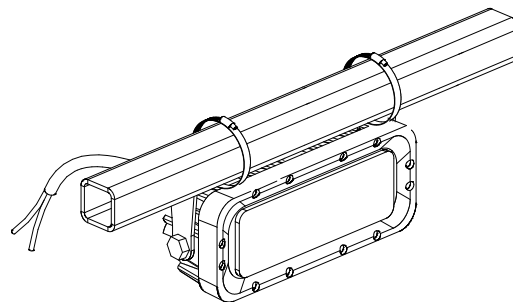

CONTENTS			CONTENTS		
REF	QTY	DESCRIPTION	REF	QTY	DESCRIPTION
1	2	BRACKET	H3	2	Lock Washer
2	1	LED LIGHT	H4	2	M8 x 1.25 Hex Nut
H1	2	M8 x 1.25 x 1.5" lg. Hex Head Bolt	H5	2	Double Sided Adhesive Pad
H2	2	M8 x 1.25 x 0.5" lg. Hex Head Bolt	H6	2	Clamp
				2	Cable Tie

TECHNICAL SPECIFICATIONS

- LED: High Power OSRAM LED, Red
- Construction: Aluminum Casting, Polycarbonate Lens
- Voltage: 10 ~ 80VDC
- IP Rating: 68
- Lumens: 1300
- Working Temperature: -49 ~ 185°F
- Reverse Polarity Protected
- Service Life: > 30,000 hours

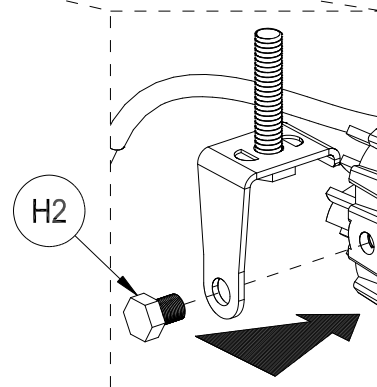
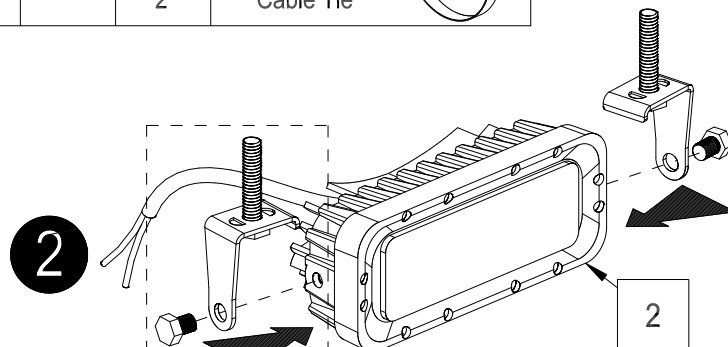
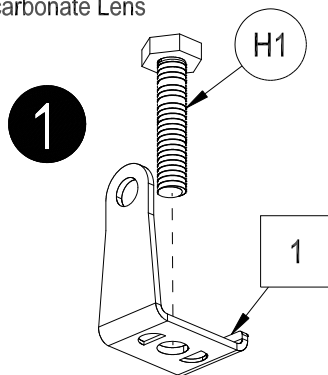

3

Mounting surface
not included

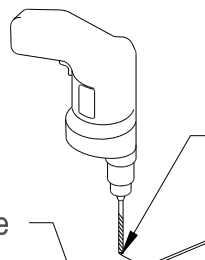

Use a 3/8" drill bit
to make mounting holes

Note: Drill bit not included

4.5 IN.

WARNING.

- To properly install this work light, you must have a good understanding of automotive electrical procedures and systems, along with proficiency in the installation and use of safety warning equipment
- When drilling into a vehicle structure, be sure that both sides of the surface are clear of anything that could be damaged
- You should frequently inspect the light to ensure that it is operating properly
- This product contains high intensity LED devices. To prevent eye damage, DO NOT stare into the light beam at close range
- Ideal location for the LED is the top horizontal safety cage beam (front and/or rear as applicable)

If these instructions are not clear, contact your local fork lift dealer for correct electrical connection locations for your particular vehicle. Also, note the length of the wire required for final installation varies by application and location. An extension wire can be used if needed.

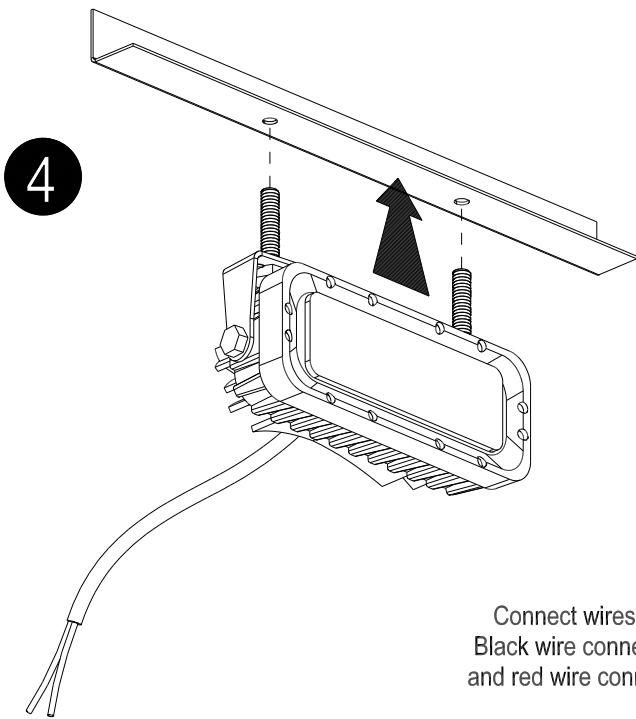

5

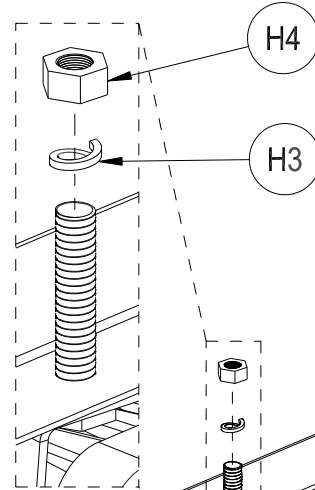

Red Wire: Positive

Connect wires to vehicle battery.
Black wire connects to negative pole
and red wire connects to positive pole

Black Wire: Negative

Note: Make sure connections are performed
in accordance with your forklift manufacturer

ALTERNATIVE MOUNTING

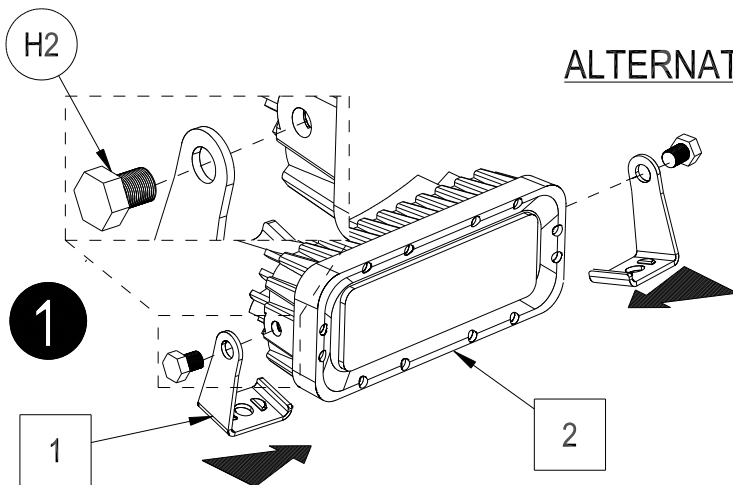

2

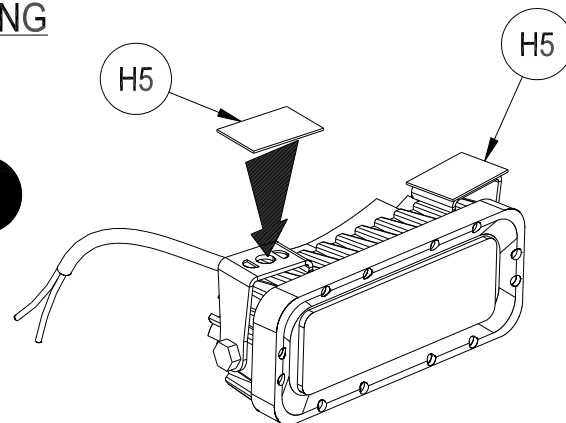

3

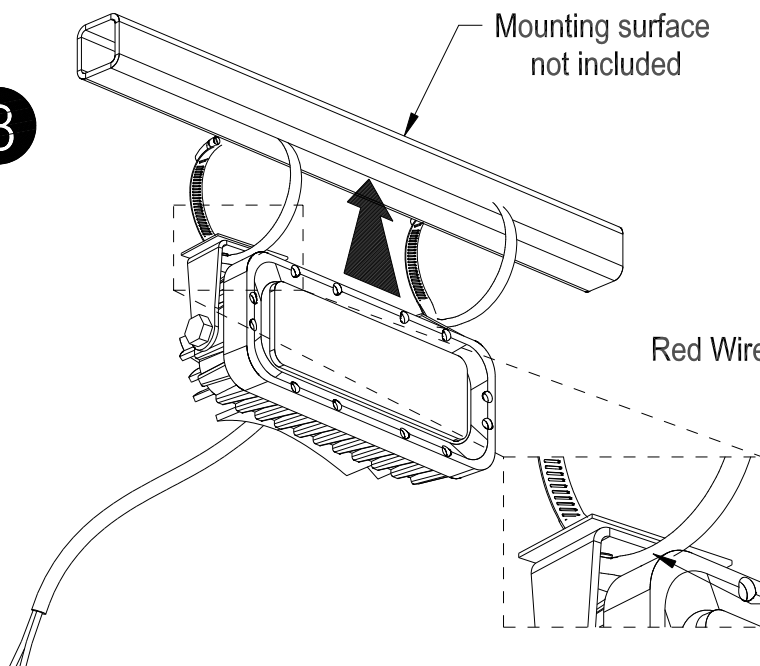

Mounting surface
not included

Red Wire: Positive

4

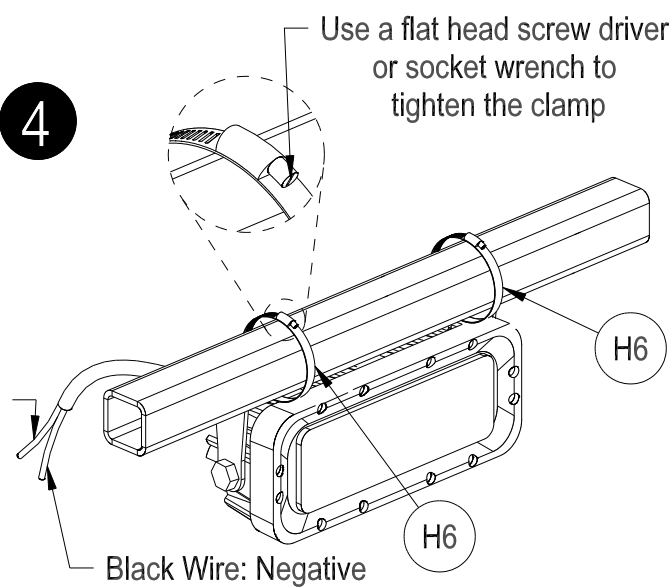

Black Wire: Negative

Loop the clamp
under the bracket