

| A Size In. | ID In. | Rolled Edge (nom. in.) | Length  | Weight Lbs | Galvanized Steel |      |      |      | 304SS (or 316SS) |      |      |
|------------|--------|------------------------|---|------------|------------------|------|------|------|------------------|------|------|
|            |        |                        |   |            | 22ga             | 20ga | 18ga | 16ga | 22ga             | 20ga | 18ga |
| 3          | 3.05   | .2                     | QF or Raw ends:<br>Length = A + 4"                    | 2.32       | Std              |      |      |      | Std              |      |      |
| 4          | 3.86   | .2                     |   | 3.00       |                  |      |      |      |                  |      |      |
| 5          | 4.86   | .2                     |   | 3.75       |                  |      |      |      |                  |      |      |
| 6          | 5.89   | .2                     |   | 4.25       |                  |      |      |      |                  |      |      |
| 7          | 6.89   | .3                     |   | 5.00       |                  |      |      |      |                  |      |      |
| 8          | 7.88   | .3                     |   | 6.00       |                  |      |      |      |                  |      |      |
| 9          | 8.88   | .3                     |   | 7.25       |                  |      |      |      |                  |      |      |
| 10         | 9.89   | .3                     |   | 8.50       |                  |      |      |      |                  |      |      |
| 11         | 10.88  | .3                     |   | 9.25       |                  |      |      |      |                  |      |      |
| 12         | 11.97  | .4                     |   | 10.75      |                  |      |      |      |                  |      |      |
| 13         | 12.97  | .4                     | 11.40   |            |                  |      |      |      |                  |      |      |
| 14         | 13.96  | .4                     | 13.50   |            |                  |      |      |      |                  |      |      |
| 15         | 14.97  | .4                     | 15.60   |            |                  |      |      |      |                  |      |      |
| 16         | 15.97  | .4                     | 17.56   |            |                  |      |      |      |                  |      |      |
| 17         | 16.97  | .4                     | 19.00   |            |                  |      |      |      |                  |      |      |
| 18         | 17.96  | .4                     | 21.00   |            |                  |      |      |      |                  |      |      |
| 19         | 18.96  | .4                     | 25.00   |            |                  |      |      |      |                  |      |      |
| 20         | 19.96  | .4                     | 30.00   |            |                  |      |      |      |                  |      |      |
| 21         | 20.97  | .4                     | 35.00   |            |                  |      |      |      |                  |      |      |
| 22         | 21.97  | .4                     | 39.50   |            |                  |      |      |      |                  |      |      |
| 23         | 23.97  | .4                     | 47.00   |            |                  |      |      |      |                  |      |      |
| 24         | 24.93  | .4                     | 53.50   |            |                  |      |      |      |                  |      |      |
| 25         | 25.96  | Angle Flange (AF)      | Flanged ends:<br>B or D ports leg length is 4.5" min. | 63.00      | Std              |      |      |      | Std              |      |      |
| 26         | 25.96  | AF                     |   | 74.00      |                  |      |      |      |                  |      |      |
| 27         | 27.94  | AF                     |   | 81.00      |                  |      |      |      |                  |      |      |
| 28         | 27.94  | AF                     |   | 98.00      |                  |      |      |      |                  |      |      |
| 29         | 28.89  | AF                     |   | 107.00     |                  |      |      |      |                  |      |      |
| 30         | 29.89  | AF                     |   | 117.05     |                  |      |      |      |                  |      |      |
| 31         | 30.94  | AF                     |   | 121.00     |                  |      |      |      |                  |      |      |
| 32         | 31.87  | AF                     |   | 125.94     |                  |      |      |      |                  |      |      |
| 33         | 32.92  | AF                     |   | 130.00     |                  |      |      |      |                  |      |      |
| 34         | 33.95  | AF                     |   | 134.83     |                  |      |      |      |                  |      |      |
| 35         | 34.90  | AF                     |   | 138.00     |                  |      |      |      |                  |      |      |
| 36         | 35.93  | AF                     |   | 142.78     |                  |      |      |      |                  |      |      |
| 37         | 36.99  | AF                     |   | 148.00     |                  |      |      |      |                  |      |      |
| 38         | 37.86  | AF                     |   | 153.47     |                  |      |      |      |                  |      |      |
| 39         | 38.88  | AF                     |   | 158.00     |                  |      |      |      |                  |      |      |
| 40         | 39.97  | AF                     |   | 162.81     |                  |      |      |      |                  |      |      |

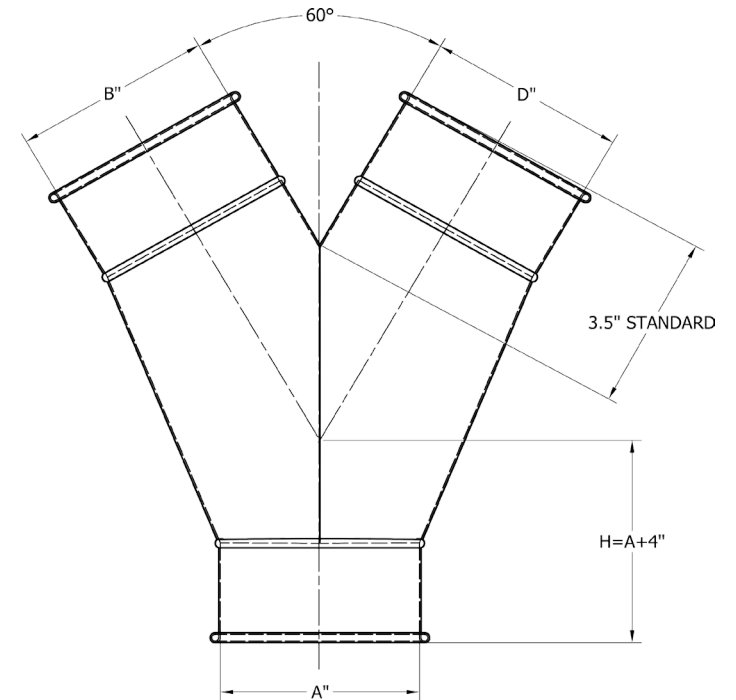

| Temperature Rating of Product Components |                  |                  |                                   |  |   |
|--|------------------|------------------|-----------------------------------|--|---|
| ° F                                      | Y-Branch         |                  | Sealants                          |  |   |
| 1100°                                    |                  |                  |                                   |  |   |
| 500°                                     |                  |                  |                                   |  |   |
| 400°                                     |                  |                  |                                   |  |   |
| 390°                                     | Galvanized Steel | Optional - 304SS |                                   |  | Optional - Red Devil HVAC/R High Temperature Silicone Sealant |
| 250°                                     |                  |                  |                                   |  |   |
| 194°                                     |                  |                  | 3M Scotch Seal Metal Sealant 2084 | Optional - Rock River Silicone Sealant |   |
| 0°                                       |                  |                  |                                   |  | Optional - Epoxy - 3M DP 125 Gray Sealant                     |
| -40°                                     |                  |                  |                                   |  |   |
| -60°                                     |                  |                  |                                   |  |   |

| Additional Notes   |
|--|
| At temperatures ranging between 390° F and 480° F, the zinc-iron alloy layers in galvanized steel will continue to provide a high level of protection from corrosion. However, there may be some peeling, changes in mechanical properties, and reduction in the corrosion protection. Recommended max. service temperature is 390° F. |
| Rock River Silicone Sealant and Red Devil HVAC/R High Temperature Silicone Sealant are not paintable   |
| 304SS:<br>bluing may occur at 800° F and above   |

| Compliance / Rating of Product Components |               |   |
|---|---------------|---|
| Product                                   | Material      | Compliance / Rating   |
| QF Y-Branch                               | Galvanized    | ASTM A527 with a G-90 rating  |
|   | 304SS         | Finish meets ASTM A240  |
|   | 316SS         | Finish meets ASTM A240  |
| 3M Scotch Seal Metal Sealant 2084         | Acetone blend | AAMA Specification 801.1  |
| Rock River Sealant                        | 100% Silicone | ASTM C920 Class 25, TT-S-00230C Class A and TT-S-001543A, FDA No 421 CFR 117.2600, conforms to FDA requirements                             |
| Red Devil HVAC/R High Temperature Sealant | Silicone      | ASTM C920 Class 25, TT-S-00230C Class A and TT-S-001543A, CEBTP 432.6 140-2, Mil Spec 46106A, CGSB 19C9-9B, DIN 18540 Part 2, OREX 150031-2 |

**Construction:**

**Seam:** longitudinal seam is lapped, spot welded, and caulked.

**Collars:** located on the exterior side of each port and considered as air flow non-directional. Collars have a laser welded longitudinal seam. If air flow directional product is required, it must be stated on the PO and additional cost may be incurred. A raised lap seam and spot weld are used for attaching the collar to the body and no caulking is used. If caulking is required, additional cost may be incurred.

Ends: Standard QF end can be changed to Raw ID (RAWID), Raw OD (RAWOD), No Fitting (NF), Hose Adapter (RAWFLEX), Flat Flange (FFL), Angle Flange (ANGFL), or Van Stone (VANSTONE).