



No.:

Date: 27-DEC-2012

Customer :

TECHNICAL PROPOSAL

Three-phase induction motor - Squirrel cage rotor

Product line : Oil Well Pumping : High Slip - NEMA Design "D" - TEFC (IP55)

Catalog Number : 01009ES3EOW286T

List Price : \$3,437

Notes:

Performed by:

Checked:



No.:

Date: 27-DEC-2012

DATA SHEET

Three-phase induction motor - Squirrel cage rotor

Customer :
Product line : Oil Well Pumping : High Slip - NEMA Design "D" - TEFC (IP55)

Frame : 286T
Output : 10 HP
Frequency : 60 Hz
Poles : 8
Full load speed : 830
Slip : 7.78 %
Voltage : 208-230/460 V
Rated current : 30.7-27.8/13.9 A
Locked rotor current : 161/80.6 A
Locked rotor current (I_L/I_n) : 5.8
No-load current : 9.00/4.50 A
Full load torque : 62.4 lb.ft
Locked rotor torque : 320 %
Breakdown torque : 0 %
Design : D
Insulation class : F
Temperature rise : 80 K
Locked rotor time : 28 s (hot)
Service factor : 1.15
Duty cycle : S1
Ambient temperature : -20°C - +40°C
Altitude : 1000
Degree of Protection : IP55
Approximate weight : 382 lb
Moment of inertia : 6.2173 sq.ft.lb
Noise level : 54 dB(A)

	D.E.	N.D.E.	Load	Power factor	Efficiency (%)
Bearings	6311 C3	6211 C3	100%	0.82	82.5
Regreasing interval	20000 h	20000 h	75%	0.80	83.0
Grease amount	18 g	11 g	50%	0.70	82.5

Notes:

Performed by

Checked



No.:

Date: 27-DEC-2012

PERFORMANCE CURVES RELATED TO RATED OUTPUT

Three-phase induction motor - Squirrel cage rotor

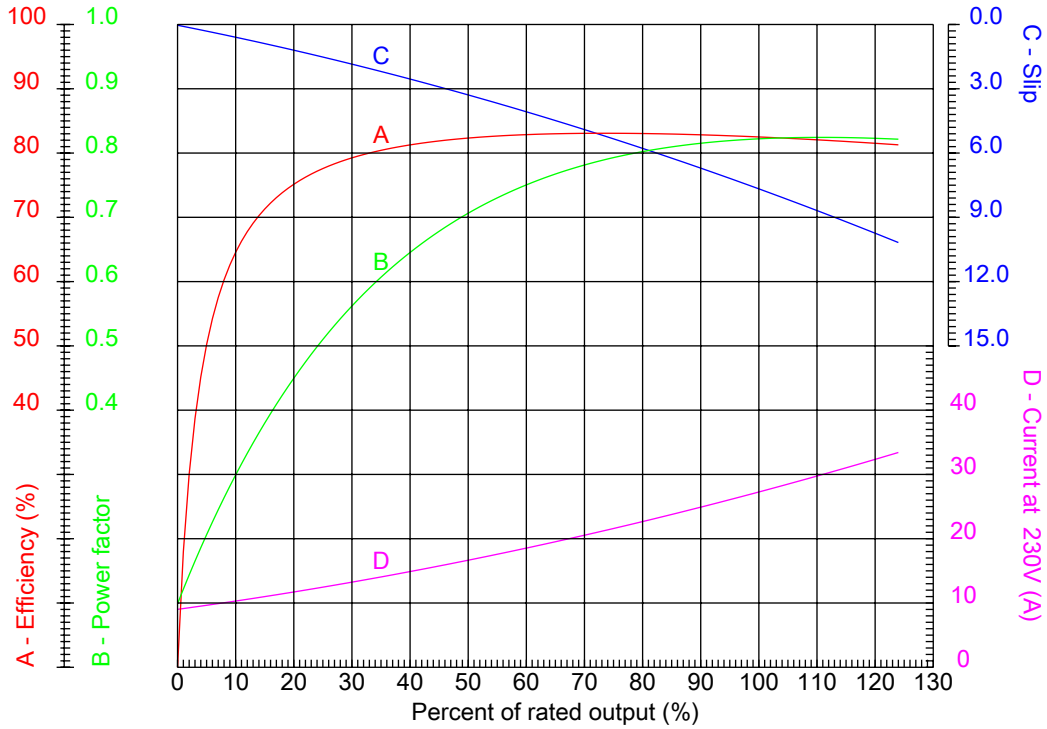

Customer :
Product line : Oil Well Pumping : High Slip - NEMA Design "D" - TEFC (IP55)

Frame	: 286T	Locked rotor current (I _l /I _n)	: 5.8
Output	: 10 HP	Duty cycle	: S1
Frequency	: 60 Hz	Service factor	: 1.15
Full load speed	: 830	Design	: D
Voltage	: 208-230/460 V	Locked rotor torque	: 320 %
Rated current	: 30.7-27.8/13.9 A	Breakdown torque	: 0 %
Insulation class	: F		

Notes:

Performed by

Checked



No.:

Date: 27-DEC-2012

CHARACTERISTIC CURVES RELATED TO SPEED

Three-phase induction motor - Squirrel cage rotor

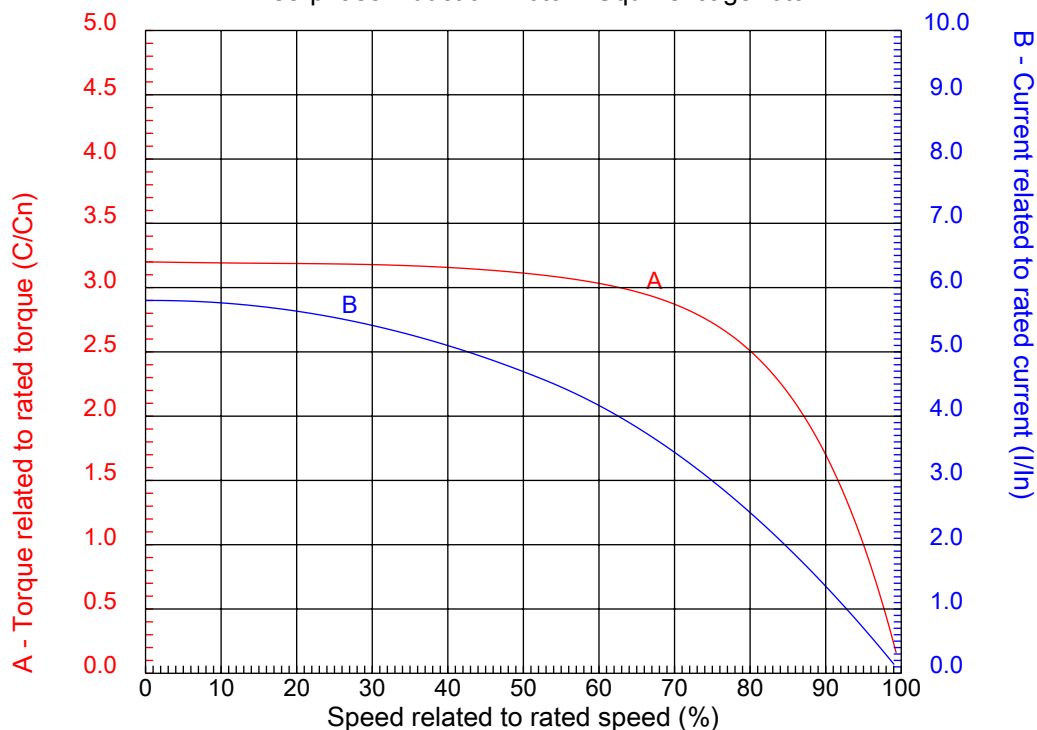

Customer :
Product line : Oil Well Pumping : High Slip - NEMA Design "D" - TEFC (IP55)

Frame	: 286T	Locked rotor current (I _l /I _n)	: 5.8
Output	: 10 HP	Duty cycle	: S1
Frequency	: 60 Hz	Service factor	: 1.15
Full load speed	: 830	Design	: D
Voltage	: 208-230/460 V	Locked rotor torque	: 320 %
Rated current	: 30.7-27.8/13.9 A	Breakdown torque	: 0 %
Insulation class	: F		

Notes:

Performed by

Checked

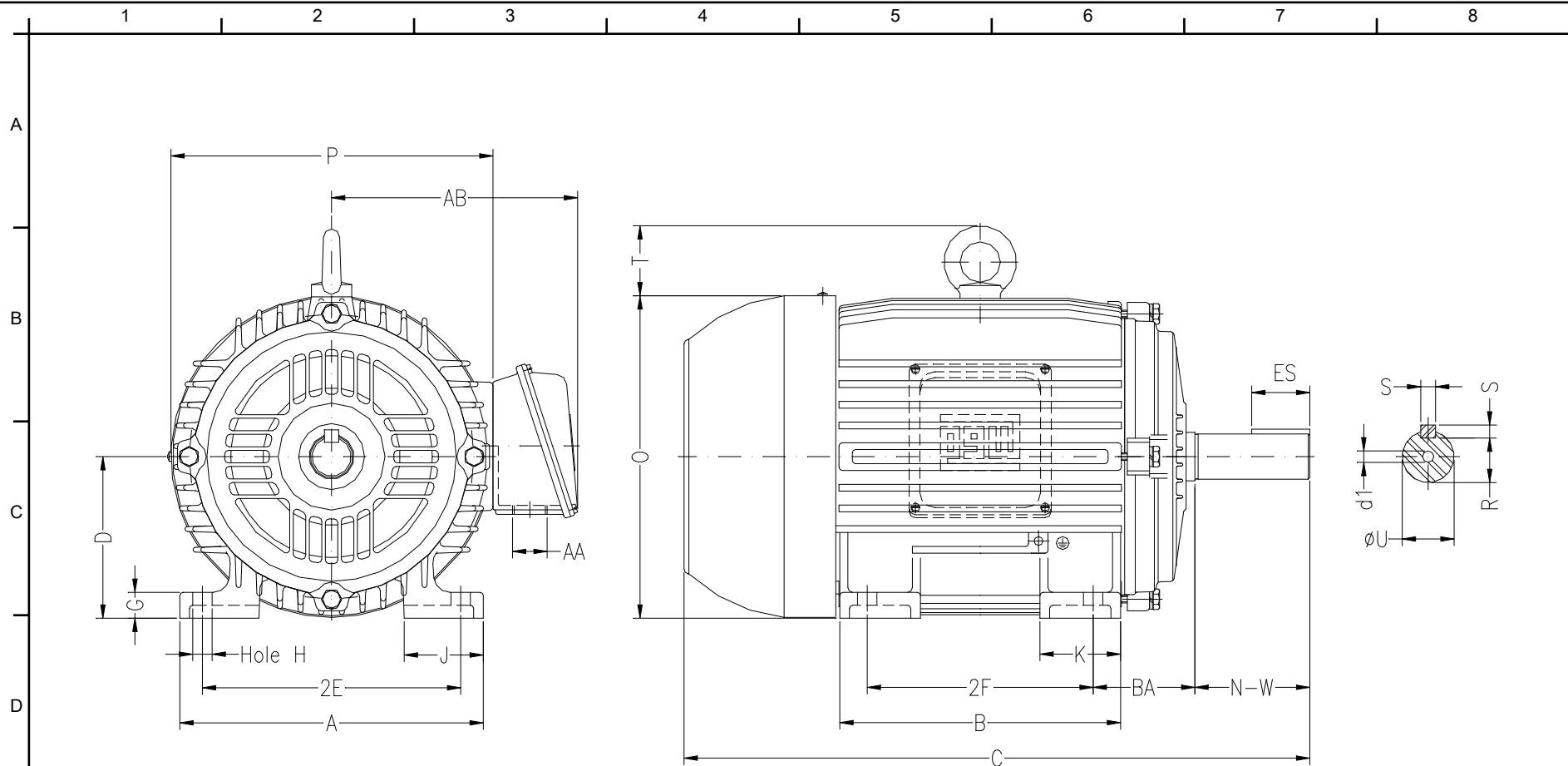

Notes:

Performed by:

Checked:

Customer:

Oil Well Pumping : High Slip - NEMA Design "D" - TEFC (IP55)

Three-phase induction motor
Frame 286T - IP55

27-DEC-2012



2E 11.000	A 13.780	2F 11.000	B 13.071	BA 4.750
J 3.150	K 2.953	P 14.094	ES 3.149	depth 0.500
S 0.500	N-W 4.622	U 1.875	R 1.594	AB 10.866
D 7.000	G 1.016	O 14.067	T 2.087	HD 16.154
H 0.531	C 27.929	AA NPT 1 1/2"	d1 A 4	d2 A 4
Flange FD-317	AJ 12.500	AK 11.000	BD 14.000	BF 0.828
BB 0.203				