



No.:

Date: 24-DEC-2012

Customer :

TECHNICAL PROPOSAL

Three-phase induction motor - Squirrel cage rotor

Product line : Three-Phase: W21 IE3 IEC Tru-Metric - TEFC (IP55) Multi-Mounting Aluminum Frame

Catalog Number : 00152ET3WAL100L

List Price : \$812

Notes:

Performed by:

Checked:



No.:

Date: 24-DEC-2012

DATA SHEET

Three-phase induction motor - Squirrel cage rotor

Customer :
Product line : Three-Phase: W21 IE3 IEC Tru-Metric - TEFC (IP55) Multi-Mounting Aluminum Frame

Frame : 100L
Output : 2 HP
Frequency : 60 Hz
Poles : 6
Full load speed : 1155
Slip : 3.75 %
Voltage : 460 V
Rated current : 3.15 A
Locked rotor current : 19.8 A
Locked rotor current (I_L/I_n) : 6.3
No-load current : 2.08 A
Full load torque : 8.97 lb.ft
Locked rotor torque : 250 %
Breakdown torque : 320 %
Design : N
Insulation class : F
Temperature rise : 80 K
Locked rotor time : 31 s (hot)
Service factor : 1.25
Duty cycle : S1
Ambient temperature : -20°C - +40°C
Altitude : 1000
Degree of Protection : IP55
Approximate weight : 71 lb
Moment of inertia : 0.33934 sq.ft.lb
Noise level : 44 dB(A)

	D.E.	N.D.E.	Load	Power factor	Efficiency (%)
Bearings	6206 ZZ	6205 ZZ	100%	0.69	86.5
Regreasing interval	---	---	75%	0.61	85.5
Grease amount	---	---	50%	0.48	82.5

Notes:

Performed by

Checked



No.:

Date: 24-DEC-2012

PERFORMANCE CURVES RELATED TO RATED OUTPUT

Three-phase induction motor - Squirrel cage rotor

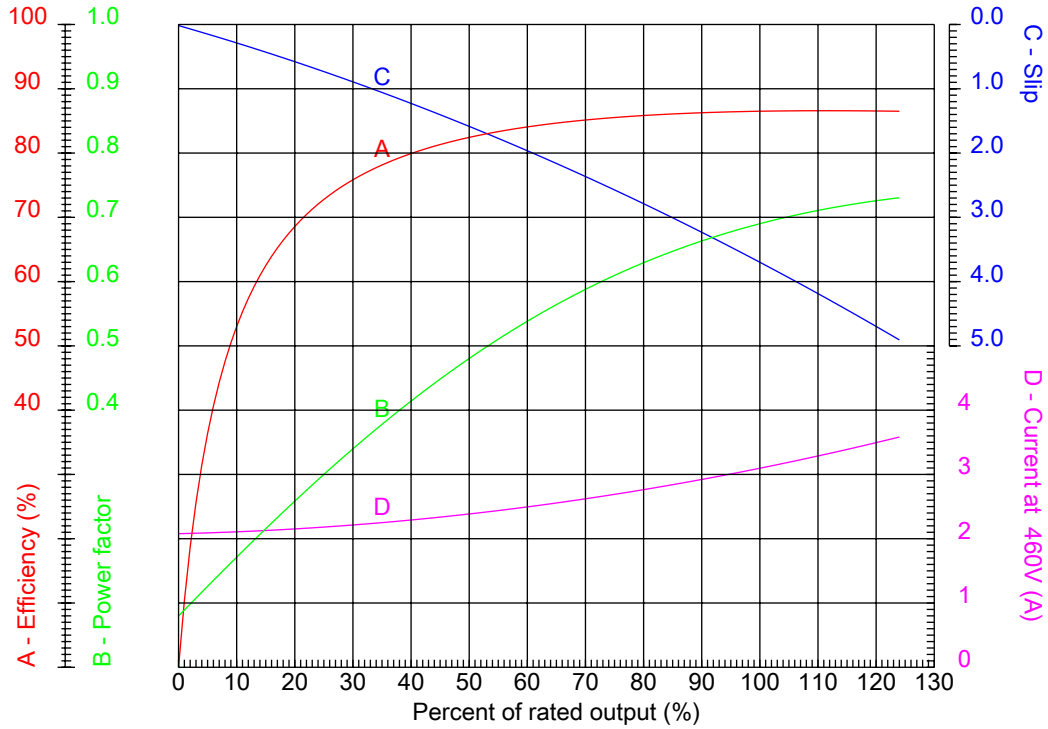

Customer :
Product line : Three-Phase: W21 IE3 IEC Tru-Metric - TEFC (IP55) Multi-Mounting Aluminum Frame

Frame : 100L	Locked rotor current (I _L /I _n) : 6.3
Output : 2 HP	Duty cycle : S1
Frequency : 60 Hz	Service factor : 1.25
Full load speed : 1155	Design : N
Voltage : 460 V	Locked rotor torque : 250 %
Rated current : 3.15 A	Breakdown torque : 320 %
Insulation class : F	

Notes:

Performed by

Checked



No.:

Date: 24-DEC-2012

CHARACTERISTIC CURVES RELATED TO SPEED Three-phase induction motor - Squirrel cage rotor

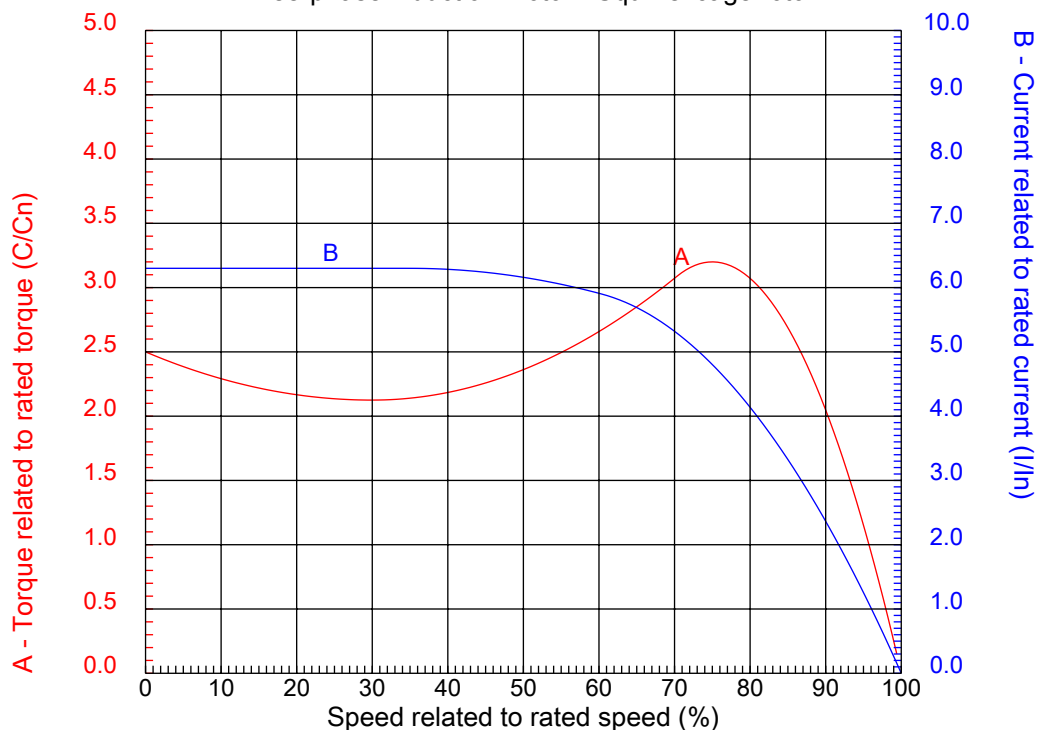

Customer :
Product line : Three-Phase: W21 IE3 IEC Tru-Metric - TEFC (IP55) Multi-Mounting Aluminum Frame

Frame	: 100L	Locked rotor current (I _l /I _n)	: 6.3
Output	: 2 HP	Duty cycle	: S1
Frequency	: 60 Hz	Service factor	: 1.25
Full load speed	: 1155	Design	: N
Voltage	: 460 V	Locked rotor torque	: 250 %
Rated current	: 3.15 A	Breakdown torque	: 320 %
Insulation class	: F		

Notes:

Performed by

Checked

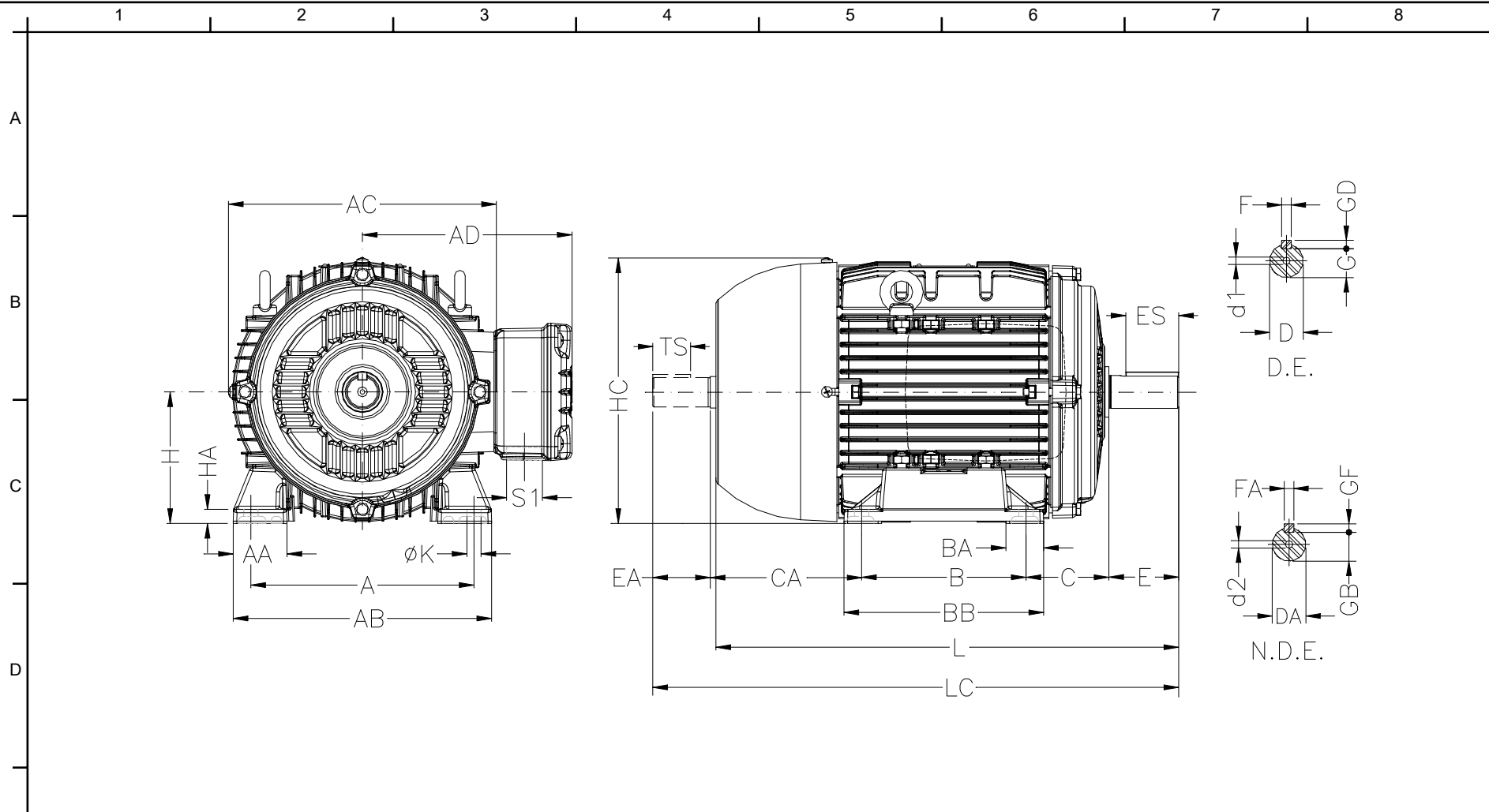

	A	AA	AB	AC	AD	Notes:
E	160	40	196	200	165	
	B	BA	BB	C	CA	Performed by:
	140	30	170	63	118	
	D	E	ES	F	G	Checked:
	28j6	60	45	8	24	
	GD	DA	EA	TS	FA	Customer:
	7	22j6	50	36	6	
	GB	GF	H	HA	HC	Three-Phase: W21 IE3 IEC Tru-Metric - TEFC (IP55) Multi-Mounting Aluminum
	18.5	6	100	12	198	
	HD	K	L	LC	S1	Three-phase induction motor
F	260	12	376	431	NPT 3/4"	
	d1	d2	Flange	LA	M	Frame 100L - IP55
	DM10	DM8	FF-215	11	215	
	N	P	T	S	Angle	24-DEC-2012
	180	250	4	15	45°	
	Holes					
	4					