



No.:

Date: 24-DEC-2012

Customer :

TECHNICAL PROPOSAL

Three-phase induction motor - Squirrel cage rotor

Product line : Three-Phase: W21 IE3 IEC Tru-Metric - TEFC (IP55) Multi-Mounting Aluminum  
Frame

Catalog Number : 00218ET3WAL100L

List Price : \$630

Notes:

Performed by:

Checked:



No.:

Date: 24-DEC-2012

## DATA SHEET

### Three-phase induction motor - Squirrel cage rotor

Customer :  
 Product line : Three-Phase: W21 IE3 IEC Tru-Metric - TEFC (IP55) Multi-Mounting Aluminum Frame

Frame : 100L  
 Output : 3 HP  
 Frequency : 60 Hz  
 Poles : 4  
 Full load speed : 1740  
 Slip : 3.33 %  
 Voltage : 460 V  
 Rated current : 3.91 A  
 Locked rotor current : 29.7 A  
 Locked rotor current (I<sub>L</sub>/I<sub>n</sub>) : 7.6  
 No-load current : 2.20 A  
 Full load torque : 8.93 lb.ft  
 Locked rotor torque : 380 %  
 Breakdown torque : 370 %  
 Design : N  
 Insulation class : F  
 Temperature rise : 80 K  
 Locked rotor time : 20 s (hot)  
 Service factor : 1.25  
 Duty cycle : S1  
 Ambient temperature : -20°C - +40°C  
 Altitude : 1000  
 Degree of Protection : IP55  
 Approximate weight : 60 lb  
 Moment of inertia : 0.21357 sq.ft.lb  
 Noise level : ---

	D.E.	N.D.E.	Load	Power factor	Efficiency (%)
Bearings	6206 ZZ	6205 ZZ	100%	0.79	89.5
Regreasing interval	---	---	75%	0.72	88.2
Grease amount	---	---	50%	0.59	86.6

Notes:

Performed by

Checked



No.:

Date: 24-DEC-2012

### PERFORMANCE CURVES RELATED TO RATED OUTPUT Three-phase induction motor - Squirrel cage rotor

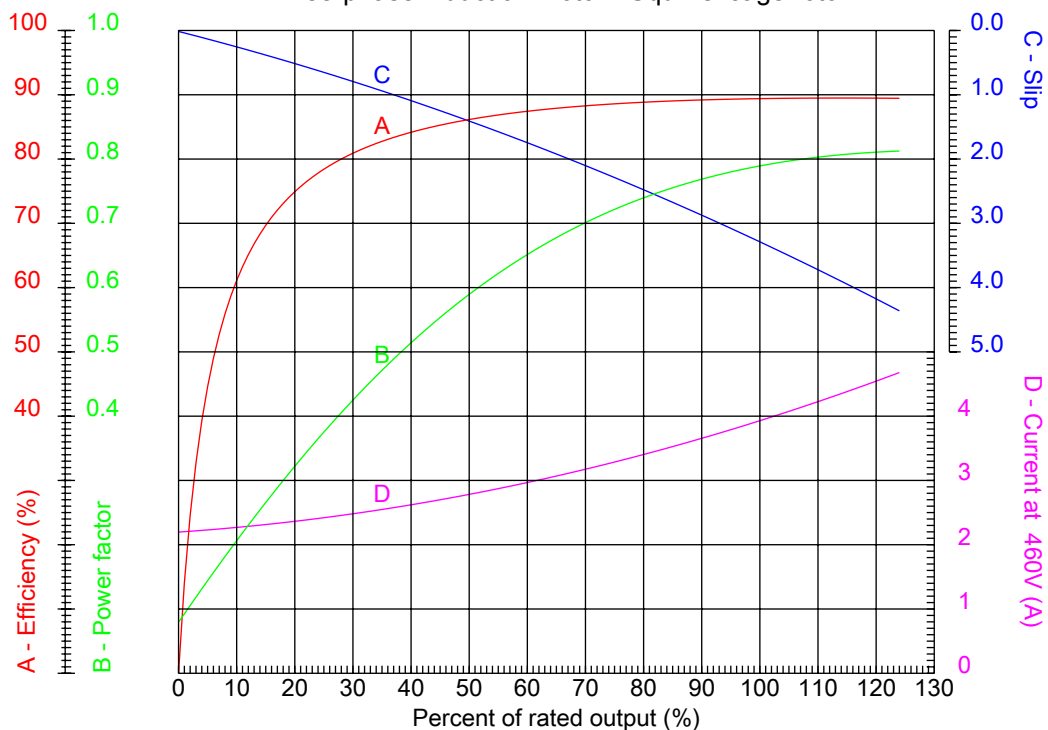

Customer :  
Product line : Three-Phase: W21 IE3 IEC Tru-Metric - TEFC (IP55) Multi-Mounting Aluminum Frame

Frame : 100L	Locked rotor current (I <sub>l</sub> /I <sub>n</sub> ) : 7.6
Output : 3 HP	Duty cycle : S1
Frequency : 60 Hz	Service factor : 1.25
Full load speed : 1740	Design : N
Voltage : 460 V	Locked rotor torque : 380 %
Rated current : 3.91 A	Breakdown torque : 370 %
Insulation class : F	

Notes:

Performed by

Checked



No.:

Date: 24-DEC-2012

### CHARACTERISTIC CURVES RELATED TO SPEED Three-phase induction motor - Squirrel cage rotor

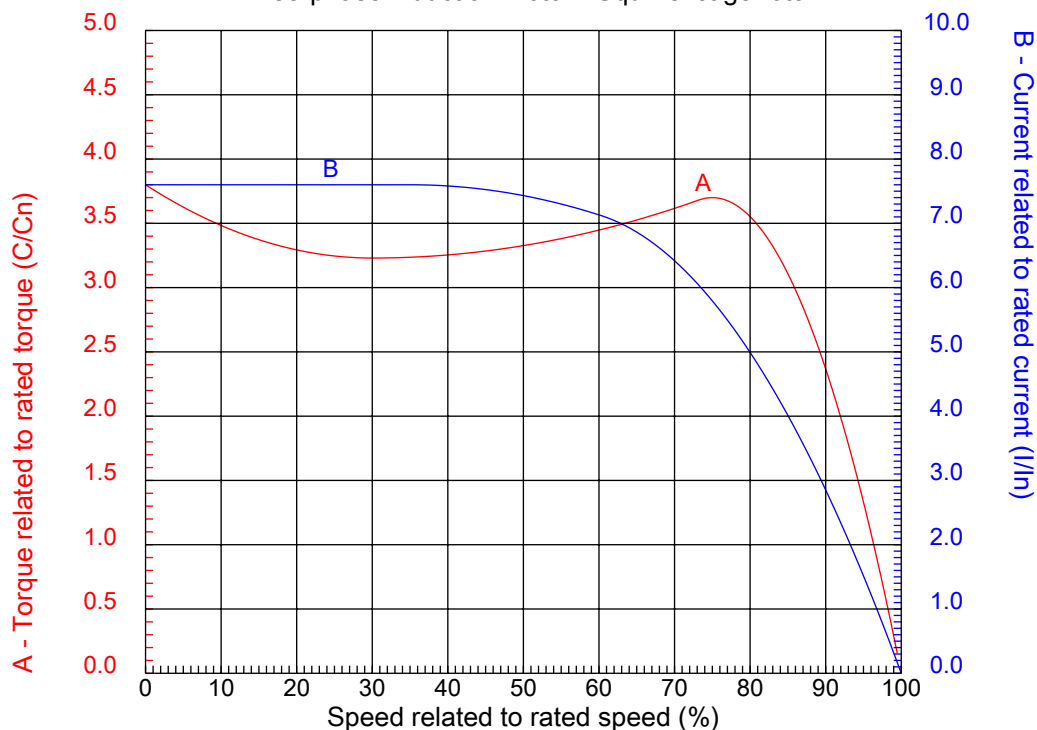

Customer :  
Product line : Three-Phase: W21 IE3 IEC Tru-Metric - TEFC (IP55) Multi-Mounting Aluminum Frame

Frame	: 100L	Locked rotor current (I <sub>l</sub> /I <sub>n</sub> )	: 7.6
Output	: 3 HP	Duty cycle	: S1
Frequency	: 60 Hz	Service factor	: 1.25
Full load speed	: 1740	Design	: N
Voltage	: 460 V	Locked rotor torque	: 380 %
Rated current	: 3.91 A	Breakdown torque	: 370 %
Insulation class	: F		

Notes:

Performed by

Checked

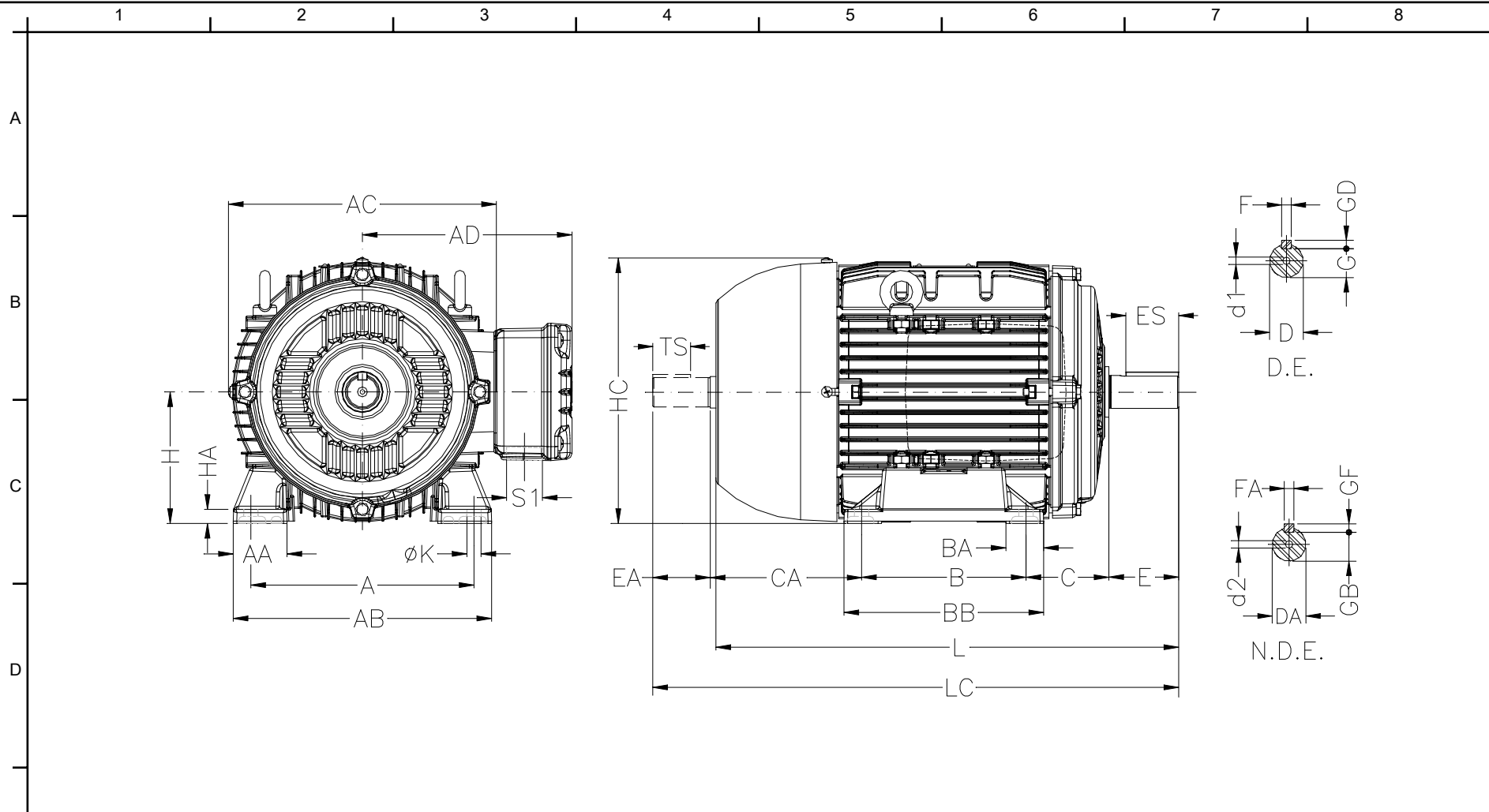

	A	AA	AB	AC	AD	Notes:
E	160	40	196	200	165	
	B	BA	BB	C	CA	Performed by:
	140	30	170	63	118	
	D	E	ES	F	G	Checked:
	28j6	60	45	8	24	
	GD	DA	EA	TS	FA	Customer:
	7	22j6	50	36	6	
	GB	GF	H	HA	HC	Three-Phase: W21 IE3 IEC Tru-Metric - TEFC (IP55) Multi-Mounting Aluminum
	18.5	6	100	12	198	
	HD	K	L	LC	S1	Three-phase induction motor
F	260	12	376	431	NPT 3/4"	
	d1	d2	Flange	LA	M	Frame 100L - IP55
	DM10	DM8	FF-215	11	215	
	N	P	T	S	Angle	24-DEC-2012
	180	250	4	15	45°	
	Holes					
	4					