



No.:

Date: 31-DEC-2012

Customer :

TECHNICAL PROPOSAL

Three-phase induction motor - Squirrel cage rotor

Product line : Cooling Tower Motors : High Efficiency - Two Speed

Catalog Number : 00589EP3QCT215V2

List Price : \$2,262

Notes:

Performed by:

Checked:



No.:

Date: 31-DEC-2012

## DATA SHEET

### Three-phase induction motor - Squirrel cage rotor

Customer :  
Product line : Cooling Tower Motors : High Efficiency - Two Speed

Frame : 215T  
Output : 1.25 HP  
Frequency : 60 Hz  
Poles : 8  
Full load speed : 885  
Slip : 1.67 %  
Voltage : 230 V  
Rated current : 6.13 A  
Locked rotor current : 24.5 A  
Locked rotor current (I<sub>L</sub>/I<sub>n</sub>) : 4.0  
No-load current : 5.20 A  
Full load torque : 7.32 lb.ft  
Locked rotor torque : 180 %  
Breakdown torque : 270 %  
Design : A  
Insulation class : F  
Temperature rise : 80 K  
Locked rotor time : 26 s (hot)  
Service factor : 1.15  
Duty cycle : S1  
Ambient temperature : -20°C - +40°C  
Altitude : 1000  
Degree of Protection : IP55  
Approximate weight : 176 lb  
Moment of inertia : 1.5638 sq.ft.lb  
Noise level : 52 dB(A)

	D.E.	N.D.E.	Load	Power factor	Efficiency (%)
Bearings	6308 2RS	6207 2RS	100%	0.48	78.5
Regreasing interval	---	---	75%	0.39	74.0
Grease amount	---	---	50%	0.30	68.0

Notes:

Performed by

Checked



No.:

Date: 31-DEC-2012

PERFORMANCE CURVES RELATED TO RATED OUTPUT

Three-phase induction motor - Squirrel cage rotor

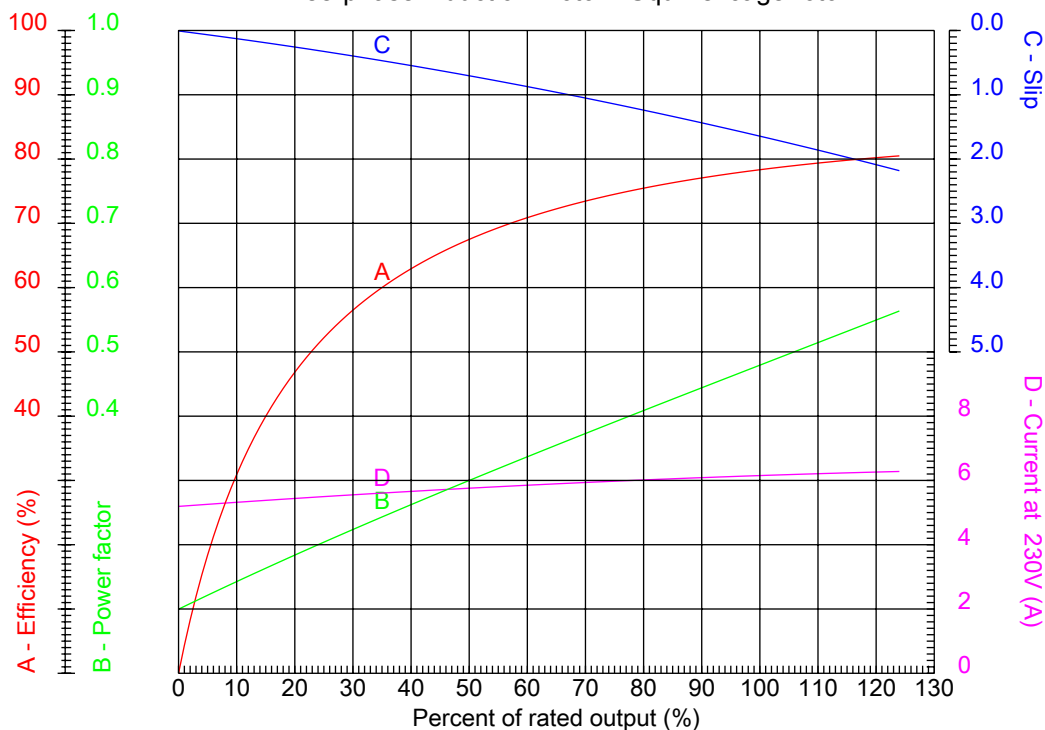

Customer :  
 Product line : Cooling Tower Motors : High Efficiency - Two Speed

Frame	: 215T	Locked rotor current (I <sub>l</sub> /I <sub>n</sub> )	: 4.0
Output	: 1.25 HP	Duty cycle	: S1
Frequency	: 60 Hz	Service factor	: 1.15
Full load speed	: 885	Design	: A
Voltage	: 230 V	Locked rotor torque	: 180 %
Rated current	: 6.13 A	Breakdown torque	: 270 %
Insulation class	: F		

Notes:

Performed by

Checked



No.:

Date: 31-DEC-2012

### CHARACTERISTIC CURVES RELATED TO SPEED

Three-phase induction motor - Squirrel cage rotor

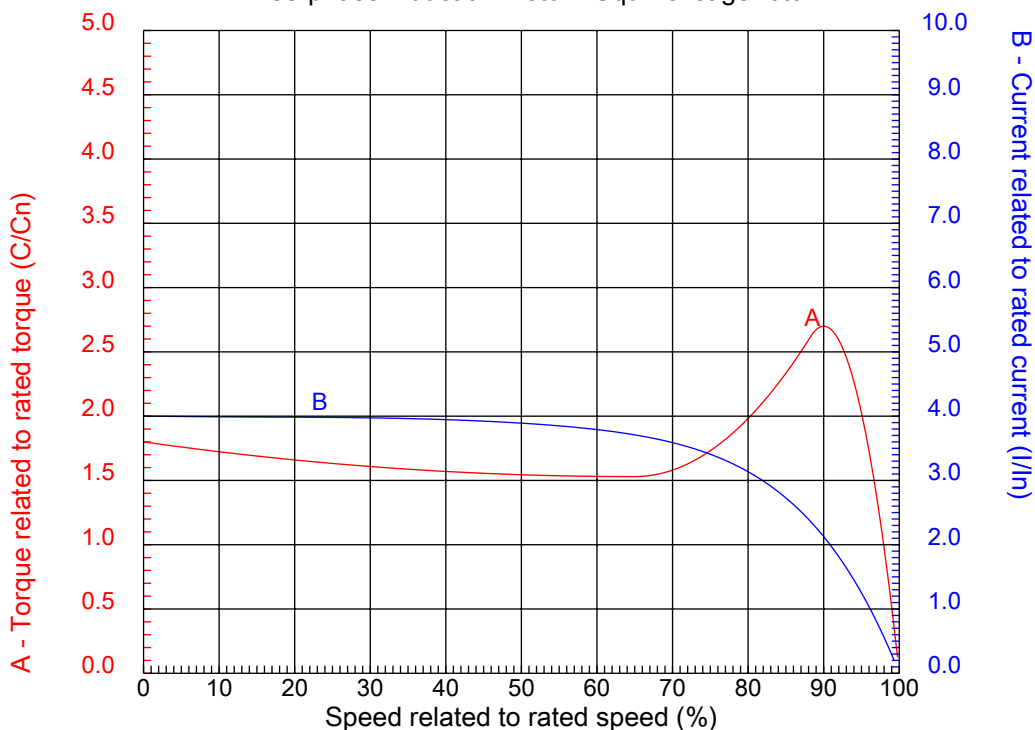

Customer :  
Product line : Cooling Tower Motors : High Efficiency - Two Speed

Frame	: 215T	Locked rotor current (I <sub>l</sub> /I <sub>n</sub> )	: 4.0
Output	: 1.25 HP	Duty cycle	: S1
Frequency	: 60 Hz	Service factor	: 1.15
Full load speed	: 885	Design	: A
Voltage	: 230 V	Locked rotor torque	: 180 %
Rated current	: 6.13 A	Breakdown torque	: 270 %
Insulation class	: F		

Notes:

Performed by

Checked

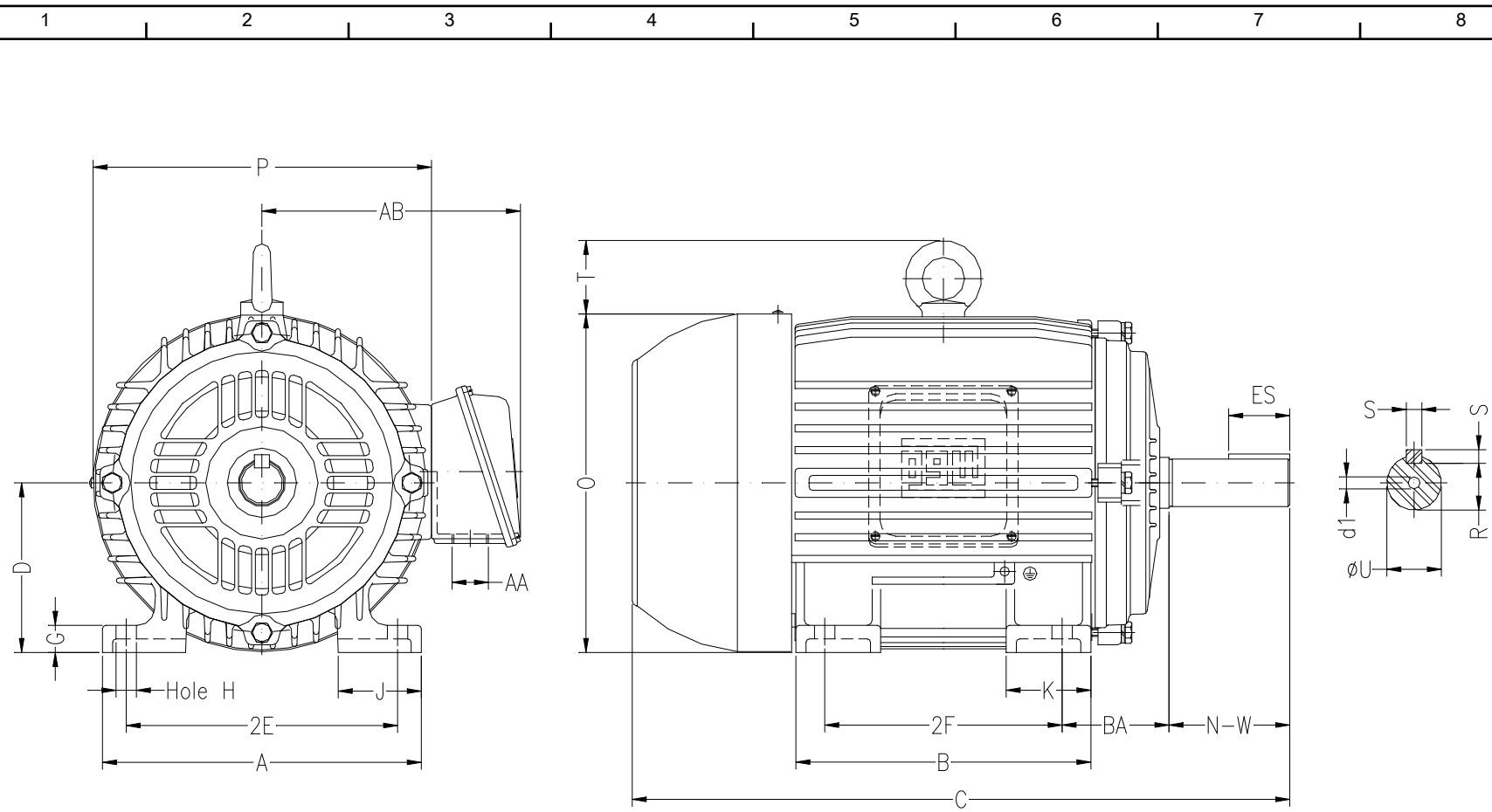

Notes:

Performed by:

Checked:

Customer:

Cooling Tower Motors : High Efficiency - Two Speed

Three-phase induction motor  
Frame 215T - IP55

31-DEC-2012



	2E 8.500	2F 7.000	H 0.406	BA 3.500	A 9.764
	B 8.858	C 19.517	D 5.250	G 0.827	J 2.008
	K 2.165	O 10.841	P 10.630	ES 2.480	S 0.313
F	N-W 3.375	U 1.375	R 1.203	AB 8.149	AA NPT 1"
	d1 A 4	Flange FD-254	AJ 10.000	AK 9.000	BD 11.000
	BF 0.562	BB 0.203			