



No.:

Date: 31-DEC-2012

Customer :

TECHNICAL PROPOSAL

Three-phase induction motor - Squirrel cage rotor

Product line : Cooling Tower Motors : NEMA Premium

Catalog Number : 02012ET3PCT286T

List Price : \$4,635

Notes:

Performed by:

Checked:



No.:

Date: 31-DEC-2012

DATA SHEET

Three-phase induction motor - Squirrel cage rotor

Customer :
Product line : Cooling Tower Motors : NEMA Premium

Frame : 286T
Output : 20 HP
Frequency : 60 Hz
Poles : 6
Full load speed : 1180
Slip : 1.67 %
Voltage : 200 V
Rated current : 55.5 A
Locked rotor current : 427 A
Locked rotor current (I_L/I_n) : 7.7
No-load current : 23.9 A
Full load torque : 87.8 lb.ft
Locked rotor torque : 260 %
Breakdown torque : 280 %
Design : B
Insulation class : F
Temperature rise : 80 K
Locked rotor time : 31 s (hot)
Service factor : 1.25
Duty cycle : S1
Ambient temperature : -20°C - +40°C
Altitude : 1000
Degree of Protection : IP55
Approximate weight : 463 lb
Moment of inertia : 9.1624 sq.ft.lb
Noise level : 59 dB(A)

	D.E.	N.D.E.	Load	Power factor	Efficiency (%)
Bearings	6311 2RS	6211 2RS	100%	0.85	91.7
Regreasing interval	---	---	75%	0.80	91.7
Grease amount	---	---	50%	0.70	90.0

Notes:

Performed by

Checked



No.:

Date: 31-DEC-2012

PERFORMANCE CURVES RELATED TO RATED OUTPUT

Three-phase induction motor - Squirrel cage rotor

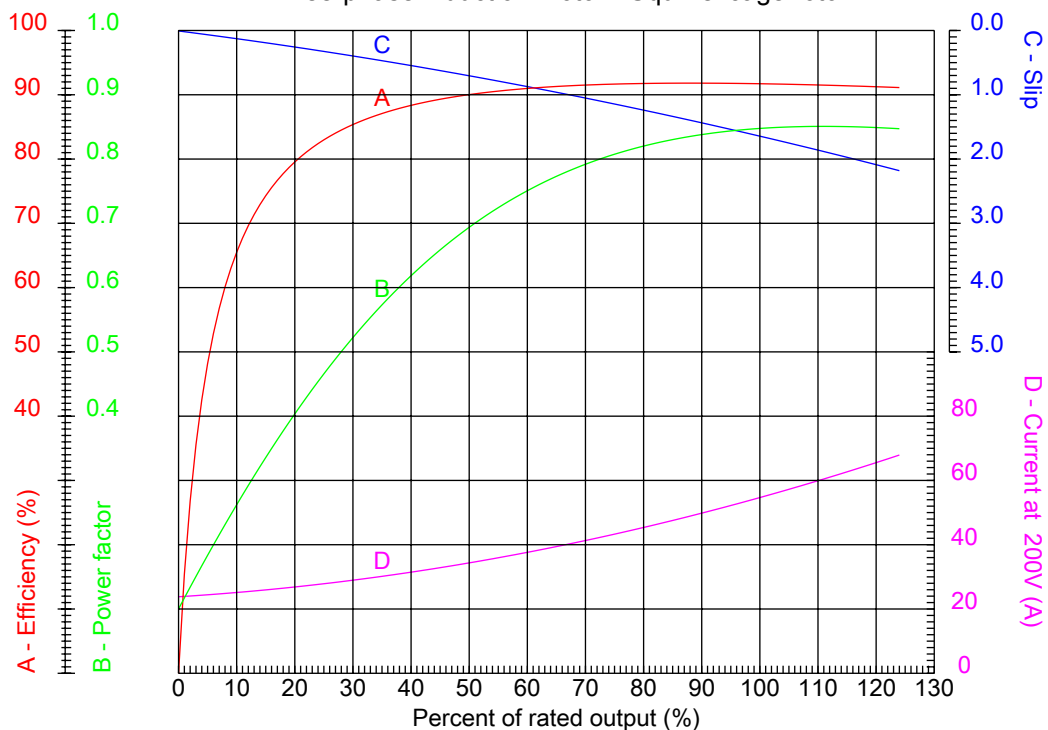

Customer :
Product line : Cooling Tower Motors : NEMA Premium

Frame : 286T	Locked rotor current (I _l /I _n) : 7.7
Output : 20 HP	Duty cycle : S1
Frequency : 60 Hz	Service factor : 1.25
Full load speed : 1180	Design : B
Voltage : 200 V	Locked rotor torque : 260 %
Rated current : 55.5 A	Breakdown torque : 280 %
Insulation class : F	

Notes:

Performed by

Checked



No.:

Date: 31-DEC-2012

CHARACTERISTIC CURVES RELATED TO SPEED Three-phase induction motor - Squirrel cage rotor

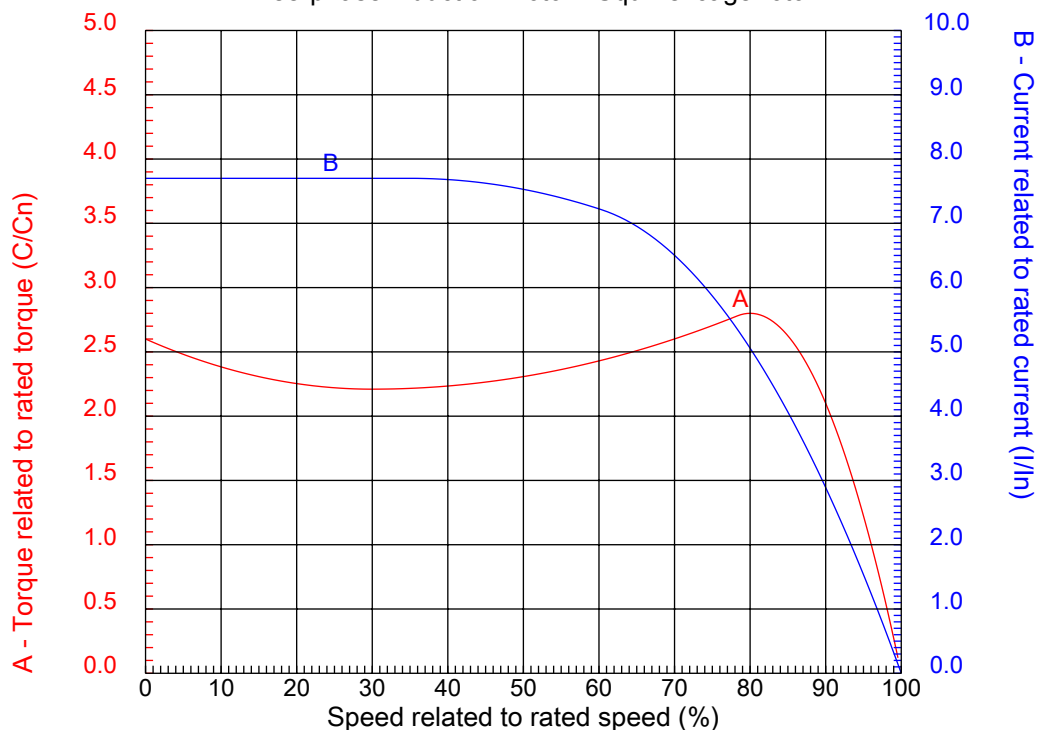

Customer :
Product line : Cooling Tower Motors : NEMA Premium

Frame	: 286T	Locked rotor current (I _l /I _n)	: 7.7
Output	: 20 HP	Duty cycle	: S1
Frequency	: 60 Hz	Service factor	: 1.25
Full load speed	: 1180	Design	: B
Voltage	: 200 V	Locked rotor torque	: 260 %
Rated current	: 55.5 A	Breakdown torque	: 280 %
Insulation class	: F		

Notes:

Performed by

Checked

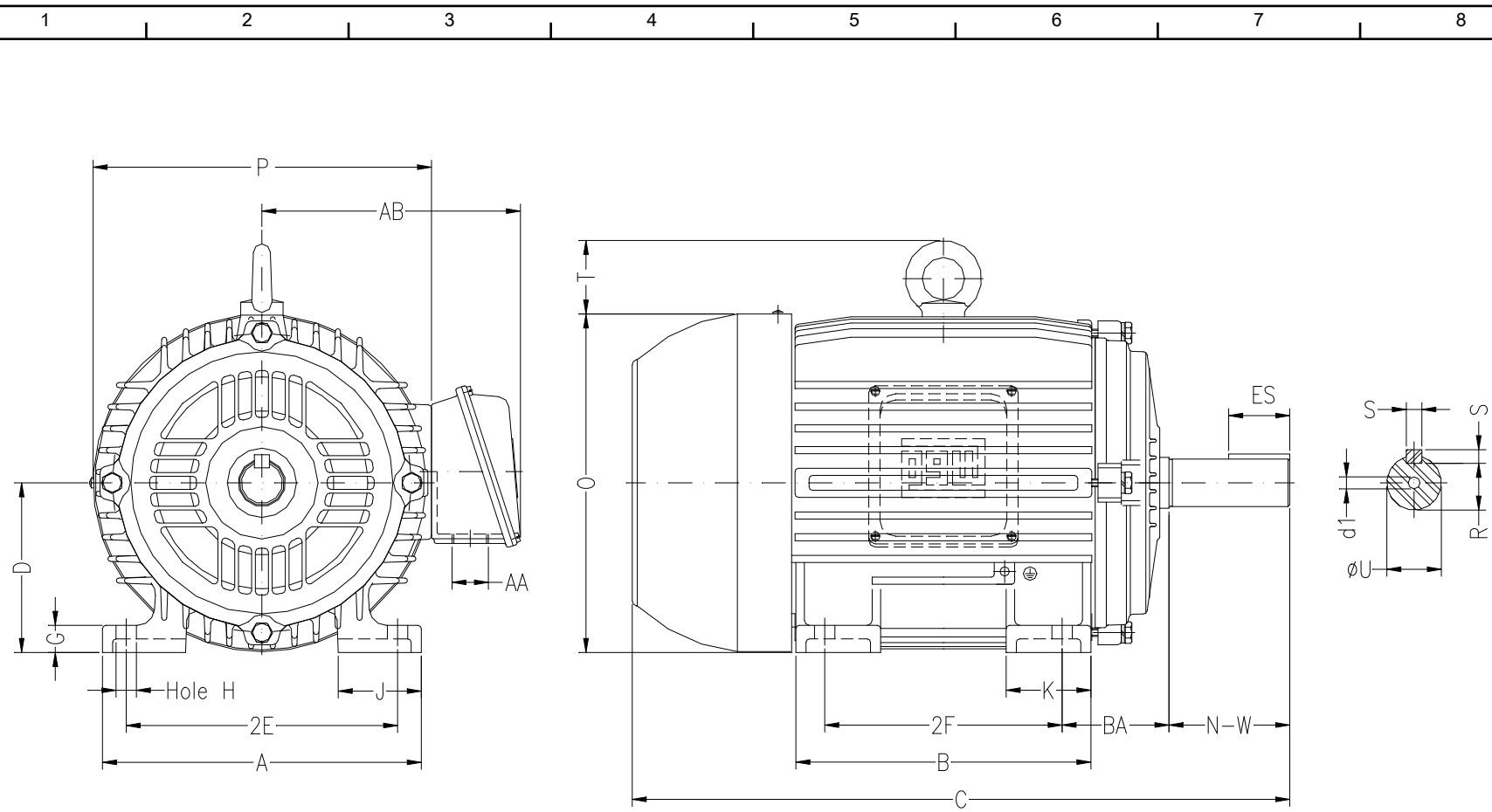

Notes:

Performed by:

Checked:

Customer:

Cooling Tower Motors : NEMA Premium

Three-phase induction motor
Frame 286T - IP55

31-DEC-2012



	2E 11.000	2F 11.000	H 0.531	BA 4.750	A 13.780
	B 13.071	C 27.929	D 7.000	G 1.016	J 3.150
	K 2.953	O 14.067	P 14.094	ES 3.149	S 0.500
F	N-W 4.622	U 1.875	R 1.594	AB 10.866	AA NPT 1 1/2"
	d1 A 4	Flange FD-317	AJ 12.500	AK 11.000	BD 14.000
	BF 0.828	BB 0.203			