



No.:

Date: 31-DEC-2012

Customer :

TECHNICAL PROPOSAL

Three-phase induction motor - Squirrel cage rotor

Product line : Cooling Tower Motors : High Efficiency - Two Speed

Catalog Number : 02589EP3QCT324V2

List Price : \$5,826

Notes:

Performed by:

Checked:



No.:

Date: 31-DEC-2012

DATA SHEET

Three-phase induction motor - Squirrel cage rotor

Customer :
Product line : Cooling Tower Motors : High Efficiency - Two Speed

Frame : 324T
Output : 6.3 HP
Frequency : 60 Hz
Poles : 8
Full load speed : 890
Slip : 1.11 %
Voltage : 230 V
Rated current : 28.3 A
Locked rotor current : 122 A
Locked rotor current (I_L/I_n) : 4.3
No-load current : 22.0 A
Full load torque : 36.7 lb.ft
Locked rotor torque : 200 %
Breakdown torque : 260 %
Design : A
Insulation class : F
Temperature rise : 80 K
Locked rotor time : 16 s (hot)
Service factor : 1.15
Duty cycle : S1
Ambient temperature : -20°C - +40°C
Altitude : 1000
Degree of Protection : IP55
Approximate weight : 501 lb
Moment of inertia : 7.8523 sq.ft.lb
Noise level : 56 dB(A)

	D.E.	N.D.E.	Load	Power factor	Efficiency (%)
Bearings	6312 2RS	6212 2RS	100%	0.50	81.5
Regreasing interval	---	---	75%	0.42	80.0
Grease amount	---	---	50%	0.31	74.0

Notes:

Performed by

Checked



No.:

Date: 31-DEC-2012

PERFORMANCE CURVES RELATED TO RATED OUTPUT

Three-phase induction motor - Squirrel cage rotor

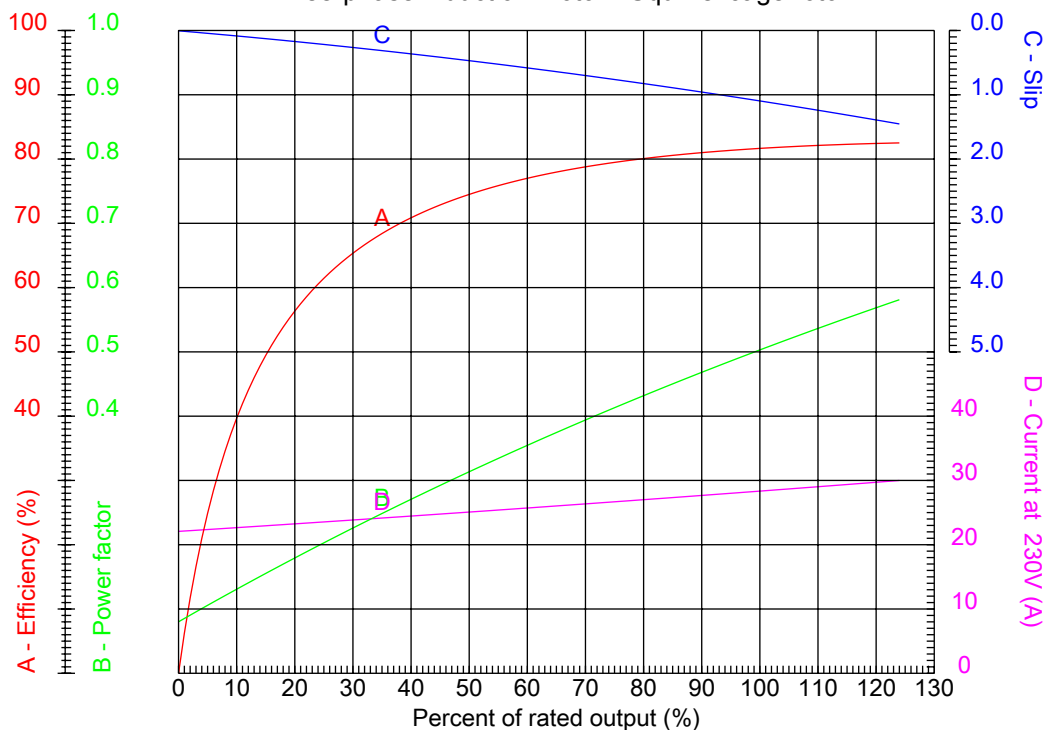

Customer :
 Product line : Cooling Tower Motors : High Efficiency - Two Speed

Frame : 324T	Locked rotor current (I _l /I _n) : 4.3
Output : 6.3 HP	Duty cycle : S1
Frequency : 60 Hz	Service factor : 1.15
Full load speed : 890	Design : A
Voltage : 230 V	Locked rotor torque : 200 %
Rated current : 28.3 A	Breakdown torque : 260 %
Insulation class : F	

Notes:

Performed by

Checked



No.:

Date: 31-DEC-2012

CHARACTERISTIC CURVES RELATED TO SPEED

Three-phase induction motor - Squirrel cage rotor

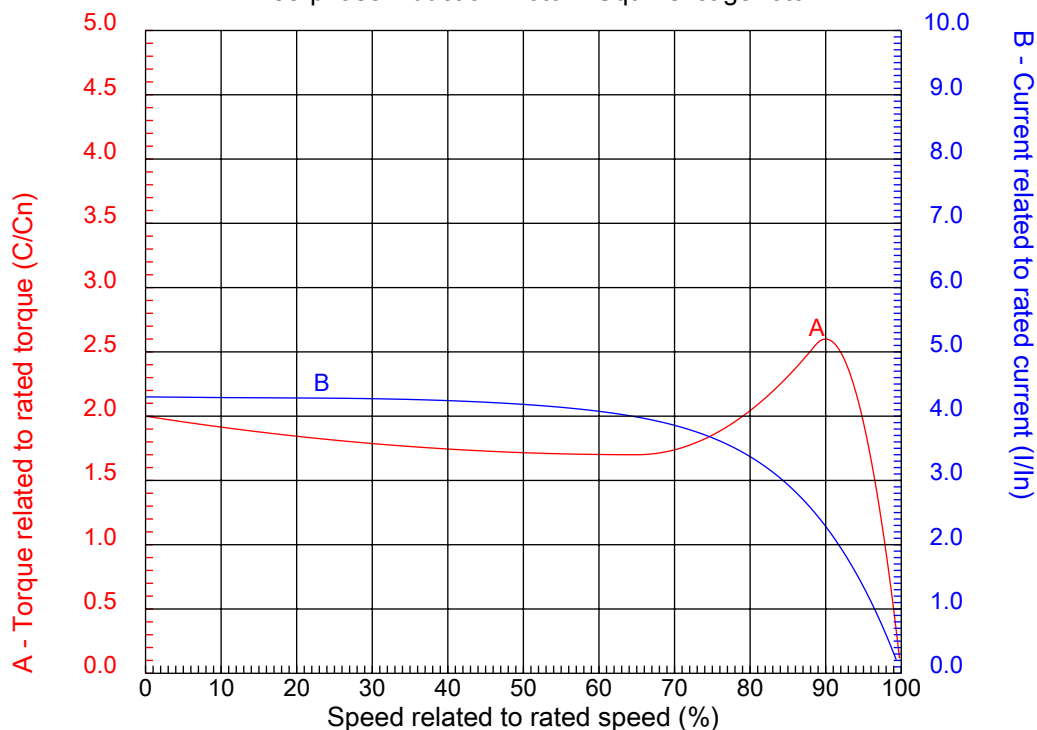

Customer :
Product line : Cooling Tower Motors : High Efficiency - Two Speed

Frame	: 324T	Locked rotor current (I _l /I _n)	: 4.3
Output	: 6.3 HP	Duty cycle	: S1
Frequency	: 60 Hz	Service factor	: 1.15
Full load speed	: 890	Design	: A
Voltage	: 230 V	Locked rotor torque	: 200 %
Rated current	: 28.3 A	Breakdown torque	: 260 %
Insulation class	: F		

Notes:

Performed by

Checked

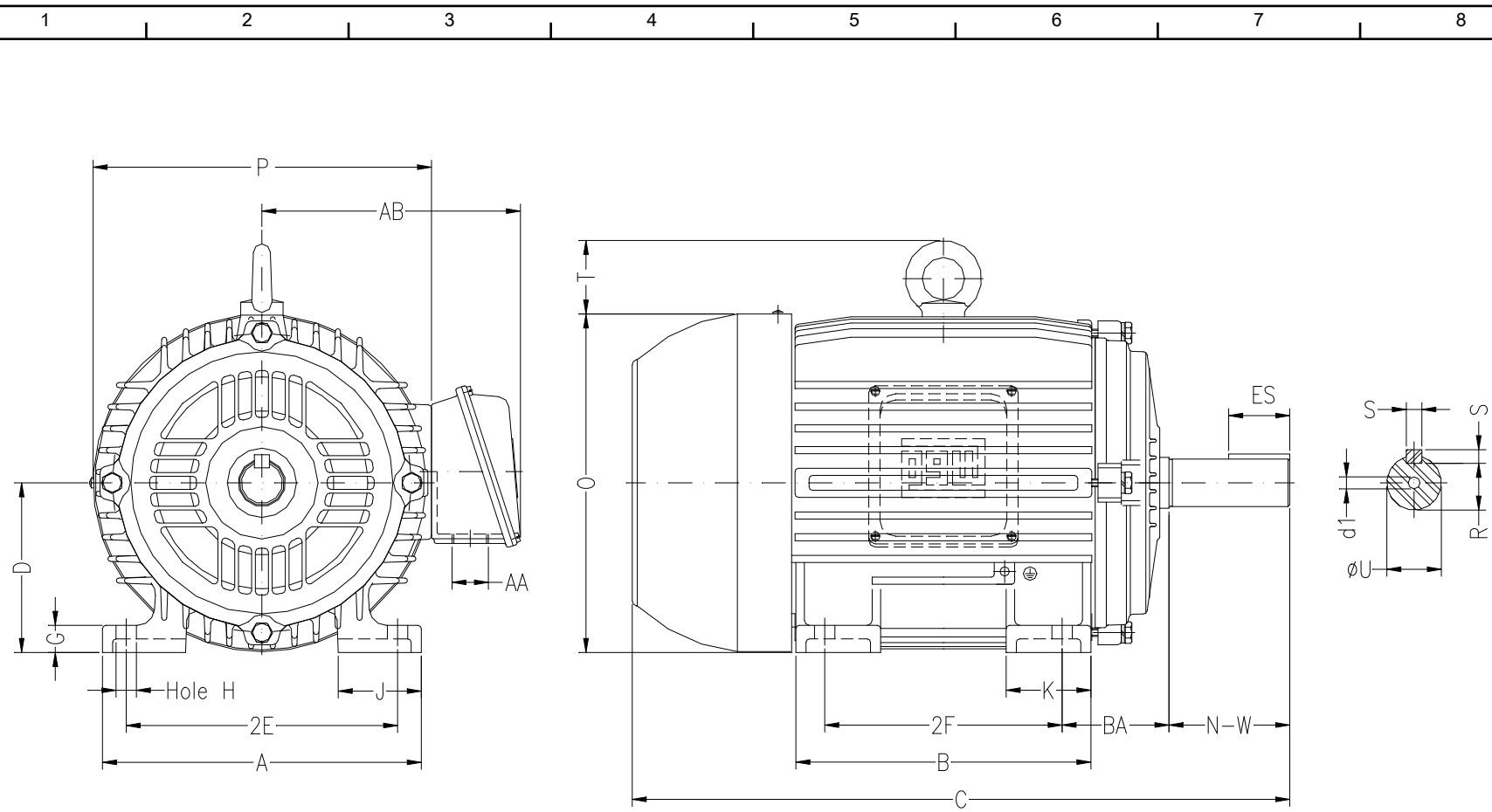

Notes:

Performed by:

Checked:

Customer:

Cooling Tower Motors : High Efficiency - Two Speed

Three-phase induction motor
Frame 324T - IP55

31-DEC-2012



	2E 12.500	2F 10.500	H 0.657	BA 5.250	A 15.157
	B 13.071	C 29.620	D 8.000	G 1.307	J 3.228
	K 3.346	O 15.953	P 15.591	ES 3.937	S 0.500
F	N-W 5.250	U 2.125	R 1.844	AB 11.496	AA NPT 2"
	d1 A 4	Flange FD-406	AJ 16.000	AK 14.000	BD 18.000
	BF 0.828	BB 0.203			