



No.:

Date: 31-DEC-2012

Customer :

TECHNICAL PROPOSAL

Three-phase induction motor - Squirrel cage rotor

Product line : Cooling Tower Motors : High Efficiency - Two Speed

Catalog Number : 03089EP3PCT326V2

List Price : \$6,995

Notes:

Performed by:

Checked:



No.:

Date: 31-DEC-2012

## DATA SHEET

### Three-phase induction motor - Squirrel cage rotor

Customer :  
Product line : Cooling Tower Motors : High Efficiency - Two Speed

Frame : 326T  
Output : 7.5 HP  
Frequency : 60 Hz  
Poles : 8  
Full load speed : 890  
Slip : 1.11 %  
Voltage : 200 V  
Rated current : 40.6 A  
Locked rotor current : 170 A  
Locked rotor current (I<sub>L</sub>/I<sub>n</sub>) : 4.2  
No-load current : 27.6 A  
Full load torque : 43.7 lb.ft  
Locked rotor torque : 220 %  
Breakdown torque : 250 %  
Design : A  
Insulation class : F  
Temperature rise : 80 K  
Locked rotor time : 17 s (hot)  
Service factor : 1.15  
Duty cycle : S1  
Ambient temperature : -20°C - +40°C  
Altitude : 1000  
Degree of Protection : IP55  
Approximate weight : 595 lb  
Moment of inertia : 9.1622 sq.ft.lb  
Noise level : 56 dB(A)

	D.E.	N.D.E.	Load	Power factor	Efficiency (%)
Bearings	6312 2RS	6212 2RS	100%	0.48	81.5
Regreasing interval	---	---	75%	0.40	78.5
Grease amount	---	---	50%	0.30	74.0

Notes:

Performed by

Checked



No.:

Date: 31-DEC-2012

### PERFORMANCE CURVES RELATED TO RATED OUTPUT

Three-phase induction motor - Squirrel cage rotor

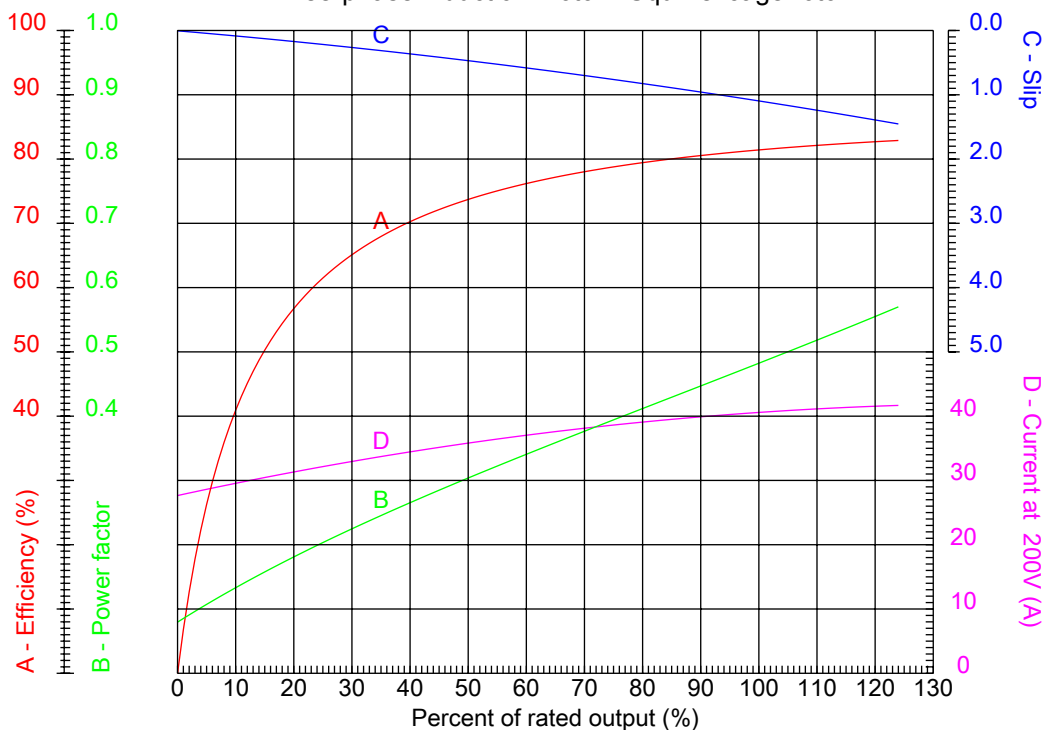

Customer :  
Product line : Cooling Tower Motors : High Efficiency - Two Speed

Frame	: 326T	Locked rotor current (I <sub>l</sub> /I <sub>n</sub> )	: 4.2
Output	: 7.5 HP	Duty cycle	: S1
Frequency	: 60 Hz	Service factor	: 1.15
Full load speed	: 890	Design	: A
Voltage	: 200 V	Locked rotor torque	: 220 %
Rated current	: 40.6 A	Breakdown torque	: 250 %
Insulation class	: F		

Notes:

Performed by

Checked



No.:

Date: 31-DEC-2012

### CHARACTERISTIC CURVES RELATED TO SPEED

Three-phase induction motor - Squirrel cage rotor

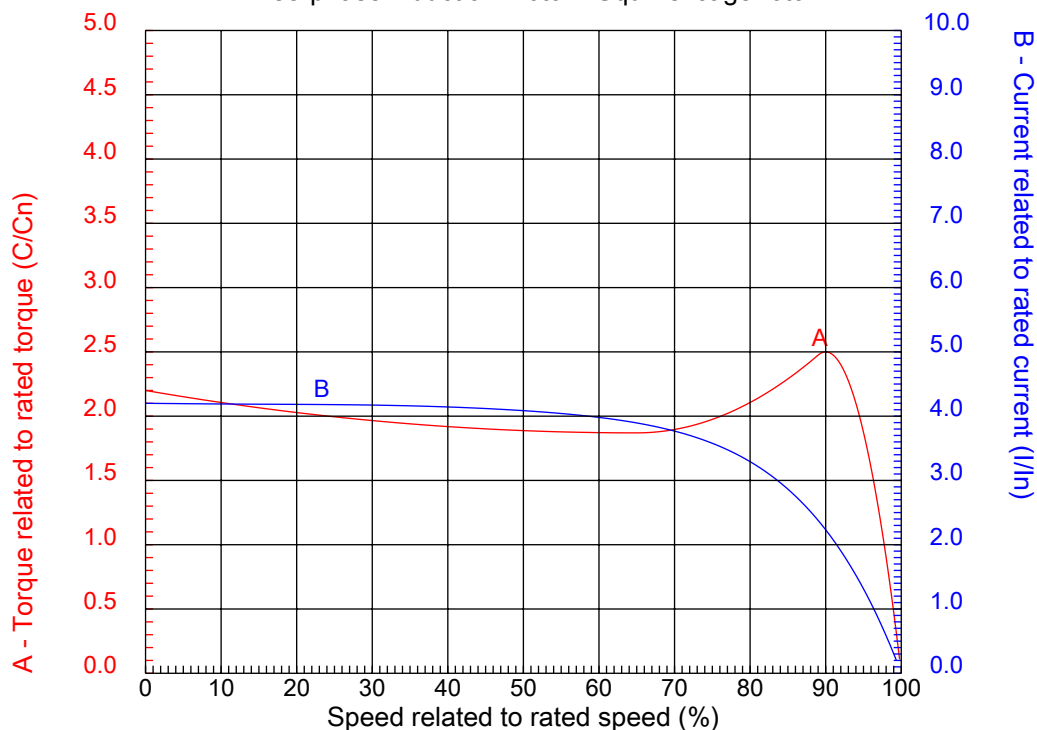

Customer :  
Product line : Cooling Tower Motors : High Efficiency - Two Speed

Frame	: 326T	Locked rotor current (I <sub>l</sub> /I <sub>n</sub> )	: 4.2
Output	: 7.5 HP	Duty cycle	: S1
Frequency	: 60 Hz	Service factor	: 1.15
Full load speed	: 890	Design	: A
Voltage	: 200 V	Locked rotor torque	: 220 %
Rated current	: 40.6 A	Breakdown torque	: 250 %
Insulation class	: F		

Notes:

Performed by

Checked

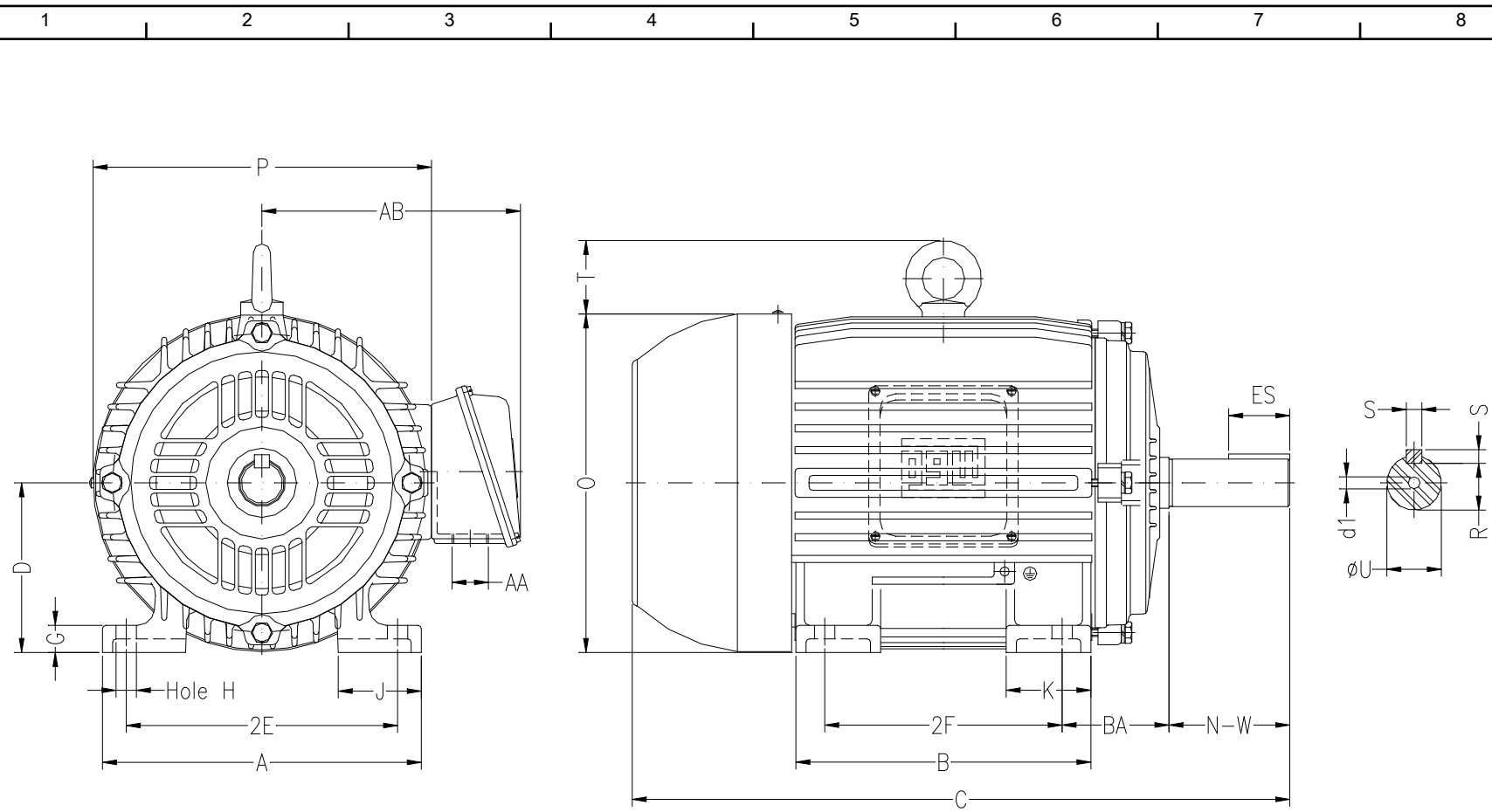

Notes:

Performed by:

Checked:

Customer:

Cooling Tower Motors : High Efficiency - Two Speed

Three-phase induction motor  
Frame 326T - IP55

31-DEC-2012



2E 12.500	2F 12.000	H 0.657	BA 5.250	A 15.157
B 14.567	C 31.116	D 8.000	G 1.307	J 3.228
K 3.346	O 15.953	P 15.591	ES 3.937	S 0.500
N-W 5.250	U 2.125	R 1.844	AB 11.496	AA NPT 2"
d1 A 4	Flange FD-406	AJ 16.000	AK 14.000	BD 18.000
BF 0.828	BB 0.203			