



No.:

Date: 31-DEC-2012

Customer :

TECHNICAL PROPOSAL

Three-phase induction motor - Squirrel cage rotor

Product line : Cooling Tower Motors : High Efficiency - Two Speed

Catalog Number : 04089EP3PCT326V

List Price : \$5,464

Notes:

Performed by:

Checked:



No.:

Date: 31-DEC-2012

DATA SHEET

Three-phase induction motor - Squirrel cage rotor

Customer :
 Product line : Cooling Tower Motors : High Efficiency - Two Speed

Frame : 326T
 Output : 10 HP
 Frequency : 60 Hz
 Poles : 8
 Full load speed : 885
 Slip : 1.67 %
 Voltage : 200 V
 Rated current : 41.4 A
 Locked rotor current : 128 A
 Locked rotor current (I_L/I_n) : 3.1
 No-load current : 23.0 A
 Full load torque : 58.5 lb.ft
 Locked rotor torque : 160 %
 Breakdown torque : 170 %
 Design : A
 Insulation class : F
 Temperature rise : 80 K
 Locked rotor time : 50 s (hot)
 Service factor : 1.15
 Duty cycle : S1
 Ambient temperature : -20°C - +40°C
 Altitude : 1000
 Degree of Protection : IP55
 Approximate weight : 595 lb
 Moment of inertia : 9.1622 sq.ft.lb
 Noise level : 56 dB(A)

	D.E.	N.D.E.	Load	Power factor	Efficiency (%)
Bearings	6312 2RS	6212 2RS	100%	0.60	87.0
Regreasing interval	---	---	75%	0.56	87.0
Grease amount	---	---	50%	0.45	85.0

Notes:

Performed by

Checked



No.:

Date: 31-DEC-2012

PERFORMANCE CURVES RELATED TO RATED OUTPUT

Three-phase induction motor - Squirrel cage rotor

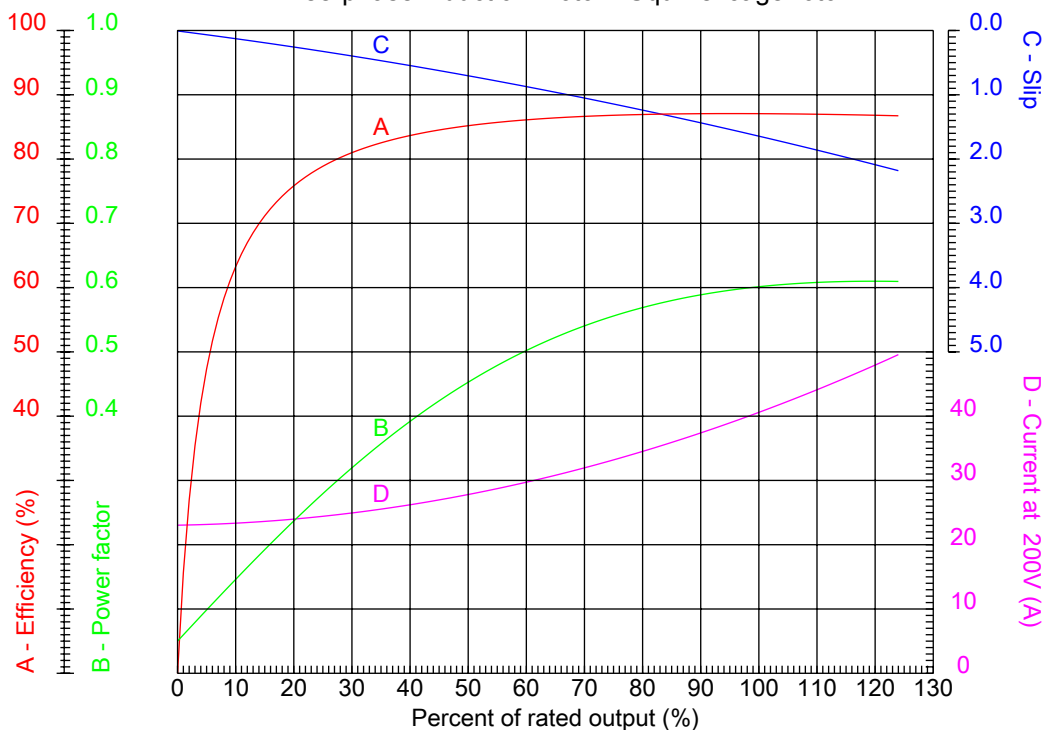

Customer :
Product line : Cooling Tower Motors : High Efficiency - Two Speed

Frame	: 326T	Locked rotor current (I _l /I _n)	: 3.1
Output	: 10 HP	Duty cycle	: S1
Frequency	: 60 Hz	Service factor	: 1.15
Full load speed	: 885	Design	: A
Voltage	: 200 V	Locked rotor torque	: 160 %
Rated current	: 41.4 A	Breakdown torque	: 170 %
Insulation class	: F		

Notes:

Performed by

Checked



No.:

Date: 31-DEC-2012

CHARACTERISTIC CURVES RELATED TO SPEED

Three-phase induction motor - Squirrel cage rotor

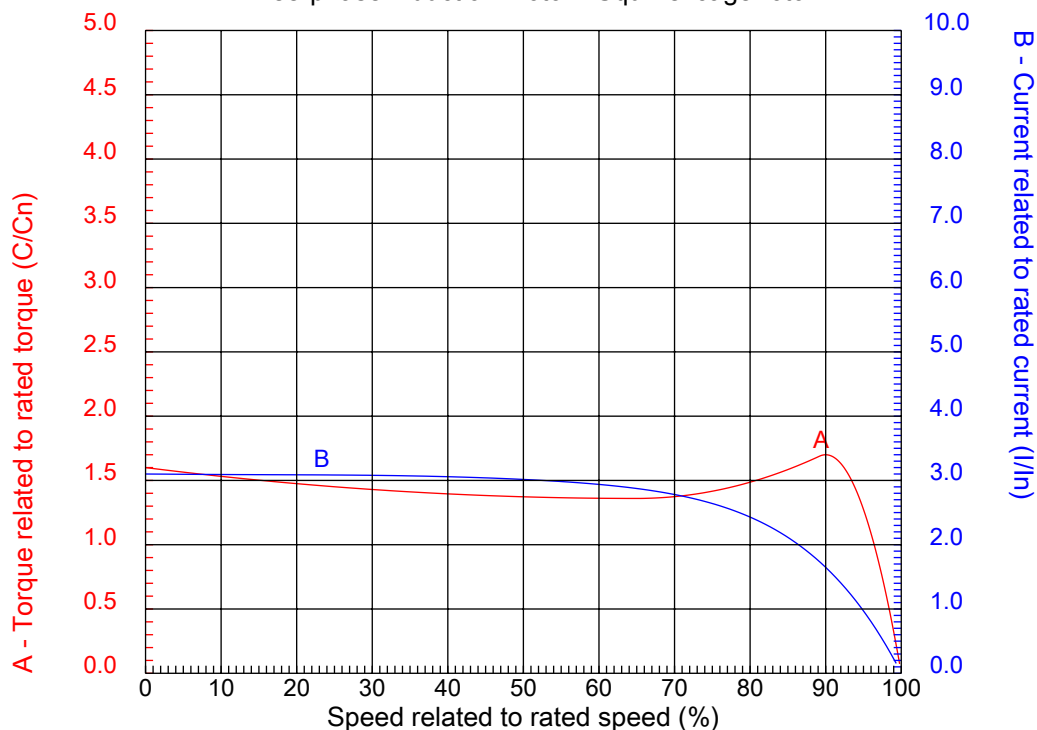

Customer :
Product line : Cooling Tower Motors : High Efficiency - Two Speed

Frame	: 326T	Locked rotor current (I _l /I _n)	: 3.1
Output	: 10 HP	Duty cycle	: S1
Frequency	: 60 Hz	Service factor	: 1.15
Full load speed	: 885	Design	: A
Voltage	: 200 V	Locked rotor torque	: 160 %
Rated current	: 41.4 A	Breakdown torque	: 170 %
Insulation class	: F		

Notes:

Performed by

Checked

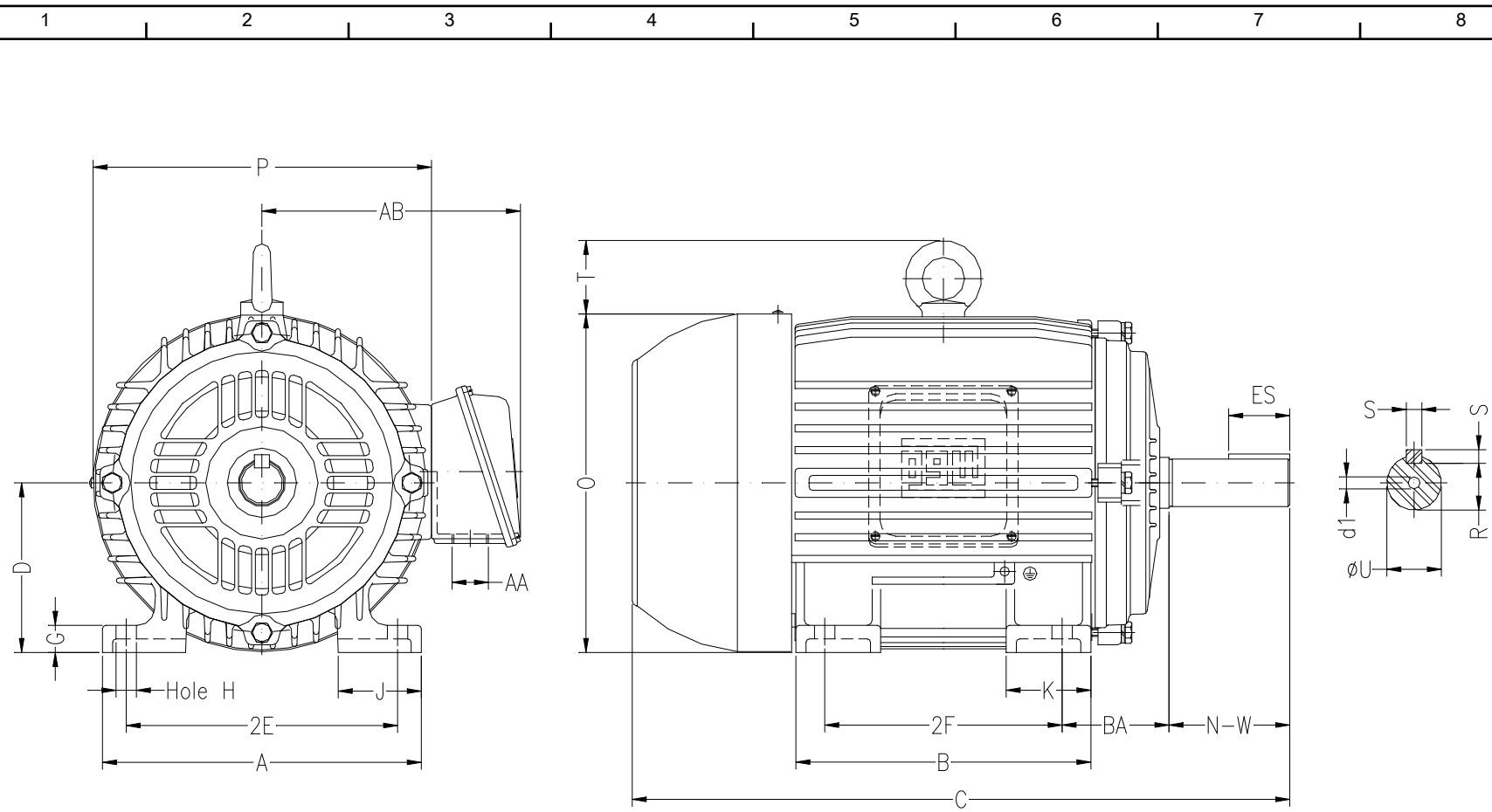

Notes:

Performed by:

Checked:

Customer:

Cooling Tower Motors : High Efficiency - Two Speed

Three-phase induction motor
Frame 326T - IP55

31-DEC-2012



2E 12.500	2F 12.000	H 0.657	BA 5.250	A 15.157
B 14.567	C 31.116	D 8.000	G 1.307	J 3.228
K 3.346	O 15.953	P 15.591	ES 3.937	S 0.500
N-W 5.250	U 2.125	R 1.844	AB 11.496	AA NPT 2"
d1 A 4	Flange FD-406	AJ 16.000	AK 14.000	BD 18.000
BF 0.828	BB 0.203			