



No.:

Date: 17-DEC-2012

Customer :

TECHNICAL PROPOSAL

Three-phase induction motor - Squirrel cage rotor

Product line : Three-Phase : Rolled Steel Motor - NEMA Premium Efficiency

Catalog Number : 00218ET3ERS145T

List Price : \$533

Notes:

Performed by:

Checked:



No.:

Date: 17-DEC-2012

DATA SHEET

Three-phase induction motor - Squirrel cage rotor

Customer :
 Product line : Three-Phase : Rolled Steel Motor - NEMA Premium Efficiency

Frame : 143/5T
 Output : 2 HP
 Frequency : 60 Hz
 Poles : 4
 Full load speed : 1750
 Slip : 2.78 %
 Voltage : 208-230/460 V
 Rated current : 5.90-5.70/2.85 A
 Locked rotor current : 49.6/24.8 A
 Locked rotor current (I_L/I_n) : 8.7
 No-load current : 3.30/1.65 A
 Full load torque : 5.92 lb.ft
 Locked rotor torque : 390 %
 Breakdown torque : 390 %
 Design : B
 Insulation class : F
 Temperature rise : 80 K
 Locked rotor time : 15 s (hot)
 Service factor : 1.15 (1.00 at 208V)
 Duty cycle : S1
 Ambient temperature : -20°C - +40°C
 Altitude : 1000
 Degree of Protection : IP55
 Approximate weight : 42 lb
 Moment of inertia : 0.17750 sq.ft.lb
 Noise level : ---

	D.E.	N.D.E.	Load	Power factor	Efficiency (%)
Bearings	6205 ZZ	6203 ZZ	100%	0.77	86.5
Regreasing interval	---	---	75%	0.69	85.5
Grease amount	---	---	50%	0.56	81.5

Notes:

Performed by

Checked



No.:

Date: 17-DEC-2012

PERFORMANCE CURVES RELATED TO RATED OUTPUT

Three-phase induction motor - Squirrel cage rotor

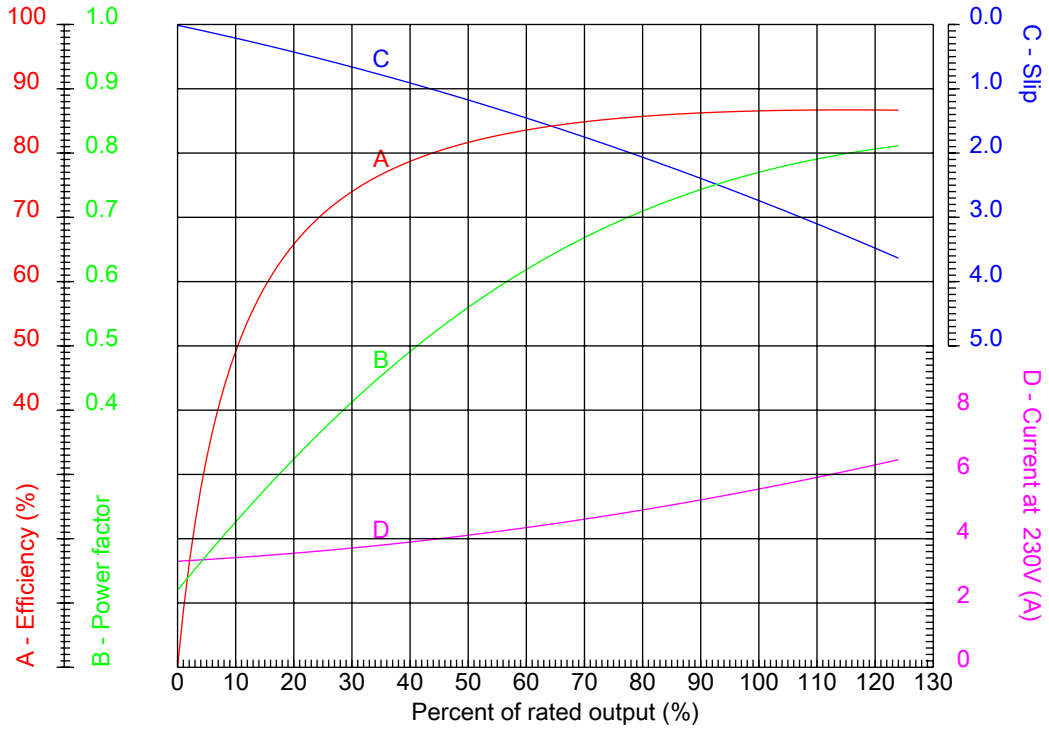

Customer :
 Product line : Three-Phase : Rolled Steel Motor - NEMA Premium Efficiency

Frame	: 143/5T	Locked rotor current (I _l /I _n)	: 8.7
Output	: 2 HP	Duty cycle	: S1
Frequency	: 60 Hz	Service factor	: 1.15 (1.00 at 208V)
Full load speed	: 1750	Design	: B
Voltage	: 208-230/460 V	Locked rotor torque	: 390 %
Rated current	: 5.90-5.70/2.85 A	Breakdown torque	: 390 %
Insulation class	: F		

Notes:

Performed by

Checked



No.:

Date: 17-DEC-2012

CHARACTERISTIC CURVES RELATED TO SPEED

Three-phase induction motor - Squirrel cage rotor

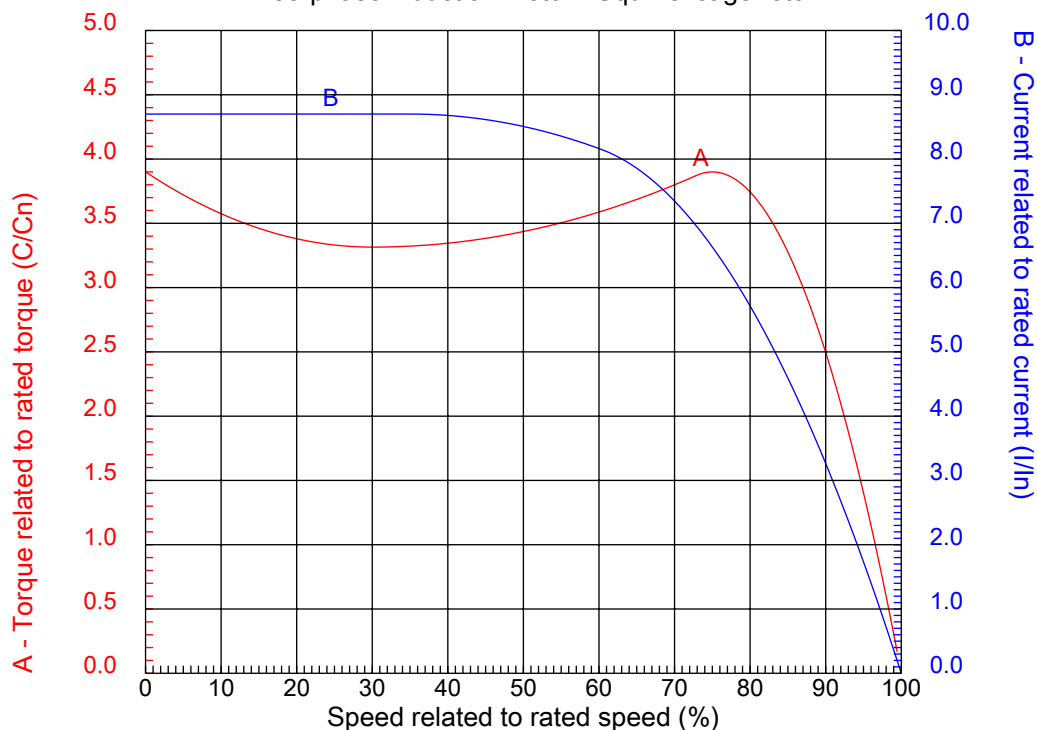

Customer :
Product line : Three-Phase : Rolled Steel Motor - NEMA Premium Efficiency

Frame	: 143/5T	Locked rotor current (I _l /I _n)	: 8.7
Output	: 2 HP	Duty cycle	: S1
Frequency	: 60 Hz	Service factor	: 1.15 (1.00 at 208V)
Full load speed	: 1750	Design	: B
Voltage	: 208-230/460 V	Locked rotor torque	: 390 %
Rated current	: 5.90-5.70/2.85 A	Breakdown torque	: 390 %
Insulation class	: F		

Notes:

Performed by

Checked

1 2 3 4 5 6 7 8

A
B
C
D
E
F

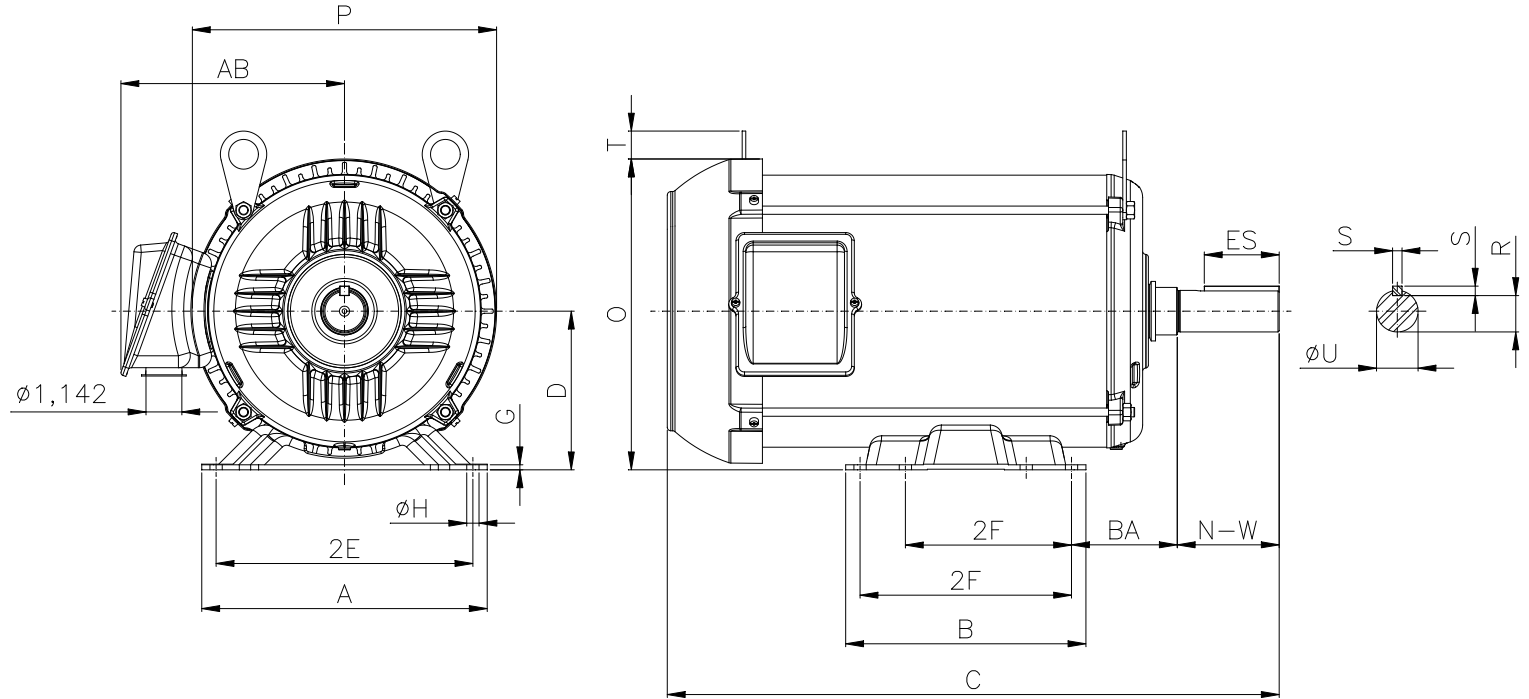

Notes:

Performed by:

Checked:

Customer:

Three-Phase : Rolled Steel Motor - NEMA Premium Efficiency

2E	J	A	P	2F
5.500	1.220	6.535	7.323	4.000/5.000
K	B	BA	FBA	U
5.000	6.496	2.250	4.724	0.8750
N-W	ES	S	R	depth
2.250	1.417	0.187	0.766	0.187
D	G	O	T	H
3.500	3.04	7.165	1.063	0.342
C	FC	Flange	AJ	AK
14.488	8.268	FC-149	5.875	4.500
BD	BF	BB	BC	AH
6.535	UNC 3/8"x16	0.157	9	

Three-phase induction motor
Frame 143/5T - IP55

17-DEC-2012

