



KING ELECTRICAL MFG. CO. · SEATTLE, WA 98108

BKT2BW

IN-BUILT THERMOSTAT KIT FOR KING
MODELS **K** & **CB** SERIES BASEBOARDS
MOUNTED ON J-BOX COVER - DOUBLE POLE



CERTIFIED TO
CSA C22.2
NO. 46

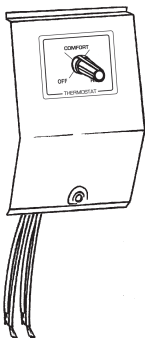

DANGER: RISK OF SEVERE ELECTRICAL SHOCK. DISCONNECT
POWER FROM MAIN BREAKER PANEL FIRST BEFORE INSTALLATION.

BRIGHT



WHITE

1. Connect the two red thermostat wires to the black and white supply wires.
2. Connect the two black thermostat wires to the two heater wires.
3. Bare ground wire to green ground wire.

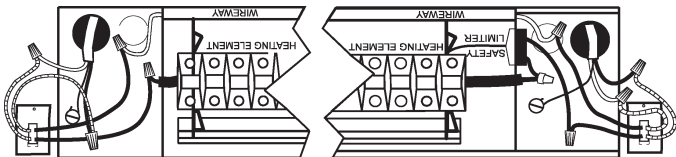

Connection Diagram for BKT2BW Thermostat:

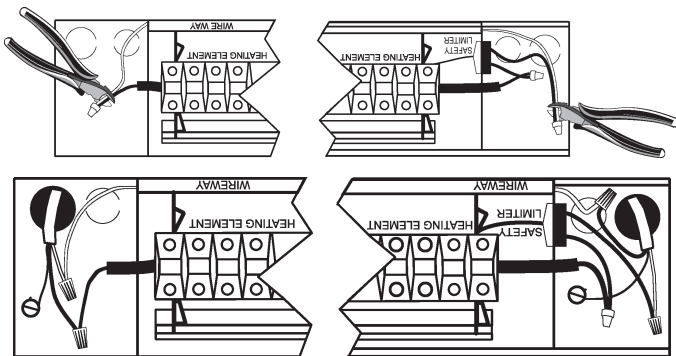

Instructions For Left or Right Side Wiring:

- *Caution: Do not cut both factory splice caps on left side, you need only two wires for power connection.
1. Heater can be wired from either side, wire one side only.
 2. Cut one factory splice cap as shown.
 3. This leaves two wires for power connection: one wire for an inline switch connection to power supply and the other wire for a second power line or common wire.

WIRING DIAGRAM:

TEMPERATURE RANGE: 40°-90° F
 FOR USE WITH: 120, 208, 240 VAC / 22 AMP
 277 VAC / 18 AMP

DIRECTIONS:

The King BKT2BW thermostat, for the K & CB Series baseboard heaters, may be mounted in either the left or right junction box of the heater. To mount the thermostat, remove the junction box cover from the end of the heater and discard. Wire the new BKT2BW thermostat junction box cover in accordance with the wiring diagram on the opposite side. Screw cover in place.

COMMONLY ASKED QUESTIONS & TROUBLESHOOTING

- Q.** Will the room heat up faster with the thermostat turned up to 90°?
- A.** No, the heater is always on full wattage when the temperature is below the preset temperature. The thermostat shuts off when the preset temperature is reached, therefore set the thermostat to the desired comfort level, not above.
- Q.** Will the electricity bill be lower using 120V heaters?
- A.** No, electricity is billed by kilowatt hours, voltage makes no difference. Typically, baseboard heaters are 240V because of wiring capacity, i.e. 240V heaters draw less amps than 120V heaters.
- Q.** What is the difference between a two pole and a single pole thermostat?
- A.** A single pole has no positive off position. That means when the knob is turned all the way to the left (counterclockwise), it has a low setting. A two pole thermostat breaks an additional line when the knob is turned to the off position. The heater will not turn on with the knob in the off position regardless of temperature drop.
- Q.** Which power lead do I hook-up to the thermostat on a 240V heater?
- A.** It does not matter. On a 240V system, both leads are the same (hot), so either one can be connected through to the thermostat.
- Q.** I have a black hot lead, red hot lead and a white neutral wire in my wall. Where do I hook up the white neutral wire on my 240V heater?
- A.** In 240V systems, the energy is used in the heater, so no neutral wire is required. Isolate the neutral wire by capping it.

SYMPTOM	PROBLEM	SOLUTION
Breaker Trips	<ol style="list-style-type: none">1. Short Circuit2. Overloaded Circuit3. Improper Voltage	<ol style="list-style-type: none">1. Find source of short, trace heater circuit and verify that heater is wired properly.2. Reduce wattage in circuit.3. Verify heater voltage matches supply voltage.
Heater Not Working	<ol style="list-style-type: none">1. No Power2. Loose Connections3. Defective Limit	<ol style="list-style-type: none">1. Turn breaker and thermostat on. Check that breaker is positioned properly on panel bus-bar.2. Tighten wire connections.3. By-pass limit to test. If heater works, replace limit.



KING ELECTRICAL MFG. CO.

9131 10TH AVENUE SOUTH · SEATTLE, WA 98108

TEL: 206.762.0400 · FAX: 206.763.7738 · www.king-electric.com